

PREBENA®

PRODUCT CATALOGUE

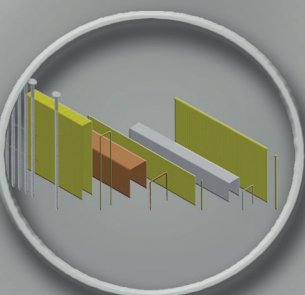

PKT **HYBRID**
CORDLESS TECHNOLOGY



COMPETENCE IN THE FASTENING BUSINESS



Full service from production to processing
for trade, craft and industry

Certified DIN EN ISO 9001:2015

TÜV certified production facilities

Proofed safety sign (GS sign)

CE – Declaration for all pneumatic tools

Fasteners according the requirements
as per Eurocode 5 - EN14592/A1
and ETA-16/0101

CE – Declaration for fasteners
as per DIN EN 13964:2007-02

Member of fasteners associations

PKT HYBRID



OPTIWEAR- TECHNOLOGY





PREBENA is one of the leaders in the fastening industry, headquartered in 63679 Schotten, Germany.

Progress through Technology – Since founding of PREBENA in 1960 in Schotten (Germany) all technical innovations take place in the main production site there. Both the pneumatic tools as well as the manufacturing machines for the production of staples, collated nails and screws are being developed by PREBENA itself.

Quality warranty – Through experience of almost 60 years, the company's highest quality and efficiency of products and excellent service are guaranteed. To ensure this high level, PREBENA attaches importance to strong and long-term relationships with its partners worldwide.

ISO quality management and production of PREBENA fasteners according to ETA-16/0101 and Eurocode 5 is precondition in all companies and our standard.

Extensive product range - With a large product diversity PREBENA is capable of serving widely varied specialist trade sectors and branches of the economy, from major industries through professional craft enterprises to hobby do-it-yourselfers. The product range of PREBENA is perfectly matched. It includes:

- Pneumatic nailing guns
- Pneumatic air cylinder nailing guns
- Staplers
- Compressors
- More than 3500 different collated fasteners from 3-160 mm length:
Staples, brads, pins, nails, screws

PREBENA international - Our technology is recognized as one of the leaders worldwide.

Our products are sold in over 60 countries. Also the manufacturing machines for the production of fasteners meanwhile operate in factories all over the world. Through the company's expansion production plants have been created worldwide. Service and selling of PREBENA products is guaranteed by more than 30 distribution companies worldwide.

More details can be found at www.prebena.com

EUROPEAN TECHNICAL ASSESSMENT - ETA STAPLES RECOGNIZED THROUGHOUT EUROPE – RESPECTED WORLDWIDE!



The European Technical Approval – ETA – replaces the national technical approval for staples as a certified construction product!

It qualifies a CE marking and offers reliable proof of special performance characteristics for permanent use in construction, prefabricated house and timber frame construction.

Staple-certification for wire Ø 1,52 – 2,0 mm up to a length of 170 mm in versions:

RF = stainless steel, Material-No. 1.4301

SV = strong galvanized, 12 µm galvanizing

- **High certification requirements**
- **Higher pull-out values compared to the previous German approvals**
- comparable with ring nails
- **Higher wire strength**
- **100% standard-compliant fastening**
- **Guaranteed service life of the staples at least 50 years**
- **Unlimited validity of the authorisation**



According to Eurocode 5, staples must not be subjected to long-term or permanent pull-out forces - e.g. in the case of suspended ceilings or ceiling parts - in structural timber construction. Staples with ETA approval are absolutely necessary for this.

PREBENA ETA staples are

- permitted for permanent pull-out forces
- approved for wood fibre insulating materials with fixed pull-through values

„Made in Germany“ – As an innovative manufacturer, PREBENA produces the new ETA staples on specially developed production plant in order to guarantee the high certification requirements.

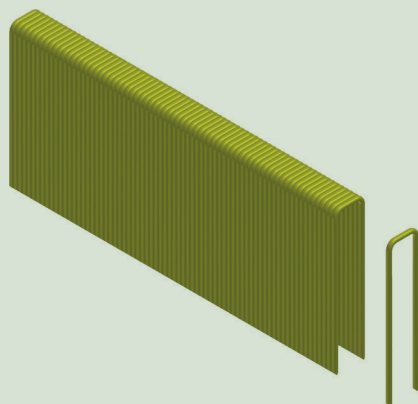

Main program PREBENA staples with

European Technical Approval for staples as a means of joining wood:

Staples in versions CSVHA (strong galvanized) and CRFHA (stainless steel - No. 1.4310)

- type L
- type Q
- type WP
- type Z

FASTENERS ACCORDING TO

Eurocode 5 - EN14592/A1, EN 14566:2008+A1

AND CERTIFICATED AT DIN EN 13964:2007-02



In Eurocode 5, nails are sized according to the product standard DIN EN 14592. This standard gives the material properties and required test methods, which are necessary to the connecting means with the Requirements of Eurocode 5.

This award can be recognized in the form of the CE mark. The standard also creates a series Verification and test procedures to follow the receipt of the CE mark.

Our fasteners conform to those required by Eurocode 5. The values required for the structural design according to EN 1995-1-1 can be found in the CE data sheet under www.prebena.de.

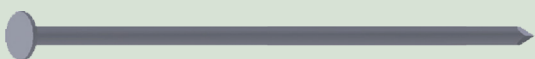

PREBENA Smooth Shank Nails

of types CNF, CNH, CNW, PR RK and RKP according to the requirements of Eurocode 5. The nails in accordance with the EN 14592 are length depended coated.



PREBENA Ring Shank Nails

of types CNF, CNH, CNW, PR, RK and RKP are special nails according to the requirements of Eurocode 5 and in accordance with the EN 14592 EN 14592-2012-8.



PREBENA Anchornails

are special nails according to the requirements of Eurocode 5 and in accordance with the EN 14592 EN 14592-2012-8. They can be used for the fastening of wood connectors approved by building authorities. Anchornails produced out of material no. 1.4301 on request.

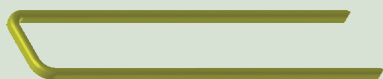

PREBENA Staples - CRFHA and CSVHA

type H (30-40 mm) and L (38-50 mm) in strong galvanized and stainless steel (material code 1.4301) comply with EN 14566:2008+A1.



PREBENA Drywall Screws type MGS

according to the requirements of EN 14566:2008+A1. The drywall screws are suitable for fastening of plaster- and fiberboards.

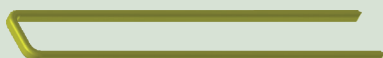

PREBENA Staples

type E, ES and H in galvanized quality accord to the requirements of DIN EN 13964:2007-02 (statistic test load capacity of suspended ceiling components).

ORDERING DESIGNATION

Pneumatic Stapler 3 GP-Z 40

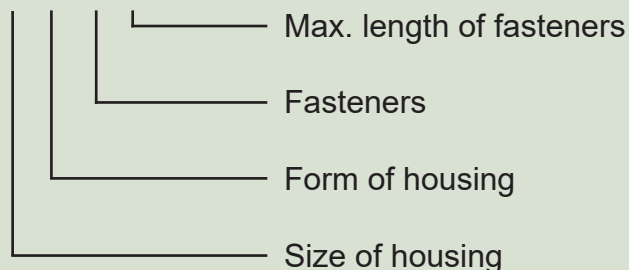

Fasteners ES 32 C NK HA

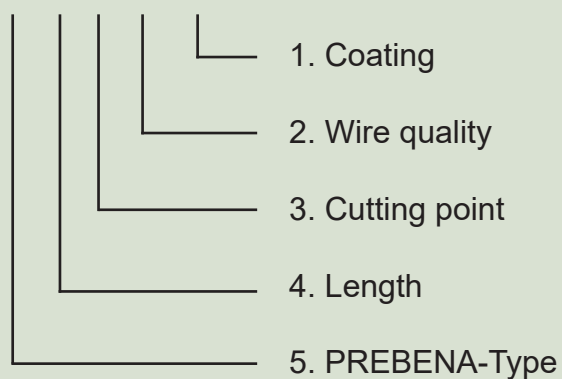

1. Resign coating HA = PREBENA GOLD LOC coated

2. Quality of wire

AL	= aluminium
BK	= blank
BZ	= bronze
LF	= liquor finished
LS	= liquor finished steel
MS	= brass
NK	= galvanized
RA	= stainless steel (Werkstoff-Nr. 1.4539)
RF	= stainless steel (Werkstoff-Nr. 1.4301)
RFRILI	= stainless steel, ring, fillister head
SV	= strong galvanized steel
ST	= galvanized steel with high tensile strength
VK	= copper
VS	= coppered steel
VZ	= hot dipped galvanized

Unlisted fastener discription on request.

Staple cuts

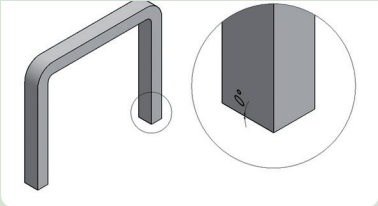

B-CUT
stub cut

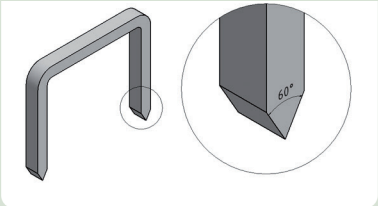

CC-CUT
chisel cut

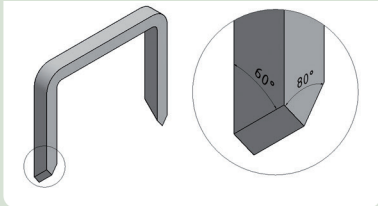

CD-CUT
chisel saw cut

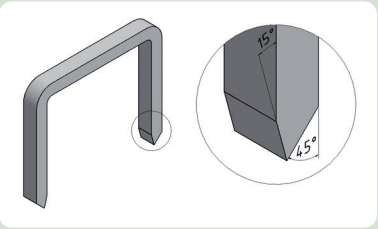

CI-CUT
chisel cut (inside cut)

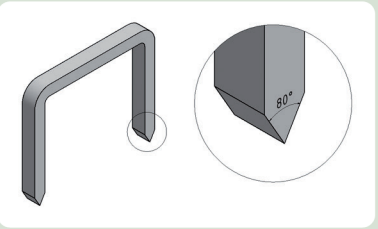

C-CUT
chisel cut (standard)

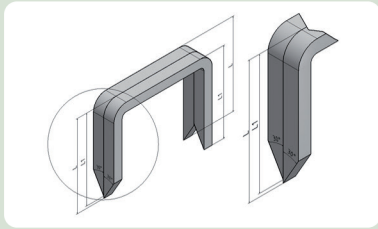

DDR-CUT
saw cut (barb to barb)

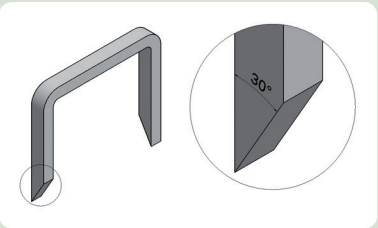

DL-CUT
saw cut (barb left)

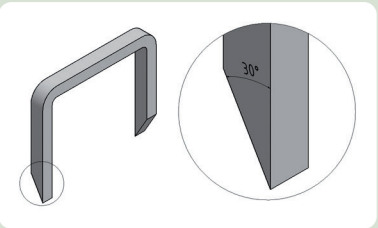

DR-CUT
saw cut (barb right)

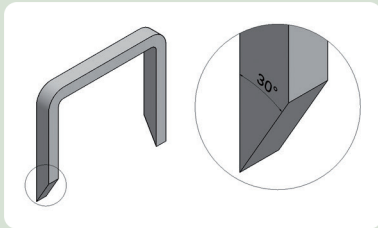

D-CUT
saw cut general (barb right or left)

Nails

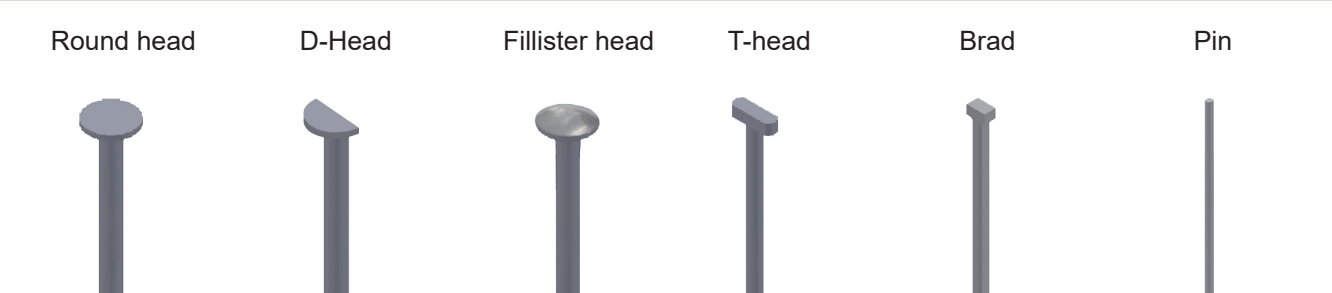
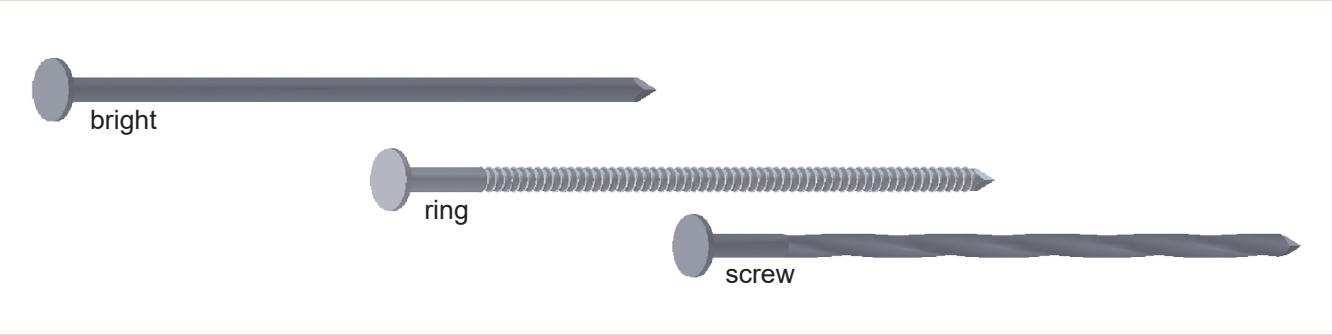



PKT-HYBRID - CORDLESS AIR TECHNOLOGY

Application

	PKT-8-RKP100	PKT-8-RKP100-LM	PKT-8-PR100	PKT-8-PR100-LM
				

Upholsterer / Interior designer

Upholstery				
Dekoration				
Covering				
Tissue				
Leather, fell				
Foil, cardboard, paper				

Interior work / Drywall installation

Skirting, cover strip				
Decorative molding				
Panel ceiling				
Profile board				
Window / door				
Glazing bead				
Ceiling lining / wall covering				
Parquet				
Substructure	X	X	X	X
Chipboard, OSB	X	X	X	X
Gypsum fibre board				
Gypsum plaster board				
Exhibition stand construction	X	X	X	X
Acoustics				

Carpenter / Roofer

Roof lath	X	X	X	X
Roof boarding	X	X	X	X
Outside boarding	X	X	X	X
Bottom-cover-boarding	X	X	X	X
Visual boarding	X	X	X	X
Weather boarding	X	X	X	X
Saving foamwork	X	X	X	X
Caping and verge boarding	X	X	X	X
Flue boarding	X	X	X	X
Roof framework	X	X	X	X
Substructure	X	X	X	X
Framework	X	X	X	X
Wooden truss				
Timber frame system	X	X	X	X
Dormer	X	X	X	X
Wood connector				
Roof cladding				
Valley board				
Inflow sheet				
Roofing felt / bitumen				
Insulation				

Packaging

Wooden box	X	X	X	X
Pallet	X	X	X	X
Palett repair	X	X	X	X
Cardboard box				
Cardboard closing				
Cardboard stapling				

Others

Wooden fence	X	X	X	X
Wire fence				
Small furniture				
Furniture back board				
Case plinth				
Terrace building	X	X	X	X
Garden house	X	X	X	X
Carport	X	X	X	X
Rack / bridge	X	X	X	X
Flowering profile / ornaments				
Picture frame				

PKT-HYBRID

CORDLESS TECHNOLOGY

PREBENA PKT technology in combination with an 18 V LiHD high-performance battery

- Independent of gas cylinder, power cord and hose for maximum flexibility of operation
- Ergonomically designed for strong performance and high comfort in every use
- Powerful for all nail lengths - also in ring version
- Repair- and service-friendly
- Optimal weight balance and shooting performance
- Environmentally conscious - no gas, no CO2 emissions
- For indoor and outdoor use
- Weather and temperature independent



Cordless Alliance System (CAS) One battery for everything Cross-manufacturer battery system



100% compatible for over 160 machines from 17 different manufacturers of the 18 V class

- Complete compatibility - everything fits: machines, batteries and chargers of all brands
- Double flexibility - work cordlessly and use machines from different manufacturers
- Cost advantages through multiple use of available batteries

HYBRID NAILER PKT-8-RKP100

Round-Head Stripnails type RKP from 65 - 100 mm • paper collated with short magazine for 1 nail strip

- HYBRID NAILER PKT-8-RKP100 - without battery
- 1 compressed air cylinder KT-1000 - only for filling!

Gauge for air level, pressure relief, fast shot sequence = 1.5 shots/second, weight: only 4.4 kg without battery, low construction height = only 38 cm, operation via touch display, toolless removal of the magazine, lock-out safety device, safety device, belt clip, depth adjustment, quick loading system

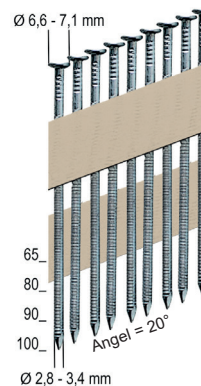

HYBRID NAILER PKT-8-RKP100LM

Round-Head Stripnails type RKP from 65 - 100 mm • paper collated with long magazine for 2 nail strip

- HYBRID NAILER PKT-8-RKP100LM - without battery
- 1 compressed air cylinder KT-1000 - only for filling!

Gauge for air level, pressure relief, fast shot sequence = 1.5 shots/second, weight: only 4.4 kg without battery, low construction height = only 38 cm, operation via touch display, toolless removal of the magazine, lock-out safety device, safety device, belt clip, depth adjustment, quick loading system

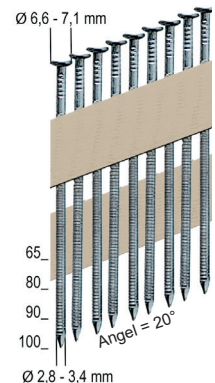

HYBRID NAILER PKT-8-RKP100-SET

PKT-8-RKP100-SET:

- HYBRID NAILER PKT-8-RKP100
- 1 compressed air cylinder KT-1000 - only for filling!
- AKKU 18-5,5-LiHD
- AKKU-STATION 12-36

PKT-8-RKP100-SET4:

- HYBRID NAILER PKT-8-RKP100
- 1 compressed air cylinder KT-1000 - only for filling!
- AKKU 18-4,0-LiHD
- AKKU-STATION 12-36



HYBRID NAILER PKT-8-RKP100LM-SET

PKT-8-RKP100LM-SET:

- HYBRID NAILER PKT-8-RKP100LM
- 1 compressed air cylinder KT-1000 - only for filling!
- AKKU 18-5,5-LiHD
- AKKU-STATION 12-36

PKT-8-RKP100LM-SET4:

- HYBRID NAILER PKT-8-RKP100LM
- 1 compressed air cylinder KT-1000 - only for filling!
- AKKU 18-4,0-LiHD
- AKKU-STATION 12-36





PKT-HYBRID - CORDLESS AIR TECHNOLOGY

HYBRID NAILER PKT-8-PR100

D-Head Stripnails type PR from 65 - 100 mm • paper collated with short magazine for 1 nail strip

- HYBRID NAILER PKT-8-RKP100 - without battery
- 1 compressed air cylinder KT-1000 - only for filling! in plastic transport case

Gauge for air level, pressure relief, fast shot sequence = 1.5 shots/second, weight: only 4.4 kg without battery, low construction height = only 38 cm, operation via touch display, toolless removal of the magazine, lock-out safety device, safety device, belt clip, depth adjustment, quick loading system

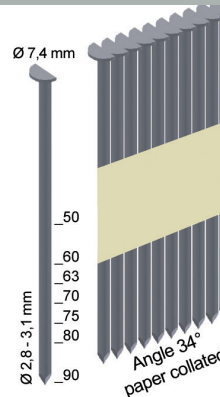

HYBRID NAILER PKT-8-RP100LM

D-Head Stripnails type PR from 65 • 100 mm - paper collated with long magazine for 2 nail strip

- HYBRID NAILER PKT-8-RKP100LM - without battery
- 1 compressed air cylinder KT-1000 - only for filling! in plastic transport case

Gauge for air level, pressure relief, fast shot sequence = 1.5 shots/second, weight: only 4.4 kg without battery, low construction height = only 38 cm, operation via touch display, toolless removal of the magazine, lock-out safety device, safety device, belt clip, depth adjustment, quick loading system

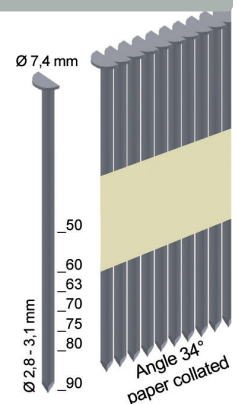

HYBRID NAILER PKT-8-PR100-SET

PKT-8-PR100-SET:

- HYBRID NAILER PKT-8-RKP100
 - 1 compressed air cylinder KT-1000 - only for filling!
 - AKKU 18-5,5-LiHD
 - AKKU-STATION 12-36
- in plastic transport case

PKT-8-PR100-SET4:

- HYBRID NAILER PKT-8-RKP100
 - 1 compressed air cylinder KT-1000 - only for filling!
 - AKKU 18-4,0-LiHD
 - AKKU-STATION 12-36
- in plastic transport case



HYBRID NAILER PKT-8-PR100LM-SET

PKT-8-PR100-SET:

- HYBRID NAILER PKT-8-RKP100LM
 - 1 compressed air cylinder KT-1000 - only for filling!
 - AKKU 18-5,5-LiHD
 - AKKU-STATION 12-36
- in plastic transport case

PKT-8-PR100-SET4:

- HYBRID NAILER PKT-8-RKP100LM
 - 1 compressed air cylinder KT-1000 - only for filling!
 - AKKU 18-4,0-LiHD
 - AKKU-STATION 12-36
- in plastic transport case



AKKU18-4,0-LIHD / AKKU18-5,5-LIHD

- LiHD for ultimate performance and long service life with minimum temperature development
- Durable battery packs with 3 years warranty
- Capacity indicator for permanent control of the filling level

AKKU18-4,0LiHD = 590 g
AKKU18-5,5LiHD = 990 g



AKKU-STATION 12-36



- For charging LiHD sliding seat batteries
- Cooling during charging for significantly reduced charging times
- Very low stand-by power consumption

Mains voltage: 230 - 240 V
Mains frequency: 50 - 60 Hz
Max. charging voltage: 3/4 A



AKKU-SET 4,0 LIHD / AKKU-SET 5,5 LIHD

AKKU-SET 4,0 LIHD:

- 2 x AKKU18-4,0-LIHD
- 1 x AKKU-STATION 12-36

AKKU-SET 5,5 LIHD:

- 2 x AKKU18-5,5-LIHD
- 1 x AKKU-STATION 12-36



VITAS 100-AKKU



Light and powerful battery-compressor for mobile use - with brushless motor

Technical details:

Battery voltage: 18 V
No of revolutions: 2760 RPM
Inlet power: 100 l/min.
Effective outlet: 72 l/min.
max. pressure: 8 bar
Tank: 5 l
Weight: 9,9 kg
LxWxH: 340 x 315 x 380 mm

- Gauge for tank pressure
- Gauge for pressure exit
- Pressure reducer with gauge
- Regulated compressed air connection
- Vulcanised rubber feet
- Rubber grip handle
- Running time with one AKKU18-5.5-LIHD: approx. 60 minutes

Oil-free

- no oil-change
- no oil in condensed water

Second battery directly at the compressor can be deposited to continue working without interruption.



Cordless Air Nailer PKT-2-J50SD-S

Brads type J from 16 - 50 mm

Optional using with standard compressor or compressed air cylinder.

Technical specification:

Weight: 2,1 kg

Operating pressure: approx. 3,5 - 10 bar

LxWxH: 319 x 71 x 272 mm

In plastic case with a refillable compressed air cylinder KT-1000 and an adapter for use with a standard compressor.

Easy trip system, adjustable depth control, safety device, easy drive, lock-out safety device, manometer for working pressure, single- or bumpfire, adjustable exhaust, gauge for air level.

Applications:

Decorative molding, glazing bead, baseboard, hardwood trim, joinery and furniture manufacturing and more

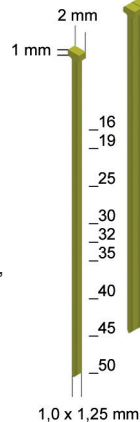

Cordless Air Nailer PKT-2-J50SD-SVN for secret fixing of glazing beads

Brads type J from 16 - 50 mm

Optional using with standard compressor or compressed air cylinder.

Technical specification:

Weight: 2,05 kg

Operating pressure: approx. 3,5 - 10 bar

LxWxH: 350 x 71 x 275 mm

In plastic case with a refillable compressed air cylinder KT-1000 and an adapter for use with a standard compressor.

High shot capacity and shot speed, depth adjustment, handle grip, single fire with safety device, adjustable working pressure, gauge for working pressure, gauge for air level, side load magazine,

Applications:

Window construction and window repair.
Specialized tool for invisible fixing of glazing bead.
Suitable for dry and silicone glazing.

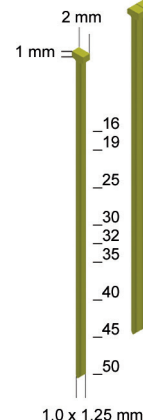

Cordless Air Stapler PKT-2-ES40-S

Staples type ES from 15 - 40 mm

Technical specification:

Weight: 2,4 kg

LxWxH: 326 x 60 x 257 mm

In plastic case with a refillable compressed air cylinder KT-1000.

Fast fire sequence, gauge for air level, adjustable depth control, bottom load magazine, safety device, adjustable impact power, long nose

Applications:

Panelling, cabinet, furniture manufacturing, sheet material, decorative molding, flooring and more

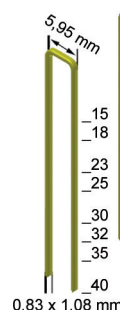



PKT - CORDLESS AIR TECHNOLOGY

PKT-ADAPTER 300

**Connecting of pneumatic devices up to 10 bar
at PREBENA compressed air cylinder KT-1000.**

Unlimited possibilities of applications for all pneumatic tools

Technical details:

Weight: 750 g

Operating pressure: 6 - 7 bar

Easy connecting of pneumatic devices at PREBENA compressed air cylinder KT-1000, applicable without compressed air hose, ready for connection, gauge for air level of compressed air cylinder, small and handy, totally unaffected by temperature or weather, coupling for easy connect

Easy handling and quickly mounted

- Screw the compressed air cartridge into the adapter
- Connect the adapter to the compressed air device
- Ready for action



Compressed Air Cylinder KT-1000-SY

Five refillable compressed air cylinder KT-1000 in a systainer

Volume of compressed air cylinder: 0,36 l

Weight: approx. 1,0 kg

For Cordless Air Nailer and Stapler:

PKT-2-J50SD-S

PKT-2-J50SVN

PKT-2-N65-S

PKT-2-ES40-S

and PKT-ADAPTER 300



Refillable Compressed Air Cylinder KT-1000

New, refillable compressed air cylinder KT-1000

Volume of compressed air cylinder: 0,36 l

Weight: approx. 1,0 kg

Own refilling with fill station PKT-TWINTec 400 or easy replacement at your PREBENA dealer.



PNEUMATIC MOBILO

The most mobile type "Compressor"

Mobile system for all pneumatic devices up to 10 bar

Unlimited possibilities of applications!

Connect the pneumatic devices and action!

Totally unaffected by temperature or weather!

Weight: approx. 3 kg

Volume of compressed air cylinder KT-3500: 1,5 l

Standard equipment:

Refillable compressed air cylinder KT-3500, HD-Controller up to 10 bar, spiral coiled tube, belt with click-system, in a metal case

Available as PNEUMATIC MOBILO HD to double as a higher pressure version with HD-Controller up to 23 bar



Compressed Air Cylinder KT-3500-S

Two refillable compressed air cylinder KT-3500 in a metal case

Volume of compressed air cylinder: 1,5 l

Weight: approx. 1,7 kg

For PNEUMATIC MOBILO, PNEUMATIC MOBILO HD and Cordless Air Nailer PKT-7-RK90



PNEUMATIC MOBILO 470

PNEUMATIC MOBILO with compressed air cylinder KT-470

Volume of compressed air cylinder KT-300: 3,0 l

Weight with metal case: approx. 8,4 kg

Standard equipment:

Refillable compressed air cylinder KT-300 and HD-Controller up to 10 bar in a metal-case with compressed air connection



KT-470-S = Refillable compressed air cylinder KT-470 in metal case **without** HD-Controller

Shoulder strap for PNEUMATIC MOBILO KT-TS1

- Adjustable, padded shoulder belt
- Easy handling
- Comfortable working

For PNEUMATIC MOBILO 470





PKT - CORDLESS AIR TECHNOLOGY

Fill station and standard compressor PKT-TWINTec 400

Fill station for refilling of all PREBENA compressed air cylinders and compressor for all pneumatic devices up to 10 bar

Technical specification:

Motor: 230 V/2200 W

No. of revolutions: 2.760 RPM

Max. operating pressure: 330 bar

Max. working pressure: 10 bar

Effective output: 100 l. /min.

Weight: 67 kg

LxWxH: 835 x 595 x 625 mm

Standard accoutrement:

Fast refilling of PREBENA compressed air cylinders, compressed air cylinder = compressor tank, automatic condensate drain, automatic switch-off, automatic restart, solid tubular frame, operation-hour counter, type-examination tested safety relief valve, fully automatic filling valve for filling of 1 or 2 cylinders, folding bow-shaped handle, solid rubber wheels, pressure reducer, regulated compressed air outlet, manometer for filling- and outlet pressure, motor protection switch, no TÜV (Technical approval) certification required

Suitable for all PREBENA compressed air cylinders:

KT-1000, KT-3500, KT-300, KT-470, KT-690 and KT-900



2 applications simultaneously



Easy for transport



Fully automatic fsystem

Belt system for PNEUMATIC MOBILO



Leather belt

ET98255001

Click-System

ET43950001

for PNEUMATIC MOBILO and PNEUMATIC MOBILO HD



Accessories for PNEUMATIC MOBILO

ET0021830 - Adapter

for refilling of compressed air cylinder KT-1000 with fill station PKT-TWINTec 400

ET00205902 - Adapter

for connecting of compressed air cylinder KT-1000 to PNEUMATIC MOBILO

Z400.10 - Filling hose

for refilling of compressed air cylinder with Fill station PKT-TWINTec 400

Z400.20 - High pressure hose

Length: 1,5 m - for connecting of pneumatic devices to PNEUMATIC MOBILO HD



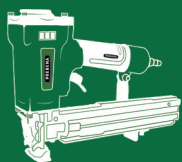

PNEUMATIC STAPLER

PREBENA®

www.prebena.com

Application

	1GP-A16	1GP-A25	1GP-A16LN50	1GP-A16NH	1GP-D16	1GP-TK16	1GP-V16	1GP-XA16	1M-O25DSD	1X-A16AUT	1X-A16LM-AUT	2P-ES40SDS	2P-H30SD	2P-JES40COMBI	3GP-E40	3GP-H40	3GP-L40	3GP-Z40	4C-L50	4C-WS38	4C-Z50	5C-Q67	5C-Z75	9X-WP130	9X-WP160
Upholsterer / Interior designer																									
Upholstery	X	X	X		X	X	X	X	X	X	X	X	X												
Dekoration	X	X	X	X	X	X	X	X	X			X	X												
Covering	X	X	X		X	X	X	X	X			X	X												
Tissue	X	X	X		X	X	X	X	X			X	X												
Leather, fell	X	X	X	X	X	X	X	X		X	X														
Foil, cardboard, paper	X	X	X	X	X	X	X	X		X	X														
Interior work / Drywall installation																									
Skirting, cover strip														X											
Decorative molding														X											
Panel ceiling									X			X	X	X	X	X									
Profile board									X			X	X	X	X	X									
Window / door								X																	
Glazing bead																									
Ceiling lining / wall covering								X	X			X	X	X	X	X									
Parquet														X											
Substructure														X	X	X	X	X	X		X	X	X		
Chipboard, OSB														X	X	X	X	X	X		X	X	X		
Gypsum fibre board												X	X	X	X	X	X	X	X		X	X	X		
Gypsum plaster board												X	X	X	X	X	X	X	X		X	X	X		
Exhibition stand construction	X	X	X	X	X	X	X	X	X			X	X	X	X	X	X	X	X		X	X	X		
Acoustics	X	X	X		X	X	X	X	X			X	X		X	X									
Carpenter / Roofer																									
Roof lath																									
Roof boarding																									
Outside boarding															X	X	X	X	X		X	X	X		
Bottom-cover-boarding															X	X	X	X	X		X	X	X		
Visual boarding															X	X	X	X	X		X	X	X		
Weather boarding															X	X	X	X	X		X	X	X		
Saving foamwork															X	X	X	X	X		X	X	X		
Caping and verge boarding															X	X	X	X	X		X	X	X		
Flue boarding																	X	X	X		X	X	X		
Roof framework																									
Substructure																	X	X	X		X	X	X		
Framework															X	X	X	X	X		X	X	X		
Wooden truss																									
Timber frame system															X	X	X	X	X		X	X	X		
Dormer															X	X	X	X	X		X	X	X		
Wood connector																									
Roof cladding																									
Valley board																									
Inflow sheet																									
Roofing felt / bitumen																				X					
Insulation																								X	X
Packaging																									
Wooden box												X	X		X	X	X	X	X	X	X	X			
Pallet												X	X		X	X	X	X	X	X	X	X			
Palett repair												X	X		X	X	X	X	X	X	X	X			
Cardboard box																				X					
Cardboard closing																									
Cardboard stapling																									
Others																									
Wooden fence												X	X	X	X	X	X	X	X		X	X	X		
Wire fence	X	X	X		X	X	X		X			X	X	X	X	X	X	X	X		X	X	X		
Small furniture	X	X	X	X	X	X	X		X			X	X	X	X	X	X	X	X		X	X	X		
Furniture back board	X	X	X	X	X	X	X		X			X	X	X	X	X	X	X	X		X	X	X		
Case plinth																									
Terrace building												X	X	X	X	X	X	X	X		X	X	X		
Garden house												X	X	X	X	X	X	X	X		X	X	X		
Carport												X	X	X	X	X	X	X	X		X	X	X		
Rack / bridge												X	X	X	X	X	X	X	X		X	X	X		
Flowering profile / ornaments														X											
Picture frame																									

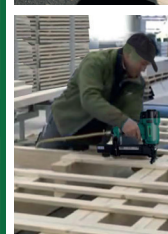
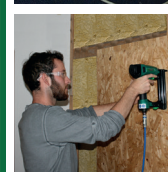
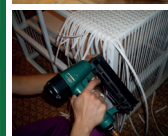

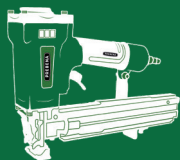

PNEUMATIC STAPLER

Pneumatic Stapler 1GP-A16

Staples type A from 4 - 16 mm

Technical specification:

Weight: 0,86 kg

Operating pressure: approx. 4 - 6 bar

Air requirement: approx. 0,27 l / staple

LxWxH: 220 x 50 x 155 mm

Optimized wearing parts, long service life, easy maintenance, smooth-running trigger system, low noise and vibration level, fast fire sequence, low air consumption, practical magazine lock, free field of view, exhaust air on the rear side

Applications:

Upholstery, decoration, molding, picture frame, insulation, roofing felt, building paper, carpet and underlay and more

**OPTIWEAR-
TECHNOLOGY**

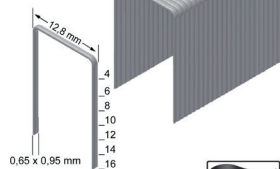

Available as 1GP-A16SDS
with safety device



Pneumatic Stapler 1GP-A25

Staples type A from 8 - 25 mm

Technical specification:

Weight: 0,98 kg

Operating pressure: approx. 4 - 6 bar

Air requirement: approx. 0,39 l / staple

LxWxH: 225 x 50 x 175 mm

Optimized wearing parts, long service life, easy maintenance, smooth-running trigger system, low noise and vibration level, fast fire sequence, low air consumption, practical magazine lock, free field of view, exhaust air on the rear side

Applications:

Furniture back, upholstery, decoration, molding, picture frame, insulation, roofing felt, building paper, carpet and underlay and more

**OPTIWEAR-
TECHNOLOGY**

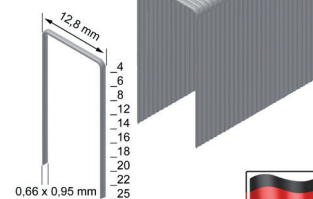

Pneumatic Stapler 1GP-A16LN50 with 50 mm long nose

Staples type A from 4 - 16 mm

Technical specification:

Weight: 0,94 kg

Operating pressure: approx. 4 - 6 bar

Air requirement: approx. 0,27 l / staple

LxWxH: 220 x 50 x 215 mm

50 mm long nose, bottom load magazine, exhaust silencer, no recoil, adjustable exhaust

Applications:

For upholstery work. Anywhere stapling is required in deep ridges, grooves, corners and more

**OPTIWEAR-
TECHNOLOGY**

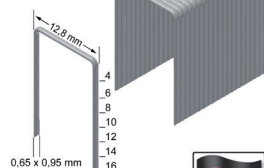

Pneumatic Stapler 1GP-A16NH with adjustable matrix

Staples type A from 4 - 16 mm

Technical specification:

Weight: 1,1 kg

Operating pressure: approx. 4 - 6 bar

Air requirement: approx. 0,27 l / staple

LxWxH: 220 x 50 x 180 mm

Adjustable matrix, bottom load magazine, exhaust silencer, no recoil, adjustable exhaust, extended throat depth of 140 mm

Applications:

Special stapler with adjustable matrix for paper, cardboard, veneer, plastic, upholstery and other materials

**OPTIWEAR-
TECHNOLOGY**

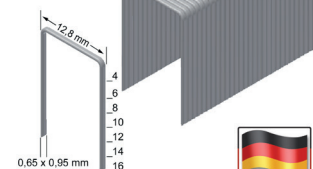

Pneumatic Stapler 1GP-D16

Staples type D from 4 - 16 mm

Technical specification:

Weight: 0,86 kg

Operating pressure: approx. 4 - 6 bar

Air requirement: approx. 0,27 l / staple

LxWxH: 220 x 50 x 155 mm

Optimized wearing parts, long service life, easy maintenance, smooth-running trigger system, low noise and vibration level, fast fire sequence, low air consumption, practical magazine lock, free field of view, exhaust air on the rear side

Applications:

Especially used for screening, light trim and molding, picture frame, insulation, roofing felt, upholstery, building paper, carpet and underlay and more

**OPTIWEAR-
TECHNOLOGY**

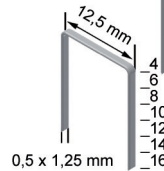

Pneumatic Stapler 1GP-TK16

Staples type TK from 6 - 16 mm

Technical specification:

Weight: 0,86 kg

Operating pressure: approx. 4 - 6 bar

Air requirement: approx. 0,27 l / staple

LxWxH: 220 x 50 x 155 mm

Optimized wearing parts, long service life, easy maintenance, smooth-running trigger system, low noise and vibration level, fast fire sequence, low air consumption, practical magazine lock, free field of view, exhaust air on the rear side

Applications:

Shoe industry, upholstery, decorating, textile, leather, etc.

**OPTIWEAR-
TECHNOLOGY**

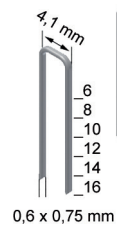

Pneumatic Stapler 1GP-V16

Staples type V from 6 - 16 mm

Technical specification:

Weight: 0,86 kg

Operating pressure: approx. 4 - 6 bar

Air requirement: approx. 0,27 l / staple

LxWxH: 220 x 50 x 155 mm

Optimized wearing parts, long service life, easy maintenance, smooth-running trigger system, low noise and vibration level, fast fire sequence, low air consumption, practical magazine lock, free field of view, exhaust air on the rear side

Applications:

Moulding, picture frame, cabinet backing, weather stripping, insulation, roofing felt, upholstery, building paper, carpet and underlay, etc.

**OPTIWEAR-
TECHNOLOGY**

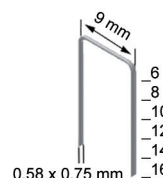

Pneumatic Stapler 1GP-XA16

Plastic-Staples type XA from 6 - 16 mm

Technical specification:

Weight: 0,86 kg

Operating pressure: approx. 4 - 6 bar

Air requirement: approx. 0,27 l / staple

LxWxH: 220 x 50 x 155 mm

Optimized wearing parts, long service life, easy maintenance, smooth-running trigger system, low noise and vibration level, fast fire sequence, low air consumption, practical magazine lock, free field of view, exhaust air on the rear side

Applications:

Label (Wood), veneer bulkhead in boatbuilding, padding of coffin (cremation), glass-fiber-plastic, inscription in sawmills, frame, wood-pellet, label on packaging in an aggressive environment (oversea packaging), radiation protection mat, etc.

**OPTIWEAR-
TECHNOLOGY**

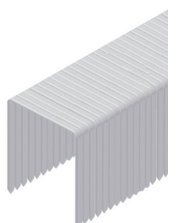
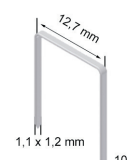

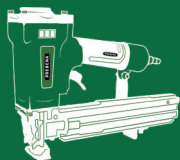

PNEUMATIC STAPLER

Pneumatic Stapler 1M-O25SDS

Staples type O from 8 - 25 mm

Technical specification:

Weight: 1 kg

Operating pressure: approx. 4 - 6 bar

Air requirement: approx. 0,25 l / staple

LxWxH: 209 x 42 x 160 mm

Safety device, single fire, bottom loading magazine, exhaust silencer, handle grip, adjustable exhaust

Applications:

Panelling, sheet material, cabinet, flooring, decorative molding and more

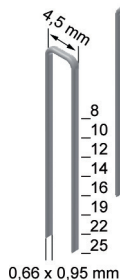

Pneumatic Stapler 1X-A16AUT with automatic fire

Staples type A from 6 - 16 mm

Technical specification:

Weight: 0,96 kg

Operating pressure: approx. 5 - 7 bar

Air requirement: approx. 0,29 l / staple

LxWxH: 215 x 40 x 145 mm

Single and automatic fire, continuous adjustable shot frequency, bottom loading magazine, exhaust silencer, handle grip

Applications:

Industrial use in upholstery, textile, leather, foil, covering and more

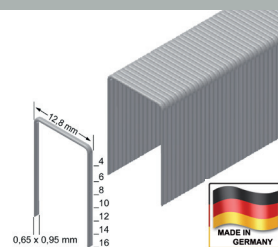

Available as 1X-A16LM-AUT with long magazine.

Pneumatic Stapler 2P-ES40SDS

Staples type ES from 15 - 40 mm

Technical specification:

Weight: 1,3 kg

Operating pressure: approx. 5 - 7 bar

Air requirement: approx. 0,75 l / staple

LxWxH: 225 x 57,5 x 222 mm

Safety device, exhaust silencer, bottom load magazine, no recoil, adjustable exhaust, in a plastic case

Applications:

Panelling, wood moulding, decorative moulding, sheet material, cabinet, flooring, furniture manufacturing and more

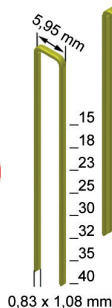

Pneumatic Stapler 2P-H30SD

Staples type H from 12 - 30 mm

Technical specification:

Weight: 1,25 kg

Operating pressure: approx. 5 - 7 bar

Air requirement: approx. 0,75 l / staple

LxWxH: 235 x 57,5 x 222 mm

Safety device, exhaust silencer, bottom load magazine, no recoil, adjustable exhaust, in a plastic case

Applications:

Furniture backs, cabinets, framing, wooden cases etc.

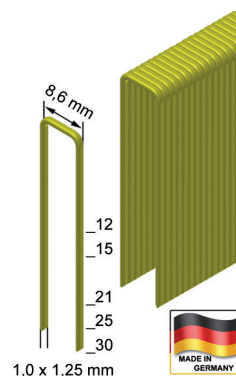

Pneumatic Stapler 3GP-E40

Staples type E from 15 - 40 mm

Technical specification:

Weight: 1,83 kg

Operating pressure: approx. 5 - 8 bar

Air requirement: approx. 1,28 l / staple

LxWxH: 295 x 70 x 265 mm

Optimized wearing parts, long service life, easy maintenance, smooth-running trigger system, low noise and vibration level, belt hook, fast fire sequence, low air consumption, practical magazine lock, bottom loading magazine, exhaust silencer, bump fire, depth control, in a plastic case

Applications:

Plasterboard, panelling, flooring, furniture manufacturing, joinery manufacturing, cabinet, wooden case and more

**OPTIWEAR-
TECHNOLOGY**

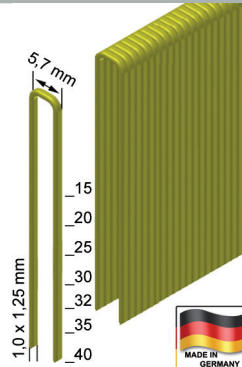

Pneumatic Stapler 3GP-H40

Staples type H from 15 - 40 mm

Technical specification:

Weight: 1,83 kg

Operating pressure: approx. 5 - 8 bar

Air requirement: approx. 1,28 l / staple

LxWxH: 295 x 70 x 265 mm

Optimized wearing parts, long service life, easy maintenance, smooth-running trigger system, low noise and vibration level, belt hook, fast fire sequence, low air consumption, practical magazine lock, bottom loading magazine, exhaust silencer, bump fire, depth control, in a plastic case

Applications:

Prefabricated construction, wooden truss, packing, plasterboard, framework, furniture manufacturing and more

**OPTIWEAR-
TECHNOLOGY**

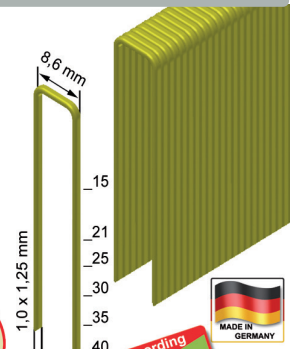

Tested according to
EN 14586:2005+A1



Pneumatic Stapler 3GP-L40

Staples type L from 15 - 40 mm

Technical specification:

Weight: 1,83 kg

Operating pressure: approx. 5 - 8 bar

Air requirement: approx. 1,28 l / staple

LxWxH: 295 x 70 x 265 mm

Optimized wearing parts, long service life, easy maintenance, smooth-running trigger system, low noise and vibration level, belt hook, fast fire sequence, low air consumption, practical magazine lock, bottom loading magazine, exhaust silencer, bump fire, depth control, in a plastic case

Applications:

Fibreboard, gypsum fibreboard, oriented structural board, drywall, cedar and shake shingle, wooden case, packaging and more

**OPTIWEAR-
TECHNOLOGY**

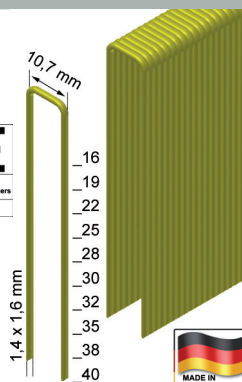

Pneumatic Stapler 3GP-Z40

Staples type Z from 15 - 40 mm

Technical specification:

Weight: 1,83 kg

Operating pressure: approx. 5 - 8 bar

Air requirement: approx. 1,28 l / staple

LxWxH: 295 x 70 x 265 mm

Optimized wearing parts, long service life, easy maintenance, smooth-running trigger system, low noise and vibration level, belt hook, fast fire sequence, low air consumption, practical magazine lock, bottom loading magazine, exhaust silencer, bump fire, depth control, in a plastic case

Applications:

Fibreboard, gypsum fibreboard, oriented structural board, drywall, cedar and shake shingle, wooden case, packaging and more

**OPTIWEAR-
TECHNOLOGY**

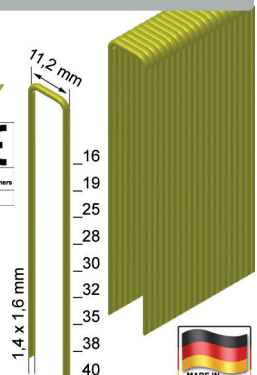

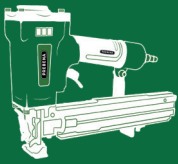

PNEUMATIC STAPLER

Pneumatic Stapler 4C-L50

Staples type L from 19 - 50 mm

Technical specification:

Weight: 2,2 kg

Operating pressure: approx. 5 - 8 bar

Air requirement: approx. 1,72 l / staple

LxWxH: 360 x 85 x 283 mm

Multifunction impact with depth control, easy clear catch, single and bump fire, safety device, adjustable exhaust, in a plastic case

Applications:

Fermacell, plasterboard, wooden cases, corrugated cardboard, cedar and shake shingle, chipboard, packaging, substructure, saving formwork, cardboard pallet, prefab construction and more

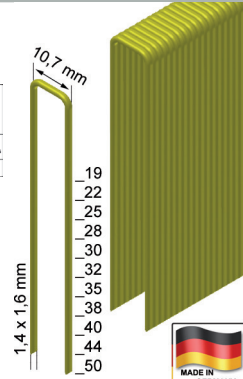

Pneumatic Stapler 4C-WS38

Staples type WS from 16 - 38 mm

Technical specification:

Weight: 2,6 kg

Operating pressure: approx. 5 - 8 bar

Air requirement: approx. 1,36 l / staple

LxWxH: 360 x 85 x 236 mm

Adjustable depth control with removable no-mark tip, easy clear catch, adjustable spacer, safety device, adjustable exhaust, exhaust silencer

Applications:

Cases, packaging, paperboard container, asphalt shingle, lathing roofing felt,



Metal case

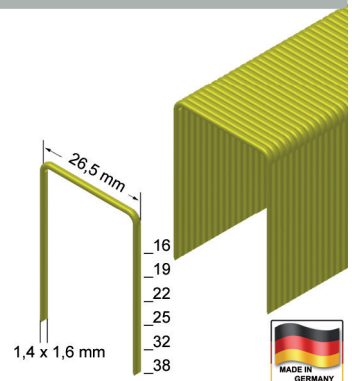

Pneumatic Stapler 4C-Z50

Staples type Z from 16 - 50 mm

Technical specification:

Weight: 2,2 kg

Operating pressure: approx. 5 - 8 bar

Air requirement: approx. 1,7 l / staple

LxWxH: 360 x 85 x 283 mm

Multifunction impact with depth control, easy clear catch, single and bump fire, safety device, adjustable exhaust, in a plastic case

Applications:

Fibreboard, gypsum fibreboard, oriented structural board, drywall, cedar and shake shingle, wooden cases, packaging and more

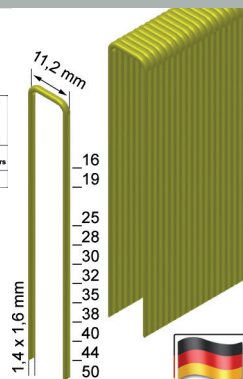

Pneumatic Stapler 5C-Q75

Staples type Q from 35 - 75 mm

Technical specification:

Weight: 2,75 kg

Operating pressure: approx. 5 - 8 bar

Air requirement: approx. 2,38 l / staple

LxWxH: 370 x 98 x 349 mm

Depth adjustment, easy clear catch, safety device, single and bump fire, no recoil, exhaust silencer

Applications:

Prefabricated houses, shuttering, roof decking, door and window unit, framing, subfloor, pallet and more insulation, foam sheathing and more

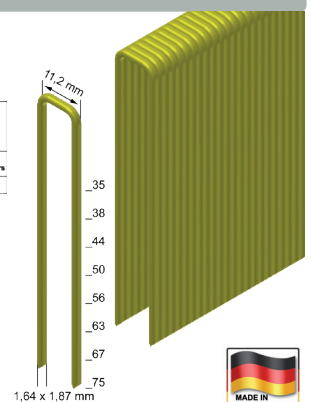

Metal case

Pneumatic Stapler 5C-Z75

Staples type Z from 35 - 75 mm

Technical specification:
Weight: 2,75 kg
Operating pressure: approx. 5 - 8 bar
Air requirement: approx. 2,3 l / staple
LxWxH: 370 x 100 x 350 mm

Depth adjustment, easy clear catch, safety device,
single and bump fire, no recoil, exhaust silencer

Applications:

Gypsum fibre board, drywall, boxing, packaging, chipboard,
substructure, clapboard siding, bitumen shingle, window and door
construction, cardboard pallet, foam sheathing and more

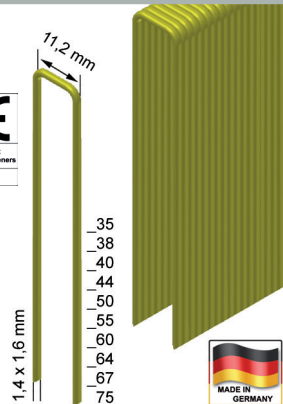

Metal
case

Pneumatic Stapler 9X-WP130

Staples type WP from 75 - 130 mm

Technical specification:
Weight: 5,8 kg
Operating pressure: approx. 5 - 8 bar
Air requirement: approx. 2,9 l / staple
LxWxH: 400 x 132 x 396 mm

Single shot trigger with safety device, depth adjustment,
exhaust silencer, strong magazine, no-mark tip, lock-out safety device

Quick and easy loading of the top load magazine, the short magazine
enables working in inaccessible places like corners or slanting roof

Applications:

Insulation panel from cellulose, wood wool slab, multi-layer plate,
soft fiber insulating, rock wool insulation panel and more.

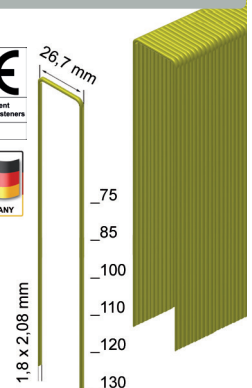

Metal
case

Pneumatic Stapler 9X-WP160

Staples type WP from 75 - 160 mm

Technical specification:
Weight: 6,3 kg
Operating pressure: approx. 5 - 8 bar
Air requirement: approx. 2,9 l / staple
LxWxH: 400 x 138 x 470 mm

Single shot trigger with safety device, depth adjustment,
exhaust silencer, strong magazine, no-mark tip, lock-out safety device

Quick and easy loading of the top load magazine, the short magazine
enables working in inaccessible places like corners or slanting roof

Applications:

Insulation panel from cellulose, wood wool slab, multi-layer
plate, soft fiber insulating, rock wool insulation panel and more

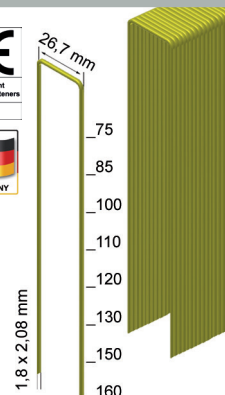

Metal
case

Pneumatic Stapler and Nailer 2P-J/ES40COMBI

Staples type ES from 15 - 40 mm and brads type J from 19 - 40 mm

Technical specification:
Weight: 1,5 kg
Operating pressure: approx. 5 - 7 bar
Air requirement: approx. 0,75 l / fastener
LxWxH: 240 x 57,5 x 235 mm

Safety device, exhaust silencer, no recoil, combi magazine,
adjustable exhaust, in a plastic case

Applications:

Panelling, wood moulding, decorative moulding, sheet material,
cabinet, flooring, furniture manufacturing, hardwood trim,
glazing beads, joinery manufacturing and more

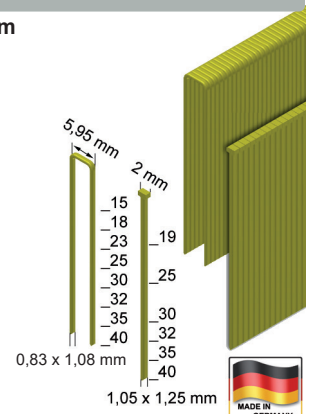

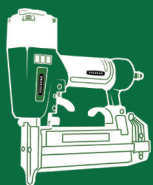

PNEUMATIC PINNER AND FINISH NAILER

Application



1GP-ALK35	2M-GA32SDS	2F-JA45	2P-J50SDS	2P-J50SVN	2P-J50STVN	3GP-N65	4S-DA63
-----------	------------	---------	-----------	-----------	------------	---------	---------

Upholsterer / Interior designer

Upholstery							
Dekoration							
Covering							
Tissue							
Leather, fell							
Foil, cardboard, paper							

Interior work / Drywall installation

Skirting, cover strip			X	X			X	X
Decorative molding	X	X	X	X			X	X
Panel ceiling								
Profile board								
Window / door								
Glazing bead	X	X	X	X	X	X	X	X
Ceiling lining / wall covering								
Parquet							X	X
Substructure								
Chipboard, OSB								
Gypsum fibre board								
Gypsum plaster board								
Exhibition stand construction	X	X	X	X			X	X
Acoustics	X	X	X	X			X	X

Carpenter / Roofer

Roof lath								
Roof boarding								
Outside boarding							X	X
Bottom-cover-boarding							X	X
Visual boarding							X	X
Weather boarding							X	X
Saving foamwork							X	X
Caping and verge boarding							X	X
Flue boarding								
Roof framework								
Substructure								
Framework								
Wooden truss								
Timber frame system								
Dormer								
Wood connector								
Roof cladding								
Valley board								
Inflow sheet								
Roofing felt / bitumen								
Insulation								

Packaging

Wooden box							X	X
Pallet								
Palett repair								
Cardboard box								
Cardboard closing								
Cardboard stapling								

Others

Wooden fence							X	X
Wire fence								
Small furniture	X	X	X	X			X	X
Furniture back board								
Case plinth								
Terrace building							X	
Garden house							X	
Carport							X	
Rack / bridge							X	
Flowering profile / ornaments	X	X						
Picture frame	X	X						



Pneumatic Pinner 1GP-ALK35

Pins without head type AL and with head type ALK from 12 - 35 mm

Technical specification:
Weight: 0,97 kg
Operating pressure: approx. 4 - 7 bar
Air requirement: approx. 0,36 l / pin
LxWxH: 225 x 50 x 208 mm

Optimized wearing parts, long service life, easy maintenance, ideal handling for multi-purpose usage, low weight, single and bump fire, user-friendly trigger system, practical magazine lock, no-mark tip, ergonomical anti-slip handle, side load magazine, lock-out safety device, exhaust air on the rear side, inspection window for magazine level,

Applications:
For invisible fixing of decorative moulding, glazing bead, cabinet and more

**OPTIWEAR-
TECHNOLOGY**

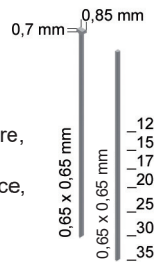

Pneumatic Pinner 2M-GA32SDS

Pins without head type GA from 16 - 30 mm

Technical specification:
Weight: 1,7 kg
Operating pressure: approx. 4 - 7 bar
Air requirement: approx. 0,55 l / pin
LxWxH: 225 x 49,5 x 186 mm

Bottom load magazine, exhaust silencer, no recoil, adjustable exhaust, in a plastic case

Applications:
For invisible fixing of decorative moulding, glazing bead, cabinet and more

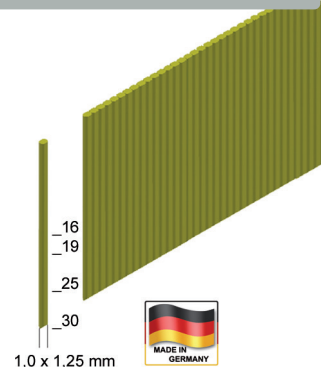

Finish Nailer 2F-JA45

Brads type JA from 16 - 45 mm

Technical specification:
Weight: 1,14 kg
Operating pressure: approx. 4 - 7 bar
Air requirement: approx. 0,52 l / brad
LxWxH: 280 x 55 x 216 mm

Safety device, single shot, adjustable depth control, lock-out safety device, no-mark tip, no recoil, exhaust silencer, beltclip, in a plastic case

Applications:
Decorative moulding, glazing bead, hardwood trim, joinery manufacturing, furniture manufacturing and more

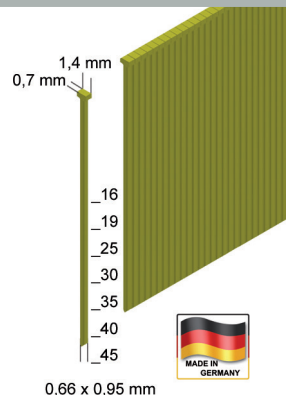

Finish Nailer 2P-J50SDS

Brads type J from 16 - 50 mm

Technical specification:
Weight: 1,25 kg
Operating pressure: approx. 5 - 7 bar
Air requirement: approx. 0,75 l / brad
LxWxH: 235 x 57,5 x 232 mm

Safety device, exhaust silencer, no recoil, side load magazine, adjustable exhaust, in a plastic case

Applications:
Decorative moulding, hardwood trim, glazing bead, joinery manufacturing, furniture manufacturing and more

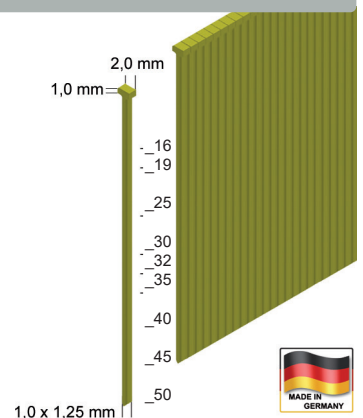

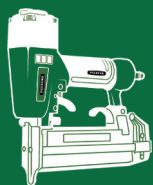

PNEUMATIC PINNER AND FINISH NAILER

Finish Nailer 2P-J50SVN for window glazing beads

Brads type J from 16 - 50 mm

Technical specification:

Weight: 1,5 kg

Operating pressure: approx. 5 - 7 bar

Air requirement: approx. 0,75 l / brad

LxWxH: 265 x 60 x 236,5 mm

Glass protector, safety device, exhaust silencer, no recoil, side load magazine, adjustable exhaust, in a plastic case

Applications:

Specialized tool for invisible fixing of glazing beads.

New trial for invisible fixing. Applicable for silicone- and dry glazing.

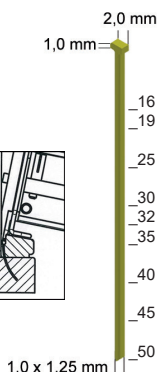
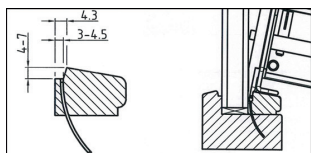

Finish Nailer 2P-J50STVN for window glazing beads

Brads type J from 16 - 50 mm

Technical specification:

Weight: 1,5 kg

Operating pressure: approx. 5-7 bar

Air requirement: approx. 0,75 l / brad

LxWxH: 265 x 60 x 236,5 mm

Glass protector, safety device, exhaust silencer, no recoil, side load magazine, adjustable exhaust, in a plastic case

Applications:

Specialized tool for invisible fixing of glazing beads. New trial for invisible fixing.

Applicable for dry glazing.

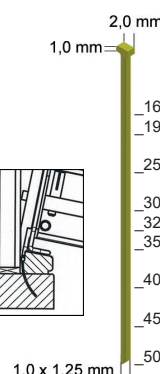
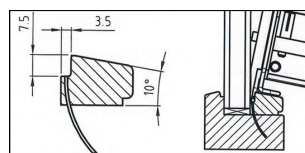

Finish Nailer 3GP-N65

Brads type N from 20 - 65 mm

Technical specification:

Weight: 1,85 kg

Operating pressure: approx. 5 - 7 bar

Air requirement: approx. 1,18 l / brad

LxWxH: 295 x 70 x 310 mm

Ideal handling for multi-purpose usage, low weight, user-friendly trigger system, practical magazine lock, bump fire, depth control, easy clear catch, no mark tip, belt hook, ergonomical anti-slip handle, in a plastic case

Applications:

Baseboard, facework, eave formwork, bead, lamination, parquet, wooden fence, steel base plate and more

**OPTIWEAR-
TECHNOLOGY**

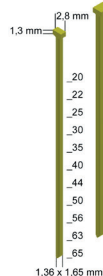

Finish Nailer 4S-DA63

Brads type DA from 25 - 63 mm

Technical specification:

Weight: 1,84 kg

Operating pressure: approx. 5 - 8 bar

Air requirement: approx. 1,45 l / brad

LxWxH: 318 x 90 x 315 mm

Safety device, no mar tip, exhaust silencer, no recoil, easy clear catch

Applications:

Flooring, framing, furniture manufacturing, prefabricated buildings, packing, pallet, parquet, wooden case, carpentry, joinery manufacturing and more

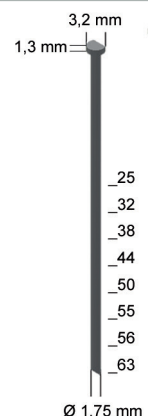

Angel 36°

Ø 1,75 mm



**Metal
case**



PNEUMATIC NAILER



www.prebena.com

Application



5C-WN15SNS
6F-WN25SNS
ST2-ANK50
ST2-ANK60
3GP-CNH50
3GP-CNW50
4X-CN245
5F-CNF57
5S-CNWS65
6F-CNW70
7F-CNW90
9F-CNW100-EPAL
5S-T65
6X-PR90
8F-RK10
10X-RK130
10X-RK160

Upholsterer / Interior designer

Upholstery																				
Dekoration																				
Covering																				
Tissue																				
Leather, fell																				
Foil, cardboard, paper																				

Interior work / Drywall installation

Skirting, cover strip																				
Decorative molding																				
Panel ceiling																				
Profile board																				
Window / door	X	X																		
Glazing bead																				
Ceiling lining / wall covering																				
Parquet																				
Substructure			X	X		X		X	X	X	X	X	X	X	X	X	X	X	X	X
Chipboard, OSB						X		X	X	X	X	X	X	X	X	X	X	X	X	X
Gypsum fibre board																				
Gypsum plaster board																				
Exhibition stand construction						X		X	X	X	X	X	X	X	X	X	X	X	X	X
Acoustics																				

Carpenter / Roofer

Roof lath								X	X	X	X	X		X	X					
Roof boarding								X	X	X	X	X		X	X					
Outside boarding						X		X	X	X	X	X		X	X					
Bottom-cover-boarding						X		X	X	X	X	X		X	X					
Visual boarding						X		X	X	X	X	X		X	X					
Weather boarding						X		X	X	X	X	X		X	X					
Saving foamwork								X	X	X	X	X		X	X					
Caping and verge boarding								X	X	X	X	X		X	X					
Flue boarding						X		X	X	X	X	X		X	X					
Roof framework			X	X				X	X	X	X	X		X	X	X	X	X	X	X
Substructure			X	X		X		X	X	X	X	X		X	X	X	X	X	X	X
Framework			X	X		X		X	X	X	X	X		X	X	X	X	X	X	X
Wooden truss			X	X														X	X	
Timber frame system			X	X		X		X	X	X	X	X		X	X	X	X	X	X	X
Dormer			X	X		X		X	X	X	X	X		X	X					
Wood connector			X	X																
Roof cladding						X														
Valley board						X								X						
Inflow sheet						X								X						
Roofing felt / bitumen								X												
Insulation								X												

Packaging

Wooden box						X		X	X	X	X	X	X	X	X					
Pallet						X		X	X	X	X	X	X	X	X					
Palett repair						X		X	X	X	X	X	X	X	X					
Cardboard box																				
Cardboard closing																				
Cardboard stapling																				

Others

Wooden fence						X		X	X	X	X	X	X	X	X					
Wire fence																				
Small furniture																				
Furniture back board																				
Case plinth	X	X																		
Terrace building			X	X		X		X	X	X	X	X	X	X	X	X	X	X	X	X
Garden house			X	X		X		X	X	X	X	X	X	X	X	X	X	X	X	X
Carport			X	X		X		X	X	X	X	X	X	X	X	X	X	X	X	X
Rack / bridge			X	X		X		X	X	X	X	X	X	X	X	X	X	X	X	X
Flowering profile / ornaments																				
Picture frame																				





PNEUMATIC NAILER

Corrugated Nailer 5C-WN15SNS

Corrugated fasteners type WN from 9 - 15 mm

Technical specification:

Weight: 2,4 kg

Operating pressure: approx. 5 - 8 bar

Air requirement: approx. 1,74 l / nail

LxWxH: 300,5 x 82 x 282,5 mm

Safety device, easy loading system for all length, single and bump fire, exhaust silencer, no recoil

Applications:

Butt corner joint, millwork, case plinth, window sash, picture frame and more

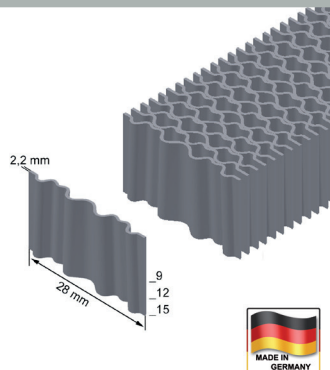

Metal case

Corrugated Nailer 6F-WN25SNS

Corrugated fasteners type WN 25 mm

Technical specification:

Weight: 4,1 kg

Operating pressure: approx. 5 - 8 bar

Air requirement: approx. 1,6 l / nail

LxWxH: 380 x 101 x 275 mm

Single shot, exhaust silencer, no recoil, side load magazine

Applications:

Butt corner joint, millwork, window sash, framing and construction and more



Metal case

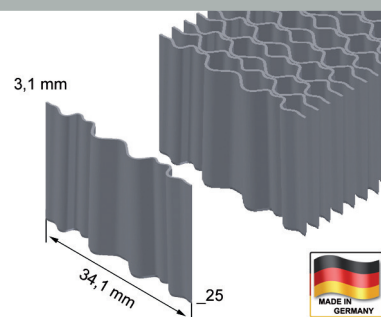

Anchornailer ST2-ANK50

Anchornails type ANK from 40 - 50 mm

Technical specification:

Weight: 1,9 kg

Operating pressure: approx. 7 - 8 bar

Air requirement: approx. 2,6 l / nail

LxWxH: 330 x 124,5 x 251,5 mm

Quick and easy loading of the back load magazine, small guide bar for exact position of the nails, low weight and compact construction for inaccessible places like corners and angles, ergonomic design

Applications:

Wood connector like angle connector, cross connector, hole plate and more

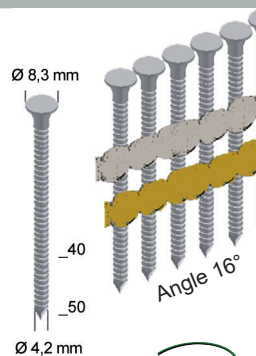

Metal case

Anchornailer ST2-ANK60

Anchornails type ANK from 40 - 60 mm

Technical specification:

Weight: 2,5 kg

Operating pressure: approx. 7-8 bar

Air requirement: approx. 3,1 l / nail

LxWxH: 316 x 116 x 278 mm

Quick and easy loading of the back load magazine, small guide bar for exact position of the nails, low weight and compact construction for inaccessible places like corners and angles, ergonomic design

Applications:

Wood connector like angle connector, cross connector, hole plate and more.



Metal case

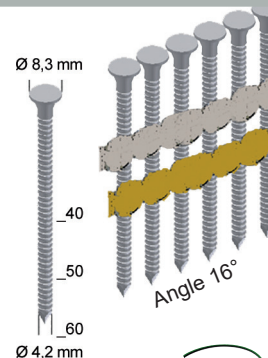

Pneumatic Construction Nailer 3GP-CNH50

Coilnails type CNH from 25 - 50 mm

Wire size: Ø 2,8 mm - sheet bounded for residue-free processing

Technical specification:

Weight: 1,97 kg

Operating pressure: approx. 5 - 8 bar

Air requirement: approx. 0,9 l / nail

LxWxH: 340 x 138 x 285 mm

**OPTIWEAR-
TECHNOLOGY**

Optimized wearing parts, long service life, easy maintenance, ideal handling for multi-purpose usage, special device for optimal nailing, depth adjustment, adjustable exhaust, operating comfort, user-friendly trigger, practical magazine lock, high-quality coil magazine, single shot, ergonomic rubbered handle grip

Applications:

Roof- and wall cladding of aluminium, stainless steel or titanium zinc, valley board and metal sheet fixing on wood

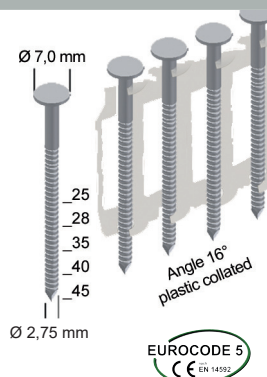

Coilnailer 3GP-CNW50

Coilnails type CNW from 32 - 50 mm

Wire size: Ø 2,1 - 2,3 mm - Flat or conical wound

Technical specification:

Weight: 1,92 kg

Operating pressure: approx. 5 - 8 bar

Air requirement: approx. 0,92 l / nail

LxWxH: 260 x 120 x 177 mm

**OPTIWEAR-
TECHNOLOGY**

Optimized wearing parts, long service life, easy maintenance, special device for optimal nailing, safety device, exhaust silencer, no recoil, depth adjustment, bump fire, no-mark tip, in a plastic case

Applications:

Sheeting, subfloor, exterior deck, decking, crate and box assembly, pallet and more.

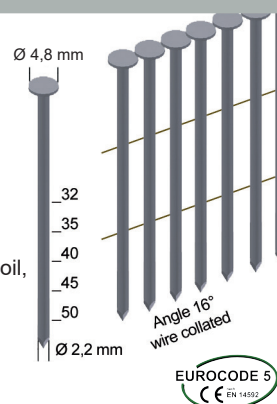

Roofing Nailer 4X-CNZ45

Roofing nails type CNZ from 19 - 45 mm

Wire size: Ø 3,1 mm

Technical specification:

Weight: 2,27 kg

Operating pressure: approx. 5 - 8 bar

Air requirement: approx. 1,7 l / nail

LxWxH: 265 x 118 x 274 mm

Fast-loading system, single and bump fire, rubberized safety bar, depth control, adjustable spacer, special tool for straight nailing, safety device, no recoil, exhaust silencer

Applications:

Drives full round-head roofing nail in a fastening asphalt and fiberglass shingle and more

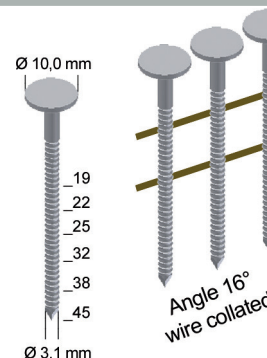

Coilnailer 5F-CNF57

Coilnails type CNF from 25 - 57 mm

Wire size: Ø 2,1 - 2,3 mm - Flat wounded

Technical specification:

Weight: 2,7 kg

Operating pressure: approx. 5 - 8 bar

Air requirement: approx. 1,55 l / nail

LxWxH: 302 x 132 x 285 mm

Robust construction, high power, bump fire - no single fire, safety device, adjustable exhaust.

Applications:

Pallet, framing, pallet repair, decking, subfloor, exterior deck, sheeting and more

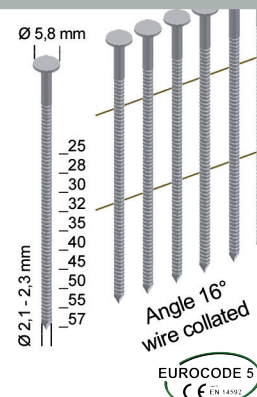



PNEUMATIC NAILER

Coilnailer 5S-CNWS65

Coilnails type CNW, CNS and nail screws type CSS from 32 - 65 mm

Wire size: \varnothing 2,5 - 2,8 mm

Wire collated and plastic collated - sheet bounded for residue-free processing

Technical specification:

Weight: 2,2 kg

Operating pressure: approx. 5 - 8 bar

Air requirement: approx. 1,87 l / nail

LxWxH: 286 x 128 x 310 mm

Depth control, single and bump fire, no-mark tip, safety device, exhaust silencer, belt hook, in a plastic case

Applications:

lathing, sheeting, exterior deck, crate and box assembly, pallet, pallet repair and more

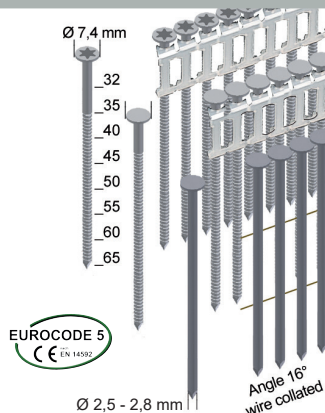

Coilnailer 6F-CNW70

Coilnails type CNW from 45 - 70 mm

Wire size: \varnothing 2,3 - 2,8 mm

Technical specification:

Weight: 3,6 kg

Operating pressure: approx. 5 - 8 bar

Air requirement: approx. 2,7 l / nail

LxWxH: 339 x 129 x 317 mm

Robust construction, high power, bump fire - no single fire, safety device, adjustable exhaust

Applications:

Pallet, pallet repair, wooden case, framing, decking, sheeting, subfloor, exterior deck, sheeting and more

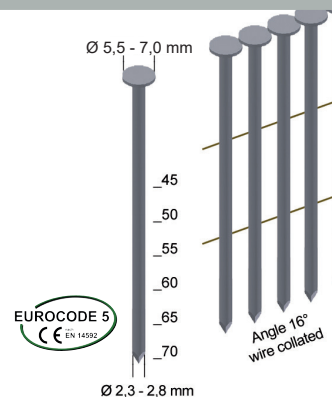

Coilnailer 7F-CNW90

Coilnails type CNW from 45 - 90 mm

Wire size: \varnothing 2,5 - 3,1 mm

Technical specification:

Weight: 3,7 kg

Operating pressure: approx. 5 - 8 bar

Air requirement: approx. 2,85 l / nail

LxWxH: 386 x 142 x 369 mm

Safety device, exhaust silencer, depth adjustment, single or bump fire, no-mark tip

Applications:

Decking, subfloor, exterior deck, sheathing, pallet, framing, pallet repair and more

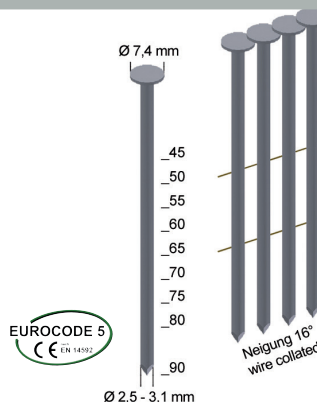

Metal case

Coilnailer 9F-CNW100-EPAL

Coilnails type CNW from 55 - 100 mm

Wire size: \varnothing 3,1 - 3,4 mm

Technical specification:

Weight: 5,3 kg

Operating pressure: approx. 5 - 8 bar

Air requirement: approx. 5,38 l / nail

LxWxH: 338 x 153 x 418 mm

Safety device, exhaust silencer, additional handle, single shot

Applications:

Decking, subfloor, exterior deck, sheathing, pallet, framing, pallet repair and more

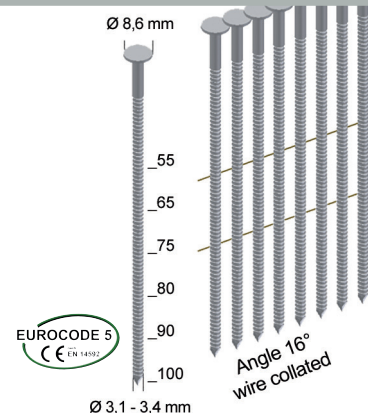

Metal case

Pneumatic Nailer 5S-T65

T-Nails type T from 18 - 65 mm

Technical specification:

Weight: 2,8 kg
Operating pressure: approx. 5 - 8 bar
Air requirement: approx. 1,46 l / nail
LxWxH: 320 x 100 x 315 mm

Singel and bump fire, safety device, exhaust silencer
no recoil, adjustable exhaust, in plastic bag

Applications:

Palett, wooden case, crate, packaging,
metal sheet, aluminium profile, prefabricated house, lathing,
landscape building and more

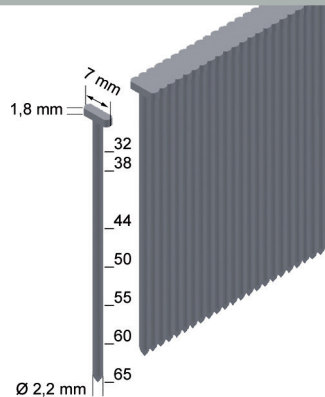

D-Head Stripnailer 6X-PR90

D-Head Stripnails type PR from 50 - 90 mm

Wire size: Ø 2,8 - 3,1 mm

Technical specification:

Weight: 3,1 kg
Operating pressure: approx. 5 - 8 bar
Air requirement: approx. 2,47 l / nail
LxWxH: 455 x 105 x 400 mm

Lock-out safety device, bump fire, depth adjustment, exhaust silencer,
beltclip, rubber grip handle, no recoil, adjustable exhaust

Applications:

Wooden cases, framing, pallet,
prefabricated building, decking, sheathing and more

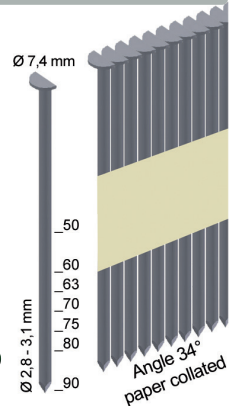

Round-Head Stripnailer 8F-RK100

Round-Head Stripnails type RK and RKP from 50 - 100 mm

Wire size: Ø 2,8 - 3,4 mm

Technical specification:

Weight: 3,6 kg
Operating pressure: approx. 5 - 8 bar
Air requirement: approx. 2,25 l / nail
LxWxH: 529 x 139 x 369 mm

Safety device, bump fire, exhaust silencer, depth control

Applications:

Decking, sheathing, lathing, wooden-case, framing,
pallet, prefabricated building and more

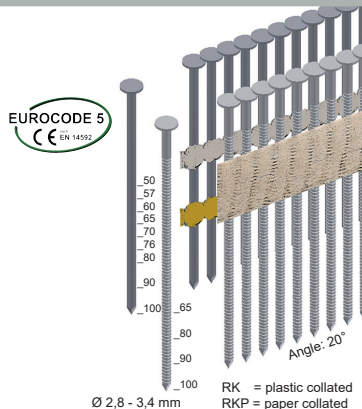

Metal
case

Round-Head Stripnailer 10X-RK130

Round-Head Stripnails type RK from 90 - 130 mm and RKP 100 mm - Wire size: Ø 3,4 - 4,2 mm

Technical specification:

Weight: 6,1 kg
Operating pressure: approx. 5 - 8 bar
Air requirement: approx. 4,3 l / nail
LxWxH: 553 x 175 x 478 mm

Single fire, safety device, exhaust silencer, additional handle,
lock-out safety device, strong magazine

Applications:

Wooden truss, lathing, pallet, prefabricated building,
crate, substructure, framework and more



Metal
case

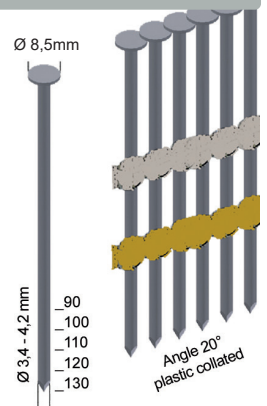



PNEUMATIC NAILER

Round-Head Stripnailer 10X-RK160

Round-Head Stripnails type RK from 100 - 160 mm
Wire size: Ø 3,8 - 4,6 mm

Technical specification:
Weight: 6,9 kg
Operating pressure: approx. 6 - 8 bar
Air requirement: approx. 4,9 l / nail
LxWxH: 568 x 145 x 478 mm

Single fire, safety device, exhaust silencer, additional handle,
lock-out safety device, strong magazine

Applications:
Wooden truss, lathing, pallet, prefabricated construction,
crate, substructure, framework and more

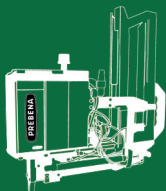
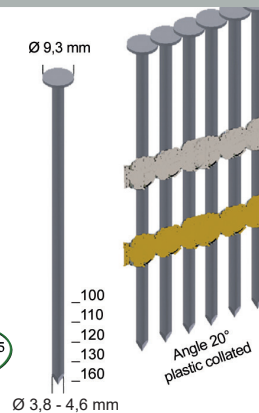

PNEUMATIC INDUSTRIAL STAPLER MODUL

Application



MODUL 11-Z64	MODUL 11-Z80	MODUL 11-WP130	BDI+ MODUL 1-Z64	4C-L50-AUT	4C-Z50-AUT	SLIDER 5C-Q67	SLIDER 5C-Z75	SLIDER 7F-CNW90
--------------	--------------	----------------	------------------	------------	------------	---------------	---------------	-----------------

Interior work / Drywall installation

Skirting, cover strip								
Decorative molding								
Panel ceiling								
Profile board								
Window / door								
Glazing bead								
Ceiling lining / wall covering								
Parquet								
Substructure								
Chipboard, OSB				X	X	X	X	X
Gypsum fibre board				X	X	X	X	
Gypsum plaster board				X	X	X	X	
Exhibition stand construction				X	X			
Acoustics								

Carpenter / Roofer

Roof lath								
Roof boarding								
Outside boarding				X	X			
Bottom-cover-boarding								
Visual boarding				X	X			
Weather boarding								
Saving foamwork								
Caping and verge boarding								
Flue boarding								
Roof framework								
Substructure								
Framework								
Wooden truss								
Timber frame system	X	X	X	X	X	X	X	X
Dormer								
Wood connector								
Roof cladding								
Valley board								
Inflow sheet								
Roofing felt / bitumen								
Insulation								



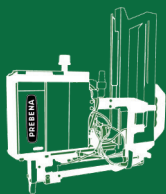

PNEUMATIC INDUSTRIAL STAPLER MODUL



www.prebena.com

MODUL 11-Z64 with changeable magazine

Staples type Z from 50 - 64 mm

Technical specification:

Weight: 9,75 kg
Weight incl. staples: 15,85 kg
Operation pressure: 4,5 - 7,5 bar
Air requirement: 1,8 l / staple up to 6 bar
Magazine capacity: 32 staple strips = 2.304 staples
Measurement LxWxH: 484 x 118 x 500 mm

Cooling of the bumper by equipment exhaust air
→ longer service intervals

Large volume of air inside the body
→ fast rate of shooting

Max. shot frequency
→ 12 shots / second

Triggering system: external triggering by PLC program
Magazine system: top load by changing magazine
Control port: XLR-port-6-pole
Ready for installation



1,4 x 1,65 mm

Industrial packaging
for quick reloading

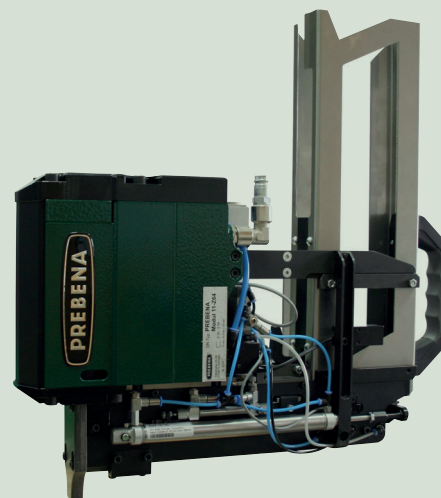

MODUL 11-Z80 with changeable magazine

Staples type Z from 50 - 80 mm

Technical specification:

Weight: 14,5 kg
Weight incl. staples: 21 kg
Operation pressure: 4,5 - 7,5 bar
Air requirement: 3,4 l / staple up to 6 bar
Magazine capacity: 32 staple strips = 2.304 staples
Measurement LxWxH: 484 x 118 x 500 mm

Cooling of the bumper by equipment exhaust air
→ longer service intervals

Large volume of air inside the body
→ fast rate of shooting

Max. shot frequency
→ 12 shots / second

Triggering system: external triggering by PLC program
Magazine system: top load by changing magazine
Control port: XLR-port-6-pole
Ready for installation



1,4 x 1,65 mm



MODUL 11-WP130 with changeable magazine

Staples type WP from 75 - 130 mm

Technical specification:

Weight: 15,5 kg
Weight incl. staples: 19,75 kg
Operation pressure: 5 - 7,5 bar
Air requirement: 5,1 l / staple up to 6 bar
Magazine capacity: 15 staple strips = 600 staples
Measurement LxWxH: 500 x 141 x 531 mm

Cooling of the bumper by equipment exhaust air
→ longer service intervals

Large volume of air inside the body
→ fast rate of shooting

Max. shot frequency
→ 12 shots / second

Triggering system: external triggering by PLC program
Magazine system: top load by changing magazine
Control port: XLR-port-6-pole
Ready for installation



1,8 x 2,08 mm

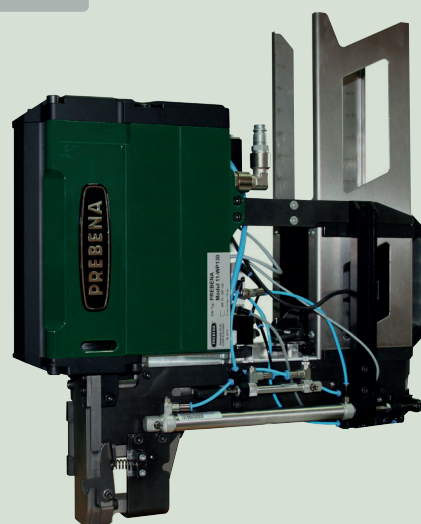

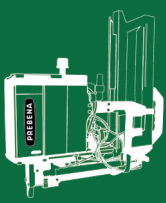

PNEUMATIC INDUSTRIAL STAPLER MODUL + AUTOMATIC

BDI+ MODUL 11-Z64

**Mobile stapling in industrial manufacturing
for staples type Z from 50 - 64 mm**

**For laying of large-scale substructures wood
and chipboard**

for example indoor floors, flat roofs and prefabricated houses and more

Weight: 77 kg

Measurement LxWxH: 850 x 500 x 500 mm

- Integrated MODUL 11-Z64 with changeable magazine
- Roll-controlled adjustable staple distance von 0 - 1000 mm
- Angle of staples 30° by Eurocode 5
- Shunt mode for inaccessible places
- Independed work battery operation
- Lock-out safety device
- Continuous height adjustment
- Laserpointer for easy tracking stability
- Practical control panel
- Removable handle
- Control panel with:
Counter mechanism, magazine fill controller, pastor observation

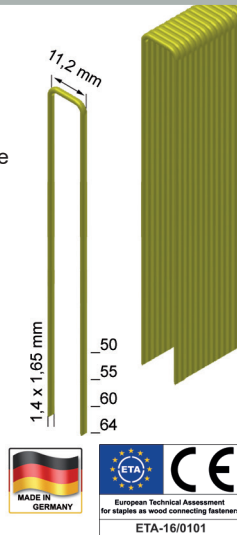

Automatic Pneumatic Stapler 4C-L50-AUT



**Metal
case**

Staples type L from 19 - 50 mm

Technical specification:

Weight: 3,0 kg

Operating pressure: approx. 5 - 8 bar

Air requirement: approx. 1,72 l / nail

Magazine capacity: 160 staples

LxWxH: 360 x 85 x 330 mm

Stageless variable rate of fire up to 10 shots / second,
applicable with single, bump or automatic fire,
sliding feet for optimal handling,
increased driver, easy clear catch, adjustable exhaust,
ergonomic handle, safety device, exhaust silencer

Applications:

Industrial converting of plaster, fermacell, fiberboard and
further board materials

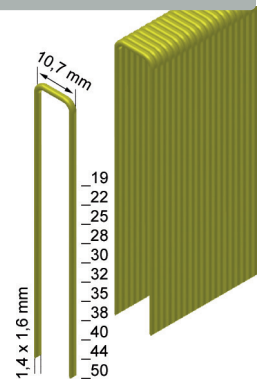

Automatic Pneumatic Stapler 4C-Z50-AUT

Staples type Z from 19 - 50 mm

Technical specification:

Weight: 3,0 kg

Operating pressure: approx. 5 - 8 bar

Air requirement: approx. 1,72 l / nail

Magazine capacity: 160 staples

Measurement LxWxH: 360 x 85 x 330 mm

Stageless variable rate of fire up to 10 shots / second,
applicable with single, bump or automatic fire,
sliding feet for optimal handling,
increased driver, easy clear catch, adjustable exhaust,
ergonomic handle, safety device, exhaust silencer

Applications:

Industrial converting of plaster, fermacell, fiberboard and
further board materials

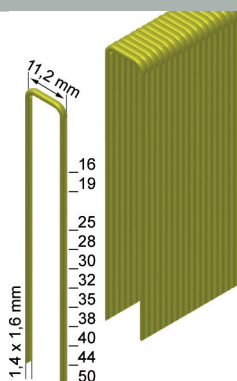

**Metal
case**

Slider 5C-Q75



with PREBENA Pneumatic Stapler 5C-Q67
for stapes type Q from 38 - 67 mm

- No electrical connection necessary
- Pneumatic / mechanical regulation
- Shooting of the staples in accurate, constant distances
- Angle of staple entry 30° according to EN 1995-1-1

Weight: 9,98 kg
Operation pressure: 5 - 8 bar
Air requirement: 2,3 l / staple
Measurement LxWxH: 455 x 335 x 455 mm

- Single shot everytime double-sided possible
- Lock-out safety device
- Applicable in both directions
- Roll-controlled automatic fire
- Distance adjustment for 40, 60, 80, 110 mm
- Guide-sight slot
- Adjustable lateral stop
- Safety device - Operation only when device on material
- Double-sided operable
- Adjustable depth control
- Rubberized wheels
- Adjustable exhaust
- Quick release

Applications:
Plasterboard, gypsum fiberboard, woodencomposite board

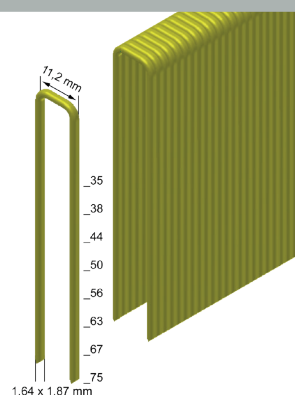

Slider 5C-Z75

with PREBENA Pneumatic Stapler 5C-Z75
for stapes type Z from 35 - 75 mm

- No electrical connection necessary
- Pneumatic / mechanical regulation
- Shooting of the staples in accurate, constant distances
- Angle of staple entry 30° according to EN 1995-1-1

Weight: 9,98 kg
Operation pressure: 5 - 8 bar
Air requirement: 2,3 l / staple
Measurement LxWxH: 455 x 335 x 455 mm

- Single shot everytime double-sided possible
- Lock-out safety device
- Applicable in both directions
- Roll-controlled automatic fire
- Distance adjustment for 40, 60, 80, 110 mm
- Guide-sight slot
- Adjustable lateral stop
- Safety device - Operation only when device on material
- Double-sided operable
- Adjustable depth control
- Rubberized wheels
- Adjustable exhaust
- Quick release

Applications:
Plasterboard, gypsum fiberboard, woodencomposite board (e.g. OSB)

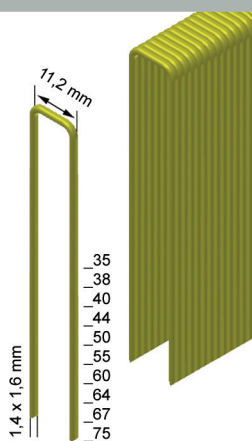

Slider 7F-CNW90

with PREBENA Pneumatic Nailer 7F-CNW90
for coilnails type CNW from 45 - 90 mm, wire size:

- No electrical connection necessary
- Pneumatic / mechanical regulation
- Shooting of the staples in accurate, constant distances

Weight: 11 kg

Operation pressure: 5 - 8 bar

Air requirement: 2,85 l / nail

Measurement LxWxH: 455 x 345 x 455 mm

- Single shot everytime double-sided possible
- Applicable in both directions
- Roll-controlled automatic fire
- Distance adjustment for 40, 60, 80, 110 mm
- Guide-sight slot
- Adjustable lateral stop
- Safety device - Operation only when device on material
- Double-sided operable
- Adjustable depth control
- Rubberized wheels
- Adjustable exhaust

Applications:

wooden composite boards (e.g. OSB)

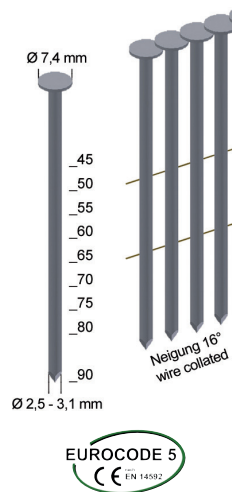

Extension for handle - Z98016801

for use in upright gear

- easy handling
- tool-free installation



Telescope handle

Optimal guidance in all application areas such as on worktables or in upright position

- Foldable - lockable in 3 positions possible
- Operable in all 3 positions
- Extendable - up to 78 cm (30.7 in.) on both sides
- Operable from both sides
- Additional wheels and extended wheelbase for optimal guidance

Available as:
SLIDER 5C-Q67-T
SLIDER 5C-Z75-T





KT VH-B19H
KT VH-B19D
KT VH-B22D
KT VH-R19H
KT VH-R19D
1A-AZ16BNH
1A-AZ25BNH
1GP-A16NH
4C-WZ38BNH
4C-WZ38BNH-400
4X-CW38

Upholstery
Dekoration
Covering
Tissue
Leather, fell
Foil, cardboard, paper

[illegible]

Skirting, cover strip
Decorative molding
Panel ceiling
Profile board
Window / door
Glazing bead
Ceiling lining / wall covering
Parquet
Substructure
Chipboard, OSB
Gypsum fibre board
Gypsum plaster board
Exhibition stand construction
Acoustics

[illegible]

- Roof lath
- Roof boarding
- Outside boarding
- Bottom-cover-boarding
- Visual boarding
- Weather boarding
- Saving foamwork
- Caping and verge boarding
- Flue boarding
- Roof framework
- Substructure
- Framework
- Wooden truss
- Timber frame system
- Dormer
- Wood connector
- Roof cladding
- Valley board
- Inflow sheet
- Roofing felt / bitumen
- Insulation

[illegible]

- Wooden box
- Pallet
- Palett repair
- Cardboard box
- Cardboard closing
- Cardboard stapling

										X
										X
X	X	X	X	X						
					X	X	X	X	X	

Wooden fence
Wire fence
Small furniture
Furniture back board
Case plinth
Terrace building
Garden house
Carport
Rack / bridge
Flowering profile / ornaments
Picture frame

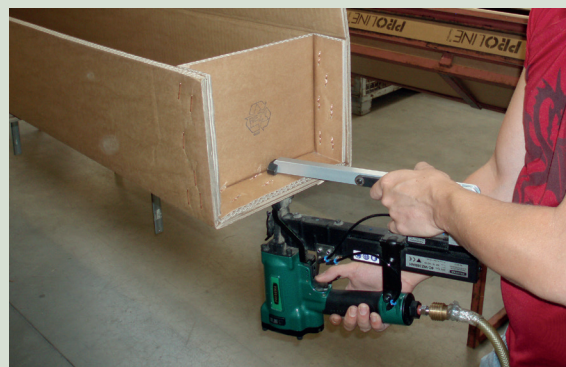

Carton Stapler „Manual“ KTVH-B19H

Staples type B from 16 - 19 mm

Technical specification:

Weight: 2,9 kg

Measurement LxWxH: 410 x 120 x 288 mm

Sophisticated bender, additional handle, easy loading system, depth adjustment, handle protection with anti-slip coating

Applications:

Top of full folded box and bottom of empty folded box of simple or double corrugated cardboard.

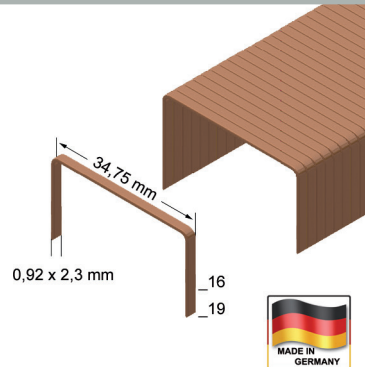

Carton Stapler „Manual“ KTVH-R19H

Staples type R from 16 - 19 mm

Technical specification:

Weight: 2,9 kg

Measurement LxWxH: 410 x 120 x 288 mm

Sophisticated bender, additional handle, easy loading system, depth adjustment, handle protection with anti-slip coating

Applications:

Top of full folded box and bottom of empty folded box of simple or double corrugated cardboard.

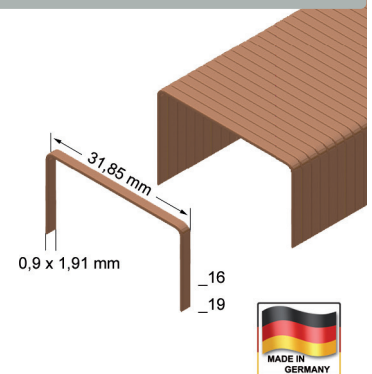

Carton Stapler „Pneumatic“ KTVH-B19D

Staples type B from 16 - 19 mm

Technical specification:

Weight: 2 kg

Operating pressure: approx. 5-7 bar

Air requirement: approx. 0,12 l / staple

Measurement LxWxH: 347 x 120 x 227 mm

Sophisticated bender, exhaust silencer, no recoil, easy loading system, high shot sequence, handle protection with anti-slip coating

Applications:

Top of full folded box and bottom of empty folded box of single or double corrugated cardboard.

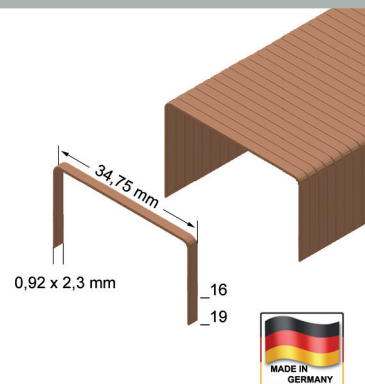

Carton Stapler „Pneumatic“ KTVH-R19D

Staples type R from 16 - 19 mm

Technical specification:

Weight: 2 kg

Operating pressure: approx. 5-7 bar

Air requirement: approx. 0,12 l / staple

Measurement LxWxH: 347 x 120 x 227 mm

Sophisticated bender, exhaust silencer, no recoil, easy loading system, high shot sequence, handle protection with anti-slip coating

Applications:

Top of full folded box and bottom of empty folded

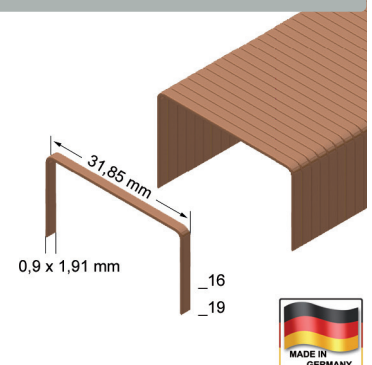



PACKAGING

Carton Stapler „Pneumatic“ KTVH-B22D

Staples type B from 19 - 22 mm

Technical specification:

Weight: 2,1 kg

Operating pressure: approx. 5-7 bar

Air requirement: approx. 0,12 l / staple

Measurement LxWxH: 347 x 120 x 227 mm

Sophisticated bender, exhaust silencer, no recoil, easy loading system, high shot sequence, handle protection with anti-slip coating

Applications:

Top of full folded box and bottom of empty folded box of single or double corrugated cardboard.

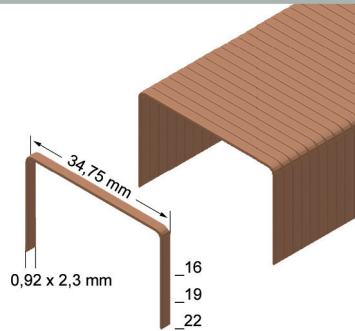

Carton Closing Stapler "Manual" and "Pneumatic"

Sophisticated benders guarantees an easy and safe handling with a convincing result.



Pneumatic Plier Stapler 1A-AZ16BNH

Staples type AZ from 10 - 16 mm

Technical specification:

Weight: 2,45 kg

Operating pressure: approx. 5-7 bar

Air requirement: approx. 0,62 l / nail

Measurement LxWxH: 362 x 78 x 300 mm

Adjustable matrix for carton strength 6-12 mm, large loading capacity due to an extended magazine, extended throat depth of 140 mm, adjustable exhaust, exhaust silencer, ergonomic handle grip

Applications:

Ensures a quick and solid stapling for any application where edges of cardboard have to be fastened. All packed items remain intact. Cardboard boxes from 6 - 12 mm can quickly and easily implemented.

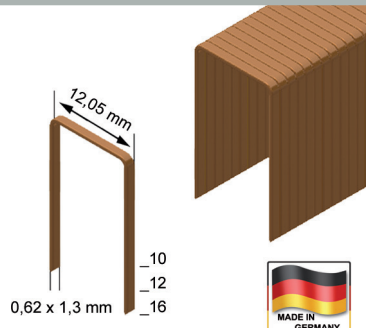

Metal case

Pneumatic Plier Stapler 1A-AZ25BNH

Staples type AZ from 12 - 25 mm

Technical specification:

Weight: 2,45 kg

Operating pressure: approx. 5-7 bar

Air requirement: approx. 0,62 l / nail

Measurement LxWxH: 362 x 78 x 300 mm

Adjustable matrix for carton strength 6-12 mm, large loading capacity due to a extended magazine, extended throat depth of 140 mm, adjustable exhaust, exhaust silencer, ergonomic handle grip

Applications:

Ensures a quick and solid stapling for any application where edges of cardboard have to be fastened. All packed items remain intact. Cardboard boxes from 14 - 20 mm can quickly and easily implemented.



Metal case

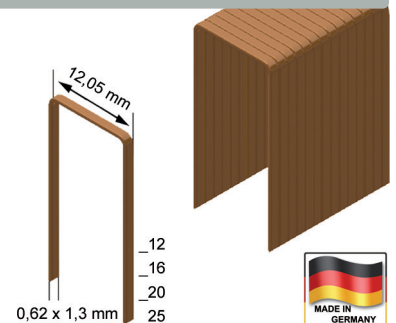

Optimal stapling through special matrix

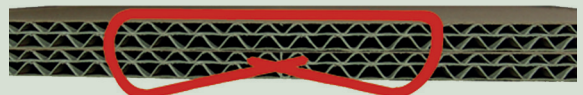

Pneumatic Plier Stapler 1GP-A16NH

Staples type A from 4 - 16 mm

Technical specification:

Weight: 1,1 kg
Operating pressure: approx. 4 - 6 bar
Air requirement: approx. 0,27 l / staple
Measurement LxWxH: 220 x 50 x 180 mm

Adjustable matrix, bottom load magazine, exhaust silencer, no recoil, adjustable exhaust, extended throat depth of 150 mm

Applications:

Special stapler with adjustable matrix for paper, cardboard, veneer, plastic, upholstery and other materials

**OPTIWEAR-
TECHNOLOGY**

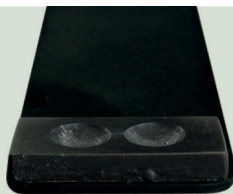

Functional bending system

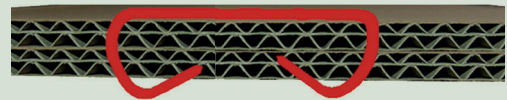

Pneumatic Wide Crown Plier Stapler 4C-WZ38BNH

Staples type WZ from 24 - 38 mm

Technical specification:

Weight: 3,7 kg
Operating pressure: approx. 5-8 bar
Air requirement: approx. 1,45 l / nail
Measurement LxWxH: 360 x 98 x 312 mm

Adjustable matrix for carton strength of 16 up to 30 mm, extended throat depth of 220 mm, adjustable exhaust, safety device, single fire, exhaust silencer, ergonomic rubberized handle

Applications:

Stapling of 1 and 2 corrugated cardboards and solid fiberboard. Ideal for carton blank, reverse drawing box, carton-tray, slot cover etc. box of single or double corrugated cardboard

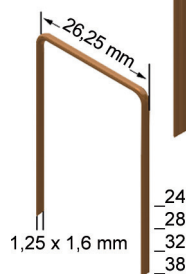

Metal case

Pneumatic Wide Crown Plier Stapler 4C-WZ38BNH-400

Staples type WZ from 32 - 38 mm

Technical specification:

Weight: 4,3 kg
Operating pressure: approx. 5-8 bar
Air requirement: approx. 1,45 l / nail
Measurement LxWxH: 540 x 98 x 312 mm

Long and adjustable matrix up to 400 mm extended throat depth, adjustable carton strength for 16 up to 30 mm, adjustable exhaust, safety device, single fire, exhaust silencer, ergonomic rubberized handle

Applications:

Stapling of 1 and 2 corrugated cardboard and solid fiberboard. Ideal for carton blank, reverse drawing box, carton-tray, slot cover etc.

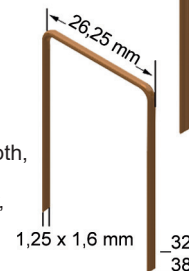

Metal case



Optimal stapling through special matrix

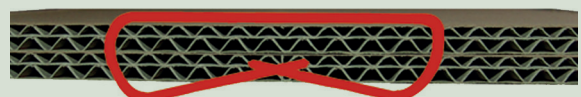



PACKAGING

Pneumatic Wide Crown Stapler 4C-WS38

Staples type WS from 16 - 38 mm

Technical specification:

Weight: 2,6 kg

Operating pressure: approx. 5-8 bar

Air requirement: approx. 1,36 l / staple

Measurement LxWxH: 360 x 85 x 236 mm

Adjustable depth control with no-mar tip,
easy clear catch, adjustable spacer, exhaust silencer,
adjustable exhaust, handle protection

Applications:

Cardboard box, wooden pallet, asphalt shingle,
lathing roofing felt, insulation, foam sheathing, etc.
box of single or double corrugated cardboard

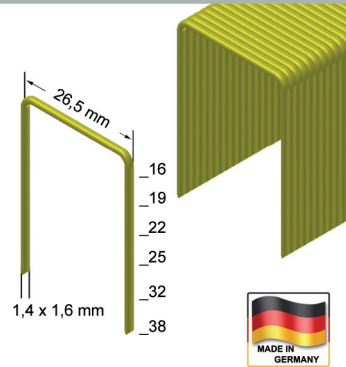

Metal
case

Extension VLA-DN

Weight: 2,6 kg

Measurement LxWxH: 360 x 85 x 236 mm

Applications:

Extension to fix on Pneumatic Stapler to
make work easier.

For Example:

Fastening of cardboard boxes on pallets.

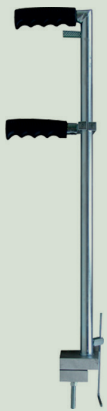



XR - SERIES FOR HOME AND HOBBY - DIY



www.prebena.com

Application



	1XR-A16	2XR-ES40	2XR-J50	7XR-RK90	8XR-CNW90
--	---------	----------	---------	----------	-----------

Upholsterer / Interior designer

Upholstery	X	X			
Dekoration	X	X			
Covering	X	X			
Tissue	X	X			
Leather, fell	X				
Foil, cardboard, paper	X				

Interior work / Drywall installation

Skirting, cover strip			X		
Decorative molding			X		
Panel ceiling		X			
Profile board		X			
Window / door					
Glazing bead			X		
Ceiling lining / wall covering		X			
Parquet					
Substructure				X	X
Chipboard, OSB				X	X
Gypsum fibre board		X			
Gypsum plaster board		X			
Exhibition stand construction	X	X	X	X	X
Acoustics	X	X	X		

Carpenter / Roofer

Roof lath				X	X
Roof boarding				X	X
Outside boarding					
Bottom-cover-boarding					
Visual boarding					
Weather boarding					
Saving foamwork					
Caping and verge boarding					
Flue boarding					
Roof framework				X	X
Substructure				X	X
Framework				X	X
Wooden truss				X	X
Timber frame system				X	X
Dormer				X	X
Wood connector					
Roof cladding					
Valley board					
Inflow sheet					
Roofing felt / bitumen					
Insulation					

Packaging

Wooden box				X	X
Pallet				X	X
Palett repair				X	X
Cardboard box					
Cardboard closing					
Cardboard stapling					

Others

Wooden fence				X	X
Wire fence					
Small furniture					
Furniture back board					
Case plinth					
Terrace building				X	X
Garden house				X	X
Carport				X	X
Rack / bridge				X	X
Flowering profile / ornaments					
Picture frame					

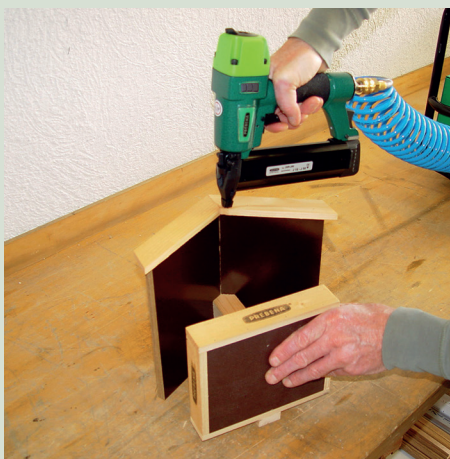



XR - SERIES FOR HOME AND HOBBY - DIY

PNEUMATIC STAPLER 1XR-A16

Staples type A from 4 - 16 mm

Technical specification:

Weight: 0,75 kg

Operating pressure: approx. 4-7 bar

Air requirement: approx. 0,3 l / staple

Measurement LxWxH: 230 x 48 x 166 mm

Safety device, adjustable exhaust, bottom load magazine, no recoil, exhaust silencer, in a plastic case

Applications:

Upholstery, decoration, molding, picture frame, insulation, roofing felt, building paper, carpet and underlay and more

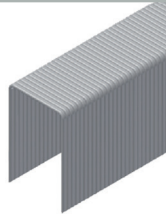
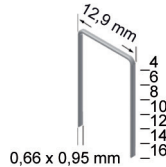

Pneumatic Stapler 2XR-ES40

Staples type ES from 15 - 40 mm

Technical specification:

Weight: 1,3 kg

Operating pressure: approx. 4-7 bar

Air requirement: approx. 0,6 l / staple

Measurement LxWxH: 245 x 56 x 244 mm

Safety device, adjustable exhaust, bottom load magazine, no recoil, exhaust silencer, adjustable depth control, no-mark tip, in a plastic case

Applications:

Panelling, furniture manufacturing, sheet material, cabinet, flooring, decorative molding and more

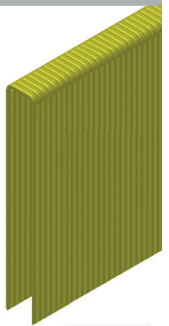
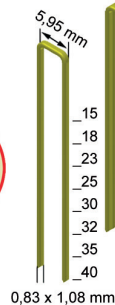

Pneumatic Nailer 2XR-J50

Brads type J from 16 - 50 mm

Technical specification:

Weight: 1,3 kg

Operating pressure: approx. 4-7 bar

Air requirement: approx. 0,6 l / staple

Measurement LxWxH: 245 x 56 x 244 mm

Safety device, adjustable exhaust, side load magazine, no recoil, exhaust silencer, adjustable depth control, no-mark tip, in a plastic case

Applications:

Decorative molding, glazing bead, hardwood trim, joinery manufacturing, furniture manufacturing and more

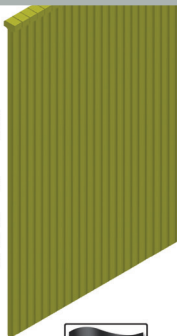
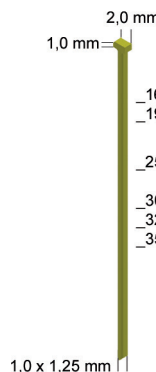

Pneumatic Nailer 7XR-RK90

Round-Head Stripnails type RK from 50 - 90 mm Wire size: 2,8 - 3,1 mm

Technical specification:

Weight: 3,2 kg

Operating pressure: approx. 4-7 bar

Air requirement: approx. 2,0 l / staple

Measurement LxWxH: 530 x 110 x 370 mm

Safety device, adjustable exhaust, back load magazine, no-mark tip, no recoil, exhaust silencer, lock-out safety device, single or bump fire, in a plastic case

Applications:

Decking, sheeting, substructure, rack making, shuttering, prefabricated house, wooden case, lathing, pallet, framing and more

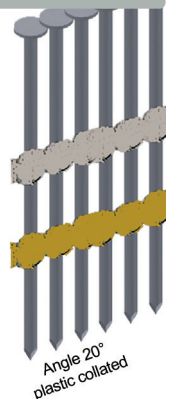

Coilnailer 8XR-CNW90

Round-Head Coilnails type RK from 45 - 90 mm
Wire size: 2,5 - 3,1 mm

Technical specification:

Weight: 4,1 kg

Operating pressure: approx. 5-8 bar

Air requirement: approx. 2,3 l / staple

Measurement LxWxH: 375 x 140 x 375 mm

Single and contact trigger, safety device, depth adjustment, adjustable exhaust silencer, in plastic case

Applications:

Wooden fences, garden houses, terraces, carports, walkways, wooden gates, small animal houses, formwork, roof battens and much more

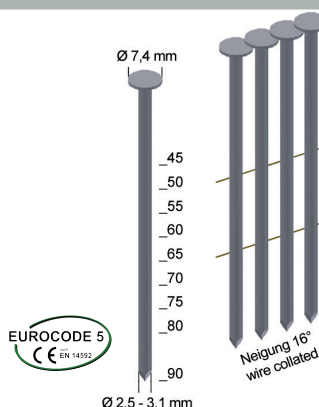

Fasteners in plastic case



A-BOX
9.000 Staples type A - galvanized

3.000 x A06CNK
 3.000 x A08CNK
 3.000 x A10CNK

For PREBENA Pneumatic Stapler:

- 1GP-A16
- 1GP-A16SDS
- 1GP-A16LN50
- 1GP-A16NH
- 1GP-A25
- 1XR-A16
- 1X-A16AUT
- 1X-A16LM-AUT



ES-BOX
6.000 Staples type ES - galvanized, coated

2.000 x ES26CNKHA
 2.000 x ES32CNKHA
 2.000 x ES40CNKHA

For PREBENA Pneumatic Stapler:

- PKT-2-ES40
- 2P-ES40SDS
- 2P-J/ES40COMBI
- 2XR-ES40



PF-BOX
9.000 Staples type PF - galvanized

2.000 x PF06CNK
 5.000 x PF09CNK
 2.000 x PF14CNK

For PREBENA Pneumatic Stapler:

- DNPF16

For PREBENA Hand and Hammer Tacker:

- HPPF14
- HFPF09
- HFUPF09
- HFPF14



J-BOX
8.000 Brads type J - galvanized, coated

2.000 x J25CNKHA
 2.000 x J32CNKHA
 2.000 x J40CNKHA
 2.000 x J50CNKHA

For PREBENA Pneumatic Stapler:

- PKT-2-J50SD-S
- PKT-2-J50SD-SVN
- 2P-J50SDS
- 2P-J50SVN
- 2P-J50STVN
- 2P-J/ES40COMBI
- 2XR-J50



RK-BOX
1.680 Round-Head Stripnails type RK -bright

960 x RK28/65BK
 720 x RK31/90BK

For PREBENA Pneumatic Nailer:

- PKT-7-RK90
- 7XR-RK90
- 8F-RK100

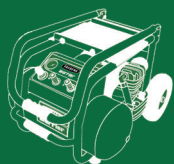

COMPRESSORS

Applications from A-Z	Air requirement (l/min.) for an application	Operating pressure (bar)	PKT-TWINTER 400	AEROTAINER 245	VITAS 45	VIGON 120	VIGON 240	VIGON 300	PIONEER 260	PIONEER 345	WARRIOR 255	WARRIOR 435	WARRIOR 460	ORKAN 260	TWINMAX 420	TWINSTAR 470	TWINSTAR 670	TWINSTAR 860-15	TWINSTAR 970	MOUNTAINE 670	MOUNTAINE 1450	ORKAN 670	SK 7,5-10	SK 15 -10
Blow gun	90-200	2-6	👍	👍	👍	👍	👍	👍	👍	👍	👍	👍	👍	👍	👍	👍	👍	👍	👍	👍	👍	👍	👍	👍
Beton compactor	300	4-6	👎	👎	👎	👎	👎	👎	👎	👎	👎	👎	👎	👎	👎	👎	👎	👎	👎	👎	👎	👎	👎	👎
Metal shears	280	6	👎	👎	👎	👎	👎	👎	👎	👎	👎	👎	👎	👎	👎	👎	👎	👎	👎	👎	👎	👎	👎	👎
Metal gwaner	350	6	👎	👎	👎	👎	👎	👎	👎	👎	👎	👎	👎	👎	👎	👎	👎	👎	👎	👎	👎	👎	👎	👎
Drill machine	400	6	👎	👎	👎	👎	👎	👎	👎	👎	👎	👎	👎	👎	👎	👎	👎	👎	👎	👎	👎	👎	👎	👎
Paint spraying gun	200	3-4	👎	👎	👎	👎	👎	👎	👎	👎	👎	👎	👎	👎	👎	👎	👎	👎	👎	👎	👎	👎	👎	👎
Grease press	0,5	2-8	👍	👍	👍	👍	👍	👍	👍	👍	👍	👍	👍	👍	👍	👍	👍	👍	👍	👍	👍	👍	👍	👍
Exentergrinder	350	6	👎	👎	👎	👎	👎	👎	👎	👎	👎	👎	👎	👎	👎	👎	👎	👎	👎	👎	👎	👎	👎	👎
Cavity gun	210	1-6	👎	👎	👎	👎	👎	👎	👎	👎	👎	👎	👎	👎	👎	👎	👎	👎	👎	👎	👎	👎	👎	👎
Auto body saw	220	6	👎	👎	👎	👎	👎	👎	👎	👎	👎	👎	👎	👎	👎	👎	👎	👎	👎	👎	👎	👎	👎	👎
Cylinder gun	-	3-5	👍	👍	👍	👍	👍	👍	👍	👍	👍	👍	👍	👍	👍	👍	👍	👍	👍	👍	👍	👍	👍	👍
Chipping hammer small	240	4-6	👎	👎	👎	👎	👎	👎	👎	👎	👎	👎	👎	👎	👎	👎	👎	👎	👎	👎	👎	👎	👎	👎
Chipping hammer big	450	4-6	👎	👎	👎	👎	👎	👎	👎	👎	👎	👎	👎	👎	👎	👎	👎	👎	👎	👎	👎	👎	👎	👎
Needle scaler	120-200	4-8	👎	👎	👎	👎	👎	👎	👎	👎	👎	👎	👎	👎	👎	👎	👎	👎	👎	👎	👎	👎	👎	👎
Pneumatic nailer small	0,5-1,5	4-8	👍	👍	👍	👍	👍	👍	👍	👍	👍	👍	👍	👍	👍	👍	👍	👍	👍	👍	👍	👍	👍	👍
Pneumatic nailer medium	1,6-3,5	4-8	👍	👍	👍	👍	👍	👍	👍	👍	👍	👍	👍	👍	👍	👍	👍	👍	👍	👍	👍	👍	👍	👍
Pneumatic nailer big	3,6-5	4-8	👎	👎	👎	👎	👎	👎	👎	👎	👎	👎	👎	👎	👎	👎	👎	👎	👎	👎	👎	👎	👎	👎
Rivet gun	1,2	4-6	👍	👍	👍	👍	👍	👍	👍	👍	👍	👍	👍	👍	👍	👍	👍	👍	👍	👍	👍	👍	👍	👍
Oil scavenging	-	6-8	👍	👍	👍	👍	👍	👍	👍	👍	👍	👍	👍	👍	👍	👍	👍	👍	👍	👍	👍	👍	👍	👍
Ratch screwer	280	6	👎	👎	👎	👎	👎	👎	👎	👎	👎	👎	👎	👎	👎	👎	👎	👎	👎	👎	👎	👎	👎	👎
Inflating gun	-	7	👍	👍	👍	👍	👍	👍	👍	👍	👍	👍	👍	👍	👍	👍	👍	👍	👍	👍	👍	👍	👍	👍
Blast cleaning gun	350	6	👎	👎	👎	👎	👎	👎	👎	👎	👎	👎	👎	👎	👎	👎	👎	👎	👎	👎	👎	👎	👎	👎
Pneumatic clipper	360	6	👎	👎	👎	👎	👎	👎	👎	👎	👎	👎	👎	👎	👎	👎	👎	👎	👎	👎	👎	👎	👎	👎
Airgun	150-400	1-6	👎	👎	👎	👎	👎	👎	👎	👎	👎	👎	👎	👎	👎	👎	👎	👎	👎	👎	👎	👎	👎	👎
Axial grinder	300	6	👎	👎	👎	👎	👎	👎	👎	👎	👎	👎	👎	👎	👎	👎	👎	👎	👎	👎	👎	👎	👎	👎
Keyhole saw	250	6	👎	👎	👎	👎	👎	👎	👎	👎	👎	👎	👎	👎	👎	👎	👎	👎	👎	👎	👎	👎	👎	👎
Impact wrench	280	6	👎	👎	👎	👎	👎	👎	👎	👎	👎	👎	👎	👎	👎	👎	👎	👎	👎	👎	👎	👎	👎	👎
Screwdriver	200	6	👎	👎	👎	👎	👎	👎	👎	👎	👎	👎	👎	👎	👎	👎	👎	👎	👎	👎	👎	👎	👎	👎
Spod weld milling machine	100	6	👍	👍	👍	👍	👍	👍	👍	👍	👍	👍	👍	👍	👍	👍	👍	👍	👍	👍	👍	👍	👍	👍
Grinder	300	6-8	👎	👎	👎	👎	👎	👎	👎	👎	👎	👎	👎	👎	👎	👎	👎	👎	👎	👎	👎	👎	👎	👎
Unicutter	370	6-8	👎	👎	👎	👎	👎	👎	👎	👎	👎	👎	👎	👎	👎	👎	👎	👎	👎	👎	👎	👎	👎	👎
Undersurface gun	210	2-6	👎	👎	👎	👎	👎	👎	👎	👎	👎	👎	👎	👎	👎	👎	👎	👎	👎	👎	👎	👎	👎	👎
Cleaning gun	400-500	5-9	👎	👎	👎	👎	👎	👎	👎	👎	👎	👎	👎	👎	👎	👎	👎	👎	👎	👎	👎	👎	👎	👎
Angle grinder	400-500	6-8	👎	👎	👎	👎	👎	👎	👎	👎	👎	👎	👎	👎	👎	👎	👎	👎	👎	👎	👎	👎	👎	👎



suitable



limited suitable



unsuitable



Fill Station PKT-TWINTec 400

Fill Station for refilling of all PREBENA compressed air cylinders and compressor for all pneumatic devices up to 10 bar

Technical specification:

Motor: 230 V / 2200 W

Horse power: 3

No. of revolutions: 2.760 RPM

Max. operating pressure: 330 bar

Max. working pressure: 10 bar

Effective output: 100 l./min.

Weight: 67 kg

LxWxH: 800 x 575 x 570 mm

Fast refilling of PREBENA compressed air cylinders, compressed air cylinder = compressor tank, automatic condensate drain, automatic switch-off, automatic restart, solid tubular frame, operation-hour counter, type-examination tested safety relief valve, fully automatic filling valve for filling of 1 or 2 cylinders, folding bow-shaped handle, solid rubber wheels, pressure reducer, regulated compressed air outlet, manometer for filling- and outlet pressure, motor protection switch, no TÜV (Technical approval) certification required

Suitable for all PREBENA compressed air cylinders: KT-1000, KT-3500, KT-300, KT-470, KT-690 and KT-900



Adapter for the refilling of compressed air cylinders KT-1000 as an accessory available.



Fill Station for all PREBENA compressed air cylinders



Compressor for all pneumatic devices up to 10 bar

AEROTAINER 245

Compressor in systainer with 2 liter tank

Motor: 230 V / 1500 W

Horse power: 2

No. of revolutions: 2800 RPM

Inlet power: 200 l/min.

Effective output: 100 l/min

Max. operating pressure: 8 bar

Tank: 2 l

Weight: 23,5 kg

LxWxH: 395 x 295 x 320 mm

Unregulated pressure exit, regulated pressure exit with pressure reducer and gauge, 2 l tank with drain tap incl. dewatering tube, gauge for tank pressure, motor protection switch

Suitable for transport, stackable, reduced noise, protection against dust, dirt and damage



VITAS 100-AKKU

Light and powerful battery-compressor for mobile use - with brushless motor

Technical details:

Battery voltage: 18 V

No of revolutions: 2760 RPM

Inlet power: 100 l/min.

Effective outlet: 72 l/min.

max. pressure: 8 bar

Tank: 5 l

Weight: 9,9 kg

LxWxH: 340 x 315 x 380 mm

- Gauge for tank pressure
- Gauge for pressure exit
- Pressure reducer with gauge
- Regulated compressed air connection
- Vulcanised rubber feet
- Rubber grip handle
- Running time with one AKKU18-5.5-LIHD: approx. 60 minutes

Oil-free

- no oil-change
- no oil in condensed water

Second battery directly at the compressor can be deposited to continue working without Interruption.



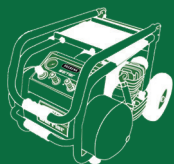

COMPRESSORS

VITAS 45

Motor: 230 V / 250 W
Horse power: 0.3
No. of revolutions: 2840 RPM
Inlet power: 41 l/min.
Effective output: 24 l/min
Max. operating pressure: 10 bar
Tank: 4 l
Weight: 10 kg
LxWxH: 370 x 310 x 300 mm

Protected fittings, easy for transport, gauge for tank pressure, gauge for pressure exit, pressure reducer, regulated pressure exit, vulcanised rubber feet for stable position, handle grip with anti-slip coating

Oil-free: no oil-change - no oil in condensed water



VIGON 120



Motor: 230 V / 1100 W
Horse power: 1.5
No. of revolutions: 2850 RPM
Inlet power: 120 l/min.
Effective output: 85 l/min
Max. operating pressure: 8 bar
Tank: 12 l
Weight: 18 kg
LxWxH: 510 x 240 x 480 mm

Gauge for tank pressure, pressure reducer with gauge, quality pressure switch, rubberized handle grip, vulcanised rubber feet for stable position

VIGON 240

Motor: 230 V / 1500 W
Horse power: 2
No. of revolutions: 2850 RPM
Inlet power: 240 l/min.
Effective output: 160 l/min
Max. operating pressure: 8 bar
Tank: 24 l
Weight: 26 kg
LxWxH: 600 x 340 x 570 mm

Gauge for tank pressure, pressure reducer with gauge, quality pressure switch, rubberized handle grip, strong tires



VIGON 300



Motor: 230 V / 1800 W
Horse power: 2.5
No. of revolutions: 2850 RPM
Inlet power: 300 l/min.
Effective output: 190 l/min
Max. operating pressure: 8 bar
Tank: 50 l
Weight: 35 kg
LxWxH: 750 x 400 x 700 mm

Gauge for tank pressure, pressure reducer with gauge, quality pressure switch, rubberized handle grip, solid rubber tires

PIONEER 260

Motor: 230 V / 1800 W
Horse power: 2.5
No. of revolutions: 2800 RPM
Inlet power: 260 l/min.
Effective output: 140 l/min
Max. operating pressure: 10 bar
Tank: 20 l
Weight: 32 kg
LxWxH: 480 x 400 x 780 mm

Filter pressure reducer with drain valve and gauge, gauge for tank pressure, quality pressure switch with pressure relief valve, tank drying with ball valve, concise instruments, 5 m electric cable with holder, rubberized handle grip, vulcanised double rubber feet, strong tires, suitable for transport, motor safety device



PIONEER 345

Motor: 230 V / 1800 W
Horse power: 2.5
No. of revolutions: 1450 RPM
Inlet power: 300 l/min.
Effective output: 200 l/min
Max. operating pressure: 10 bar
Tank: 20 l
Weight: 45 kg
LxWxH: 480 x 420 x 780 mm

Filter pressure reducer with drain valve and gauge, gauge for tank pressure, quality pressure switch with pressure relief valve, tank drying with ball valve, concise instruments, 5 m electric cable with holder, rubberized handle grip, vulcanised double rubber feet, strong tires, suitable for transport, motor safety device



WARRIOR 255

Motor: 230 V / 1840 W
Horse power: 2.5
No. of revolutions: 2840 RPM
Inlet power: 256 l/min.
Effective output: 150 l/min
Max. operating pressure: 10 bar
Tank: 20 l
Weight: 45 kg
LxWxH: 770 x 530 x 580 mm

Holder for PREBENA Air-hose-reel, foldable handle, user-friendly operator panel, pressure reducer with gauge, protected fittings ideal for construction side, gauge for pressure exit, two regulated compressed air connections, high class coupling, pressure switch with pressure relief valve, user-friendly tank drain cock, rubberized handle grip, additional handle for transport, 10 m electric cable with holder, solid rubber tires, motor safety device, suitable for crane ride



WARRIOR 435

Motor: 230 V / 2200 W
Horse power: 3
No. of revolutions: 2840 RPM
Inlet power: 433 l/min.
Effective output: 210 l/min
Max. operating pressure: 10 bar
Tank: 25 l
Weight: 58 kg
LxWxH: 790 x 630 x 580 mm

Holder for PREBENA Air-hose-reel, foldable handle, user-friendly operator panel, pressure reducer with gauge, protected fittings ideal for construction side, gauge for pressure exit, two regulated compressed air connections, high class coupling, pressure switch with pressure relief valve, user-friendly tank drain cock, rubberized handle grip, additional handle for transport, 10 m electric cable with holder, solid rubber tires, motor safety device, suitable for crane ride



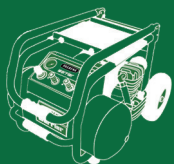

COMPRESSORS

WARRIOR 460

Motor: 230 V / 2200 W
Horse power: 3
No of revolutions: 1180 RPM
Inlet power: 460 l/min.
Effective output: 300 l/min.
Max. pressure: 10 bar
Tank: 23 l
Weight: 75 kg
LxWxH: 850 x 650 x 735 cm



Holder for 2 PREBENA air-hose-reel, double depressurisation, solid and robust frame, suitable for crane ride, protected fittings, 2 cylinder compactor, V-belt drive, foldable handle, solid rubber feet, quality pressure switch, motor protecting switch, 5 m electric cable with holder 2 pressure regulator, tank drying with ball valve, pneumatic tires

AIR HOSE REEL



30 m (118 in.) polyurethane hose 8 x 12 mm with turnable coupling, male nipple and hose guide, very good air flow, independent of temperature

Weight: 7,2 kg
Width: 25 cm
Height: 35 cm
Depth: 33 cm

sturdy metall base 360° rotatable, foldable handle for secured roll up and unroll, high quality 30 m x 8 mm, high pressure hose, max. working pressure 15 bar, connecting hose 1 m

Order-Nr. Z180.00

ORKAN 260

Motor: 230 V / 1800 W
Horse power: 2.5
No. of revolutions: 2800 RPM
Inlet power: 260 l/min.
Effective output: 140 l/min
Max. operating pressure: 10 bar
Tank: 24 l
Weight: 29 kg
LxWxH: 600 x 330 x 630 mm

Filter pressure reducer with drain valve and gauge, gauge for tank pressure, quality pressure switch with pressure relief valve, tank drying with ball valve, 5 m electric cable with holder, rubberized handle grip, vulcanised double rubber feet, strong tires, motor safety device



TWINMAX 420



Motor: 230 V / 2200 W
Horse Power: 3
No. of revolutions: 1500 RPM
Inlet power: 350 l/min.
Effective outlet: 210 l/min.
max. pressure: 10 bar
Tank: 50 l
Weight: 52 kg
LxWxH: 1000 x 390 x 760 mm

Power on time 75%, EN/VDE tested connection cable 220 Volt H07RN-F - length 5 m, big fan impeller for efficient cooling, quality pressure relief valve, gauge for tank and outlet pressure, pressure reducer with quick coupling, tank drying with ball valve, safety valve, motor protection switch, metal belt guard, rubber grip handle, low vibration, solid rubber tires, anti-vibration rubber feet

TWINSTAR 470

Motor: 230 V / 2200 W
Horse power: 3
No. of revolutions: 1000 RPM
Inlet power: 415 l/min.
Effective output: 280 l/min
Max. operating pressure: 10 bar
Tank: 50 l
Weight: 69 kg
LxWxH: 1050 x 400 x 830 mm

Power on time 75%, EN/VDE tested connection cable 220 Volt H07RN-F - length 5 m, big fan impeller for efficient cooling, quality pressure relief valve, gauge for tank and outlet pressure, pressure reducer with quick coupling, tank drying with ball valve, safety valve, motor protection switch, metal belt guard, rubber grip handle, solid rubber tires, low vibration



TWINSTAR 670

Motor: 400 V-3 ph / 4000 W
Horse power: 5.4
No. of revolutions: 1270 RPM
Inlet power: 600 l/min.
Effective output: 450 l/min
Max. operating pressure: 10 bar
Tank: 90 l
Weight: 110 kg
LxWxH: 1180 x 500 x 1100 mm

Power on time 75%, EN/VDE tested connection cable 220 Volt H07RN-F - length 3 m, 400V 3-Phase electrical plug with phase selector (16A), big fan impeller for efficient cooling, quality pressure relief valve, gauge for tank and outlet pressure, pressure reducer with quick coupling, tank drying with ball valve, safety valve, motor protection switch, metal belt guard, rubber grip handle, lockable castors, solid rubber tires, low vibration



TWINSTAR 860-15

Motor: 400 V-3 ph / 4000 W
Horse power: 5.4
No. of revolutions: 1270 RPM
Inlet power: 600 l/min.
Effective output: 420 l/min
Max. operating pressure: 15 bar
Tank: 90 l
Weight: 110 kg
LxWxH: 1180 x 500 x 1100 mm

Power on time 75%, EN/VDE tested connection cable 220 Volt H07RN-F - length 3 m, 400V 3-Phase electrical plug with phase selector (16A), big fan impeller for efficient cooling, quality pressure relief valve, gauge for tank and outlet pressure, pressure reducer with quick coupling, tank drying with ball valve, safety valve, motor protection switch, metal belt guard, rubber grip handle, lockable castors, solid rubber tires, low vibration



TWINSTAR 970

Motor: 400 V-3 ph / 5500 W
Horse power: 7.5
No. of revolutions: 980 RPM
Suction capacity: 950 l/min.
Effective air delivery: 620 l/min
Max. operating pressure: 10 bar
Tank: 90 l
Weight: 114 kg
Measurements LxWxH: 1180 x 500 x 1100 mm

Power on time 75%, EN/VDE tested connection cable 220 Volt H07RN-F - length 3 m, 400V 3-Phase electrical plug with phase selector (16A), big fan impeller for efficient cooling, quality pressure relief valve, gauge for tank and outlet pressure, pressure reducer with quick coupling, tank drying with ball valve, safety valve, motor protection switch, metal belt guard, rubber grip handle, lockable castors, solid rubber tires, low vibration



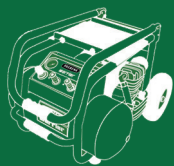

COMPRESSORS

MOUNTAINE 670 / MOUNTAINE 1450

Stationary compressor system with V-belt drive

MOUNTAINE 670

Motor: 400 V-3 ph / 4000 W
Horse power: 5.4
No. of revolutions: 1270 RPM
Inlet power: 600 l/min.
Effective output: 450 l/min
Max. operating pressure: 10 bar
Tank: 270 l
Weight: 145 kg
LxWxH: 600 x 650 x 1760 mm

- 400V-3 Phase electrical plug with phase selector 16A

MOUNTAINE 1450

Motor: 400 V-3 ph / 7500 W
Horse power: 10
No. of revolutions: 1260 RPM
Inlet power: 1070 l/min.
Effective output: 830 l/min
Max. operating pressure: 10 bar
Tank: 270 l
Weight: 155 kg
LxWxH: 600 x 700 x 1760 mm

- Star delta switch
- Electromagnetic pressure relief valve
- 400V-3 Phase electrical plug with phase selector 32A

Power on time 75%, big fan impeller for efficient cooling, EN/VDE tested connection cable, quality pressure relief valve, motor protection, air connection with ball globe joint, tank drying with ball valve, gauge for tank pressure, pressure reducer with quick coupling, safety valve, metal belt guard, low vibration



ORKAN 670

Stationary compressor system with V-belt drive

Motor: 400 V-3 ph / 4000 W
Horse power: 5.5
No. of revolutions: 1270 RPM
Inlet power: 600 l/min.
Effective output: 450 l/min
Max. operating pressure: 10 bar
Tank: 270 l
Weight: 145 kg
LxWxH: 1800 x 600 x 1150

- 400V-3 Phase electrical plug with phase selector 16A

Power on time 75%, big fan impeller for efficient cooling, EN/VDE tested connection cable, quality pressure relief valve, motor protection, air connection with ball globe joint, tank drying with ball valve, gauge for tank pressure, pressure reducer with quick coupling, safety valve, metal belt guard, low vibration



Stationary Screw Compressor System SK 7,5-10

High power compressor system for non-stop-use

Motor: 400 V-3 ph / 7500 W
 Horse Power: 10
 No. of revolutions: 5790 RPM
 Effective output: 1000 l/min.
 Max. pressure: 10 bar
 Tank: 270 l
 Weight: 325 kg
 LxWxB: 1300 x 680 x 1585 mm

- Maintenance free Siemens IE3 motor
- Compactor "Made in Germany"
- Long service interval

Acoustic housing, pressure tank, condensate drain ball valve, programmable computer, LED-Display, emergency shut-down switch, star-delta starting, gauge for tank pressure, temperature monitoring, minimum pressure valve, electromagnetic intake regulator, 400 V/3ph electrical plug with phase selector, oil pre-separation, oil separator, oil filter, earth strap, large area honeycomb radiator



Stationary Screw Compressor System SK 15-10

High power compressor system for non-stop-use

Motor: 400 V-3 ph / 15000 W
 Horse Power: 20
 No. of revolutions: 6060 RPM
 Effective output: 1900 l/min.
 Max. pressure: 10 bar
 Tank: 500 l
 Weight: 490 kg
 LxWxB: 2015 x 680 x 1585 mm

- Maintenance free Siemens IE3 motor
- Compactor "Made in Germany"
- Long service interval

Acoustic housing, pressure tank, condensate drain ball valve, programmable computer, LED-Display, emergency shut-down switch, star-delta starting, gauge for tank pressure, temperature monitoring, minimum pressure valve, electromagnetic intake regulator, 400 V/3ph electrical plug with phase selector, oil pre-separation, oil separator, oil filter, earth strap, large area honeycomb radiator



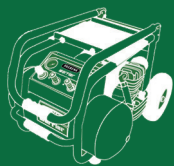

COMPRESSORS

Pneumatic-refrigerant type dryer

Optimal cooling system and ventilation

DKT-700 up to 700 l/min.
Weight: 19 kg - L 320 x W 344 x H 390 mm

DKT-1400 up to 1.400 l/min.
Weight: 29 kg - L 419 x W 368 x H 575 mm

DKT-2300 up to 2.300 l/min.
Weight: 41 kg - L 523 x W 500 x H 570 mm

- automatic condensate drain
- no costly maintenance required

Positioning for application:
Behind the used compressor or in front of a specific target consumer

Longlife, solid steel sheet with powder coating, reliable refrigeration system, environment friendly refrigerant, easy to install (230 V) with plug, automatic adaption to the compressed air system, constant dry compressed air through constant pressure dew point, operation mode display by illuminated on / off switch, function control by point indicator on the control panel



Automatic tank-drain valve

for all compressed air tanks

Time controlled

- preselectable opening times
- ready for connection

Order-No. Z120.25

Niveau controlled

- ready for connection

Order-No. Z120.26



PLUS SYSTEM

for dry and condensate free compressed air

Air conditioning unit up to 700 l/min. with DKT-700

Air conditioning unit up to 1.400 l/min. with DKT-1400

Air conditioning unit up to 2.300 l/min. with DKT-2300

with automatic tank emptying

Equipment:

- pneumatic-refrigerant type dryer
- automatic tank drain
- filter element - fine filter up to 3 µm
- oil water separation system



For connection of stationary compressor systems

Z120.60 Prefilter

Z120.70 Oil water separation system up to 2.000 l compressor power

Z180.95 Connecting-Set DKT-1400/DKT-2300

Z180.96 Bypass

Z180.97 Connecting-Set DKT-700



Z120.60



Z180.96

Plug-in connector and plastic-tubes for pneumatic systems

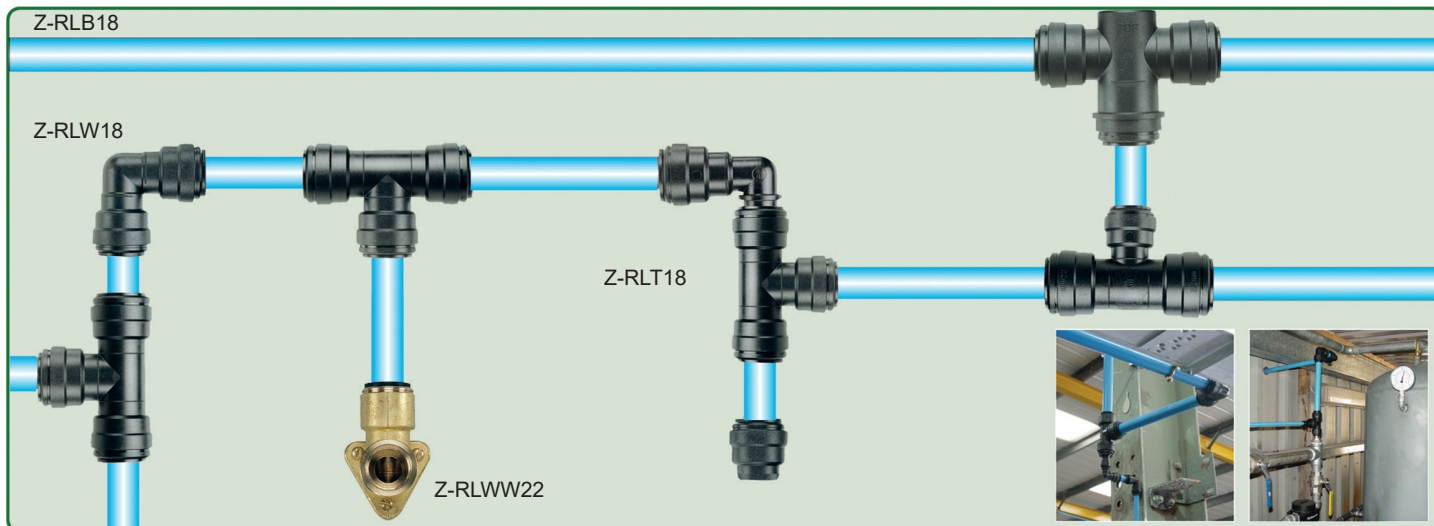

Screw-Connector

Z-RLVB18

Tube outside diameter: Ø 18 mm
Thread: 1/2"

Screw reducing-Connector

Z-RLRV18

Tube outside diameter: Ø 18 mm
Fitting outside diameter: Ø 22 mm

Angle-Connector

Z-RLW18

Tube outside diameter: Ø 18 mm

Closing plug

Z-RLVS18

Fitting outside diameter: Ø 18 mm

Straight-Connector

Z-RLGW18

Tube outside diameter: Ø 18 mm

Tube clip

Z-RLRK18EB

Tube outside diameter: Ø 18 mm

T-Connector

Z-RLT18

Tube outside diameter: Ø 18 mm

Tube clip

Z-RLRK18

Tube outside diameter: Ø 18 mm

Wall angle 90°

Z-RLWW22

for coupling 3/4"

Air distributor aluminium

Z-RLLV3

Inside thread-entrance: 1/2"
Inside thread-exit: 3 x 1/2"

With 3 x 1/2" female thread for insertion screws of adapters, couplings, etc.
For the tube connection is a connector 1/2" Z-RLVB18 needed.

Plastic-tube

Z-RLB18 Tube outside diameter = Ø 18 mm • Tube inside diameter = Ø 14 mm

Poles made of polyamide 12, is particularly pressure and temperature resistant, vibration and impact resistant, corrosion and aging resistant and low weight.

Section thickness = 2 mm • Max. operating pressure = 22 bar

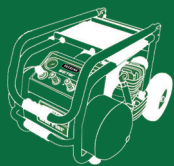

FITTINGS AND ACCESSORIES



Flexi air line 6 x 9 mm

- Stretched length: 7,5 m
- Working length: 4 m
- max. pressure: 13 bar

Order-No. Z160.11



Flexi air line 9 x 12 mm

- Stretched length: 7,5 m
- Working length: 4 m
- max. pressure: 13 bar

Order-No. Z160.12



Flexi air line 6,5 x 10 mm

- Polyurethan-Flexi air line
- with safety coupling
- with steel male nipple
- max pressure: 8 bar

Order-No. Z150.17 = length 6 m
Order-No. Z150.18 = length 8 m



Flexi air line 8 x 12 mm

- Polyurethan-Flexi air line
- with safety coupling
- with steel male nipple
- max pressure: 8 bar

Order-No. Z150.19 = length 6 m
Order-No. Z150.20 = length 8 m



Air hose set 10 m

- High flexible hybrid polymer air hose
- with safety coupling
- 10 x 16 mm
- max. pressure: 12 bar

Order-No. Z200.15



Air hose set 10 m

- max. pressure: 13 bar
- with coupling and male nipple

Order-No. Z200.20 = 9 x 3 mm
Order-No. Z200.25 = 6 x 3 mm



High pressure hose

- Length: 50 m
- max. pressure: 13 bar

Order-No. Z180.81 = 6 x 3 mm
Order-No. Z180.82 = 9 x 3 mm



Factory hose

- High flexible air hose
- Length: 50 m
- max. pressure: 16 bar

Order-No. Z180.93 = 6 mm
Order-No. Z180.94 = 9 mm



Air hose reel

- Length: 12 m PU/PVC-air hose
- max. pressure: 12 bar
- Weight: 5,7 kg
- Temperature: -15° bis + 65°
- with safety coupling
- connecting hose: 1 m

Order-No. Z155.90 = 8 x 12 mm
Order-No. Z155.95 = 10 x 14 mm

- automatic unroll
- hose snap-in with locking catch
- powder-coated steel housing
- rotatable holder 180°



Air hose reel

- 30 m polyurethane hose 8 x 12 mm
- max. working pressure: 13 bar
- Weight: 7,2 kg
- LxWxH: 330 x 350 x 250 mm

- very good air flow
- independent of temperature
- easy for transport
- fast connecting to compressor and pneumatic device

Order-No. Z180.00

- Sturdy metal base 360° rotatable
- turnable coupling and male nipple
- connecting hose 1 m
- foldable handle for secured roll up and unroll



Blow gun

Aluminium blow gun with male nipple

Order-No. Z170.80: 1 pcs

Order-No. Z170.80B: 1 pcs in Blister



Inflating gun

with valve set

Order-No. Z175.80: 1 pcs



Connecting hose

- RF 100 / 200
- for inflating gun

Order-No. Z176.80E



Pneumatic valve set

- 3 parts
- for inflating gun

Order-No. Z176.81E



Blow gun

- with metal nozzle and male nipple
- Nozzle lenght = 110 mm
- max. pressure: 10 bar

Order-No. Z170.85



Blow gun with long metal nozzle

- with long metal nozzle and male nipple
- Nozzle lenght = 330 mm
- max. pressure: 10 bar

Order-No. Z170.90



Air distributor with 2 exits

Order-No. Z140.42E: 1 pcs

Order-No. Z140.42B: 1 pcs in blister



Air distributor with 3 exits

Order-No. Z140.44E: 1 pcs

Order-No. Z140.44B: 1 pcs in blister



Balancer

- Load capacity: 1,0 - 2,0 kg
- Extraction: 160 cm
- Weight: 0,6 kg

Order-No. Z110.31



Balancer

- Load capacity: 2,0 - 4,5 kg
- Extraction: 160 cm
- Weight: 1,9 kg

Order-No. Z110.32

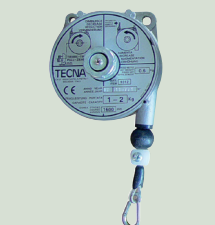

Balancer

- Load capacity: 4,0 - 7,0 kg
- Extraction: 180 cm
- Weight: 2,1 kg

Order-No. Z110.31



Maintenance unit

- with waterseparator, pressure reducer and oil atomizer
- Connection: G 3/8"
- Weight: 1,8 kg

Order-No. Z120.21



Small oiler

- for pneumatic nailer and stapler
- adjustable oil dosage

Order-No. Z200.00



Pressure regulator

- with coupling and male nipple
- Manometer 0 - 12 bar

Order-No. Z200.50

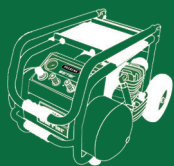

FITTINGS AND ACCESSORIES



Quick connection coupling

male thread 1/4"

Order-No. Z130.31E: 1 pcs
Order-No. Z130.31B: 5 pcs in blister



Quick connection coupling

male thread 3/8"

Order-No. Z130.35E: 1 pcs
Order-No. Z130.35B: 5 pcs in blister



Quick connection coupling

male thread 1/2"

Order-No. Z130.90E: 1 pcs

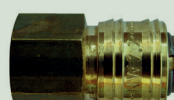

Quick connection coupling

female thread 3/8"

Order-No. Z130.91E: 1 pcs

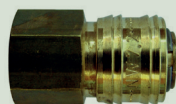

Quick connection coupling

female thread 1/2"

Order-No. Z130.92E: 1 pcs

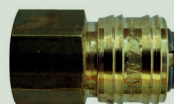

Quick connection coupling

female thread 1/4"

Order-No. Z130.93E: 1 pcs



Quick connection coupling

hose connection 6 mm

Order-No. Z130.43E: 1 pcs
Order-No. Z130.43B: 5 pcs in blister



Quick connection coupling

hose connection 9 mm

Order-No. Z130.44E: 1 pcs
Order-No. Z130.44B: 5 pcs in blister



Male nipple

hose connection 6 mm

Order-No. Z130.47E: 1 pcs
Order-No. Z130.47B: 5 pcs in blister



Male nipple

hose connection 9 mm

Order-No. Z130.48E: 1 pcs
Order-No. Z130.48B: 5 pcs in blister



Male nipple

male thread 1/4"

Order-No. Z130.49E: 1 pcs
Order-No. Z130.49B: 5 pcs in blister



Male nipple

male thread 3/8"

Order-No. Z130.51E: 1 pcs
Order-No. Z130.51B: 5 pcs in blister

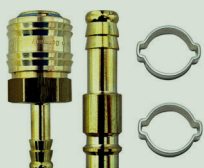

Connection Set 6 mm

- 1 pcs quick connection coupling
- 1 pcs male nipple for hose connection
- 2 pcs hose clamps

Order-No. Z130.60B: 1 set in blister

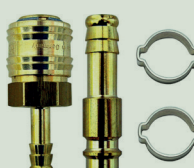

Connection Set 9 mm

- 1 pcs quick connection coupling
- 1 pcs male nipple for hose connection
- 2 pcs hose clamps

Order-No. Z130.61B: 1 set in blister

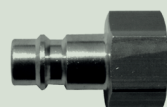

Male nipple

female thread R 1/4"

Order-No. Z130.70E: 1 Stück

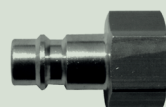

Male nipple

female thread R 3/8"

Order-No. Z130.71E: 1 Stück



Double nipple

thread R 1/4"

Order-No. Z130.72E: 1 Stück



Reducing socket

R 1/4" x 1/2"

Order-No. Z130.72E: 1 Stück



Reducing double nipple

R 1/4" x 3/8"

Order-No. Z130.74E: 1 Stück



Reducing socket

R 1/4" x 3/8"

Order-No. Z130.75E: 1 Stück

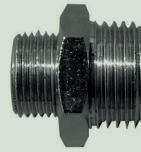

Reducing double nipple

R 3/8" x 1/2"

Order-No. Z130.76E: 1 Stück



Reducing socket

R 3/4" x 1/2"

Order-No. Z130.77E: 1 Stück

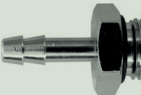

Hose nipple

R 3/8" x 9 mm

Order-No. Z130.87E: 1 Stück



Hose nipple

R 1/4" x 6 mm

Order-No. Z130.88E: 1 Stück



Thread sealing tape

1 roll = 12 m

Order-No. Z190.00E: 1 Stück



Hose clamp 6 mm

Order-No. Z180.84E: 1 pcs

Order-No. Z180.84B: 1 pcs in blister



Hose clamp 9 mm

Order-No. Z180.86E: 1 pcs

Order-No. Z180.86B: 1 pcs in blister



Hose clamp 10 - 16 mm

Order-No. Z180.90: 1 pcs



Special Oil

for PREBENA tools
• 1/2 liter

Order-No. Z200.10



Mineral Oil

for compressors
• 1 liter

Order-No. Z200.40



Synthetik Oil

for compressors
• 1 liter

Order-No. Z200.60



HAMMER TACKER AND HAND TACKER

Application

	HFPPF09	HFUPPF09	HFPPF14	HPPF14	DNPF16	HFVZ10	HPVZ08	HTVX08	HP-JVX16
--	---------	----------	---------	--------	--------	--------	--------	--------	----------

Upholsterer / Interior designer

Upholstery				X	X		X	X	X
Dekoration				X	X		X	X	X
Covering	X	X	X	X	X	X	X	X	X
Tissue	X	X	X	X	X	X	X	X	X
Leather, fell	X	X	X	X	X	X	X	X	X
Foil, cardboard, paper	X	X	X	X	X	X	X	X	X

Interior work / Drywall installation

Skirting, cover strip									X
Decorative molding									X
Panel ceiling									
Profile board									
Window / door									
Glazing bead									
Ceiling lining / wall covering									
Parquet									
Substructure									
Chipboard, OSB									
Gypsum fibre board									
Gypsum plaster board									
Exhibition stand construction	X	X	X	X	X	X	X	X	X
Acoustics	X	X	X	X	X	X	X	X	

Carpenter / Roofer

Roof lath									
Roof boarding									
Outside boarding									
Bottom-cover-boarding									
Visual boarding									
Weather boarding									
Saving foamwork									
Caping and verge boarding									
Flue boarding									
Roof framework									
Substructure									
Framework									
Wooden truss									
Timber frame system									
Dormer									
Wood connector									
Roof cladding									
Valley board									
Inflow sheet									
Roofing felt / bitumen	X	X	X	X	X	X	X	X	X
Insulation									

Packaging

Wooden box									
Pallet									
Palett repair									
Cardboard box									
Cardboard closing									
Cardboard stapling									

Others

Wooden fence									
Wire fence	X	X	X	X	X	X	X	X	X
Small furniture	X	X	X	X	X	X	X	X	X
Furniture back board	X	X	X	X	X	X	X	X	X
Case plinth									
Terrace building									
Garden house									
Carport									
Rack / bridge									
Flowering profile / ornaments									
Picture frame									



Hammer Tacker HFPF09

Staples type PF from 6 - 9 mm

Technical specification:

Weight: 0,9 kg

Measurement LxWxH: 300 x 25 x 50 mm

Back load magazine, sturdy metal housing,
easy grip handle, perfect handling, easy and solid loading system

Applications:

Roofing felt, paper, insulation, weather stripping,
carpet and underlay, linings, waterproof membranes,
poster, canvas, furniture back, upholstery, wire mesh etc.

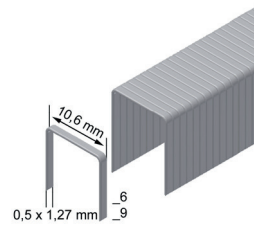

Hammer Tacker HFUPF09

Staples type PF from 6 - 9 mm

Technical specification:

Weight: 0,9 kg

Measurement LxWxH: 290 x 23 x 50 mm

Bottom load magazine, sturdy metal housing,
easy grip handle, perfect handling, easy and solid loading system

Applications:

Roofing felt, paper, insulation, weather stripping,
carpet and underlay, lining, waterproof membrane,
poster, canvas, furniture back, upholstery, wire mesh etc.

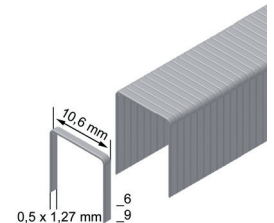

Hammer Tacker Power HFPF01

Hammer Tacker HFPF09 with staples type PF09CNK

In a metal case:

1 pcs. Hammer Tacker HFPF09

12 boxes = 60.000 staples type PF09CNK



Metal
case

Hammer Tacker Power HFPF02

Hammer Tacker HFPF09 with staples type PF09CNK

In a metal case:

2 pcs. Hammer Tacker HFPF09

12 boxes = 60.000 staples type PF09CNK



Metal
case



HAMMER TACKER AND HAND TACKER

Hammer Tacker HFPF14

Staples type PF from 6 - 14 mm

Technical specification:

Weight: 1,0 kg

Measurement LxWxH: 295 x 30 x 85 mm

Bottom load magazine, sturdy metal housing,
easy grip handle, perfect handling, easy and solid loading system

Applications:

Roofing felt, paper, insulation, weather stripping,
carpet and underlay, linings, waterproof membrane,
poster, canvas, furniture backs, upholstery, wire mesh and more

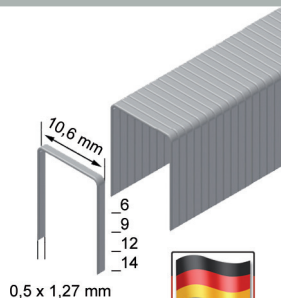

Hand Tacker HPPF14

Staples type PF from 6 - 14 mm

Technical specification:

Weight: 0,85 kg

Measurement LxWxH: 190 x 25 x 155 mm

Sturdy metal housing, easy grip handle,
perfect handling, easy and solid loading systems

Applications:

Roofing felt, paper, insulation, weather stripping,
carpet and underlay, lining, waterproof membrane,
poster, canvas, furniture back, upholstery, wire mesh and more

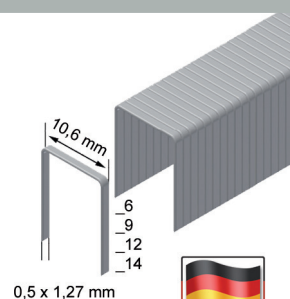

Pneumatic Stapler DNPF16

Staples type PF from 6 - 16 mm

Technical specification:

Weight: 0,75 kg

Operating pressure: approx. 4 - 7 bar

Air requirement: approx. 0,29 l/Nagelung

Measurements: L 230 x W 48 x H 166 mm

Bottom load magazine, no recoil, exhaust silencer,
adjustable exhaust

Applications:

Roofing felt, paper, insulation, weather stripping,
carpet and underlay, lining, waterproof membrane,
poster, canvas, furniture back, upholstery, wire mesh and more

**Punchy alternative
to hand tacker**

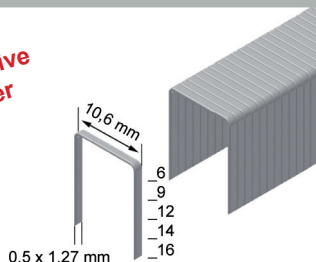

PF-BOX - Staples in plastic bag

PF-BOX

9.000 Staples type PF - galvanized - in plastic bag

2.000 x PF06CNK

5.000 x PF09CNK

2.000 x PF14CNK



Hammer Tacker HFVZ10

Staples type VZ from 6 - 10 mm

Technical specification:

Weight: 0,5 kg

Measurement LxWxH: 285 x 27 x 30 mm

Back load magazine, sturdy metal housing, easy grip handle, perfect handling, easy and solid loading system

Applications:

Roofing felt, paper, insulation, weather stripping, carpet and underlay, lining, waterproof membranes, poster, canvas, furniture back, upholstery, wire mesh and more

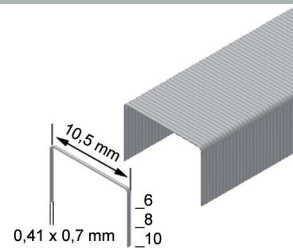

Hand Tacker HPVZ08

Staples type VZ from 6 - 8 mm

Technical specification:

Weight: 0,4 kg

Measurement LxWxH: 155 x 20 x 75 mm

Sturdy metal housing, easy grip handle, perfect handling, easy and solid loading system, adjustable impact power

Applications:

Roofing felt, paper, insulation, weather stripping, carpet and underlay, lining, waterproof membrane, poster, canvas, furniture back, upholstery, wire mesh and more

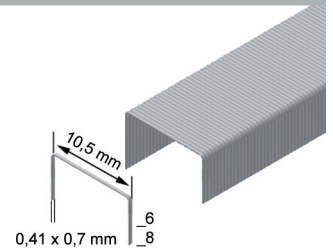

Hand Tacker HTVX08

Staples type VX from 6 - 8 mm

Technical specification:

Weight: 0,25 kg

Measurement LxWxH: 155 x 20 x 90 mm

Sturdy metal housing, easy grip handle, perfect handling, easy and solid loading system

Applications:

Roofing felt, paper, insulation, weather stripping, carpet and underlay, lining, waterproof membrane, poster, canvas, furniture back, upholstery, wire mesh and more

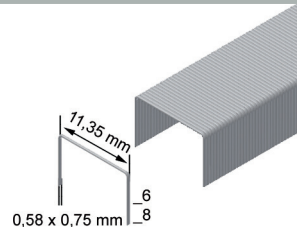

Hand Tacker HP-J/VX16

Staples type VX from 6 - 16 mm and brads type J 16mm

Technical specification:

Weight: 0,6 kg

Measurement LxWxH: 179 x 35 x 150 mm

Durable aluminium housing, ergonomic handle, inspection glass for staple level, adjustable impact power, easy and solid loading systems

Applications:

Roofing felt, paper, insulation, weather stripping, carpet and underlay, lining, waterproof membrane, poster, canvas, furniture back, upholstery, wire mesh, decorative moulding, skirting board, etc.

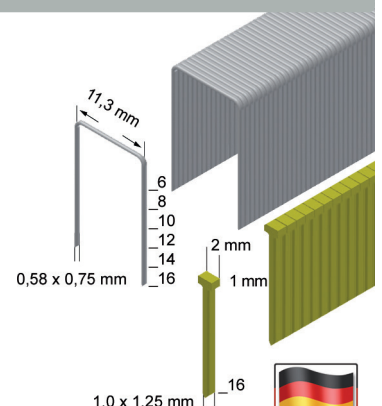



PREBENA Wilfried Bornemann GmbH & Co. KG
Seestraße 20-26
D-63679 Schotten - GERMANY

☎ +49 60 44 96 01 - 0
☎ +49 60 44 96 01 - 820

info@prebena.com
www.prebena.com



You will always find
our new products!

