

Original operating instructions for the
path-controlled tacker

GB

SLIDER 7F-CNW90



Foreword

These operating instructions will help you to operate the Slider 7F-CNW90 path-controlled tacker

- correctly in accordance with its intended use,
- safely, and
- cost-effectively.

This tool is referred to simply as a Slider in these operating instructions.

We assume that every person using the Slider has knowledge of how to handle pneumatic tools. People who do not have this knowledge must be instructed by an experienced user about how to operate the Slider.

These operating instructions are intended for the following persons:

- Persons who operate this Slider
- Persons who clean this Slider, and/or
- Persons who dispose of this Slider.

All of these persons must have read and understood the contents of these operating instructions.

These operating instructions are considered a part of the product. Always keep them near the Slider. Pass on the operating instructions if you sell the Slider or hand it on in any other manner.

Table of contents

Foreword.....	2
Table of contents	3
Layout characteristics.....	4
General layout characteristics	4
Features of the danger warnings	4
Features of the notices on damage to property or the environment	4
Safety	5
Correct use	5
Improper use.....	5
Avoiding the risk of fatal injuries	5
Avoiding the risk of explosion	5
Avoiding the risk of injury.....	6
Avoiding damage to the tacker	6
Description	7
Tool overview and scope of delivery	7
Tool overview and scope of delivery	8
How it works.....	8
Product features	9
Safety devices.....	9
Information signs on the Slider	10
Information on the rating plate	10
Preparing the Slider.....	11
Unpacking the Slider.....	11
Checking the condition	11
Connecting the Slider to the compressed air supply	12
Filling the magazine	13
Adjusting the exhaust outlet.....	15
Checking the function	15
Operating the Slider	16
Using the parallel guide or guide sight slot.....	16
Selecting the nail distance	17
Adjusting the driving depth	17
Checking the driving depth	19
Driving in fasteners	19
After operation	21
Disconnecting the compressed air supply	21
Emptying the magazine	21
Transporting and storing the Slider	22
Packing	22
Transporting.....	22
Storage	23
Servicing the Slider	24
One-off service after 25 hours of operation	24
Cleaning the housing and external surfaces	24
Oiling the Slider	25
Service intervals	25
Faults.....	26
Faults	26
Overview of faults	26
Ordering accessories	27
Ordering fasteners	27
Please specify further details in the order (e.g. –BK; –BKRI or –RFRILI)	27
Ordering other accessories.....	27
Disposing of the Slider.....	27
Manufacturer's address	28
Warranty	29
Index.....	30

Layout characteristics

General layout characteristics

Various elements in the operating instructions are marked with specific layout characteristics. They make it easy for you to see whether you are reading

normal text,

- lists or
- actions.



Tips contain additional information such as specific information on the cost-effective use of the Slider.

Features of the danger warnings

All danger warnings in these operating instructions are based on the same pattern. On the left you will find a symbol indicating the type of danger. To the right of that you will see a signal word which identifies the severity of the danger. Below this, you will see a description of the source of the danger and information on how you can avoid this danger.



DANGER

Notices with the word DANGER indicate hazards which can directly lead to serious or even fatal injuries.



WARNING

Notices with the word WARNING indicate hazards that can potentially lead to serious or even fatal injuries.



CAUTION

Notices with the word CAUTION indicate hazards that can lead to minor or moderate injuries.

Features of the notices on damage to property or the environment

ATTENTION!

These notices indicate hazards that can lead to damage to property or the environment.

Safety

Observe and follow all the warnings and instructions in these operating instructions and those on the Slider when using the Slider. The enclosed spare parts list and declaration of conformity are an integral part of these operating instructions.

Correct use

The Slider 7F-CNW90 path-controlled tacker is used to drive fasteners into panel-shaped building materials such as wooden panels, gypsum fibreboard and OSB boards in order to fit them to wooden frames. Sliders may only be used on other materials after consultation with the manufacturer.

Correct use also includes complying with the health and safety regulations, legal regulations and/or standards applicable at the site of use. Any other use is not deemed correct use and may result in damage to property or even personal injury.

Improper use

Improper use refers, in particular, to operation

- by persons without any knowledge of how to use the Slider,
- of the Slider with its safety devices overridden,
- of Sliders modified without the authorisation of the manufacturer,
- with accessories other than those stipulated in these operating instructions,
- connected to compressed air sources not listed in these operating instructions,
- when the work involves movements across scaffolding, stairs, ladders or ladder-type structures,
- involving closing boxes or crates or attaching transport securing equipment.

PREBENA Wilfried Bornemann GmbH & Co. KG accepts no liability for any damage resulting from improper use.

Avoiding the risk of fatal injuries

- ▶ During the triggering sequence and whenever the Slider is connected to the air supply, ensure that no body parts are near the opening.
- ▶ Ensure that the fasteners are not driven into power cables.
- ▶ Never direct the Slider at people, animals or their body parts.
- ▶ Disconnect the tacker from the compressed air supply before handing it over to other persons.
- ▶ Do not allow children to play with packaging films – these pose a risk of suffocation.

Avoiding the risk of explosion

- ▶ Do not use the Slider in potentially explosive areas.
- ▶ Never operate the Slider with oxygen or other explosive gases or gas mixtures.
- ▶ Only operate the Slider on suitable compressed air systems (see page 12).
- ▶ Only use the Slider if it is in perfect working order (see page 11).

Avoiding the risk of injury

- ▶ Wear suitable ear protection when operating the Slider.
- ▶ Wear suitable safety goggles when operating the Slider.
- ▶ Store the tacker out of the reach of children and other unauthorised persons.
- ▶ Disconnect the Slider from the compressed air supply before transportation, before performing any cleaning work, before loading and emptying the magazine and after operation.
- ▶ Always carry the Slider by the handle and never with the trigger activated.
- ▶ Make sure that you and any other persons in the danger area wear suitable protective equipment when operating the Slider.
- ▶ Hold the Slider in a way that eliminates any possibility of injury due to kickback.
- ▶ Only use the tacker if your footing is secure.
- ▶ Only use the Slider if you can guarantee the path you are taking is level.
- ▶ Never trigger the Slider in the open. This avoids the risk of any flying fasteners and of overloading the Slider.
- ▶ Only use fasteners which have been approved by the manufacturer.
- ▶ Take note of the workplace dimensions. The Slider may penetrate thin workpieces or slip off workpieces when working on corners and edges.



WARNING

Risk of injury when operating the Slider at workpiece edges.

- ▶ Ensure that there is enough distance between the opening and the edge of the workpiece.
 - ▶ Ensure that the Slider is in perfect condition.
 - ▶ Ensure that the Slider is guided in a straight line over the workpiece.
 - ▶ Never trigger the Slider in the open. This avoids the risk of any flying fasteners and of overloading the Slider.
-

Avoiding damage to the tacker

- ▶ Never open the Slider housing. Always have repair work carried out by qualified PREBENA staff.
- ▶ Do not use the Slider if it has been dropped or is damaged. Have it inspected by qualified PREBENA staff before putting it into use again.
- ▶ Do not connect the Slider to a compressed air supply where the maximum operating pressure of 8.3 bar is exceeded.
- ▶ Position the Slider so that it cannot tip over during operation.
- ▶ Never trigger the Slider in the open. This avoids the risk of any flying fasteners and of overloading the Slider.
- ▶ Only use fasteners which have been approved by the manufacturer.

Description

Tool overview and scope of delivery

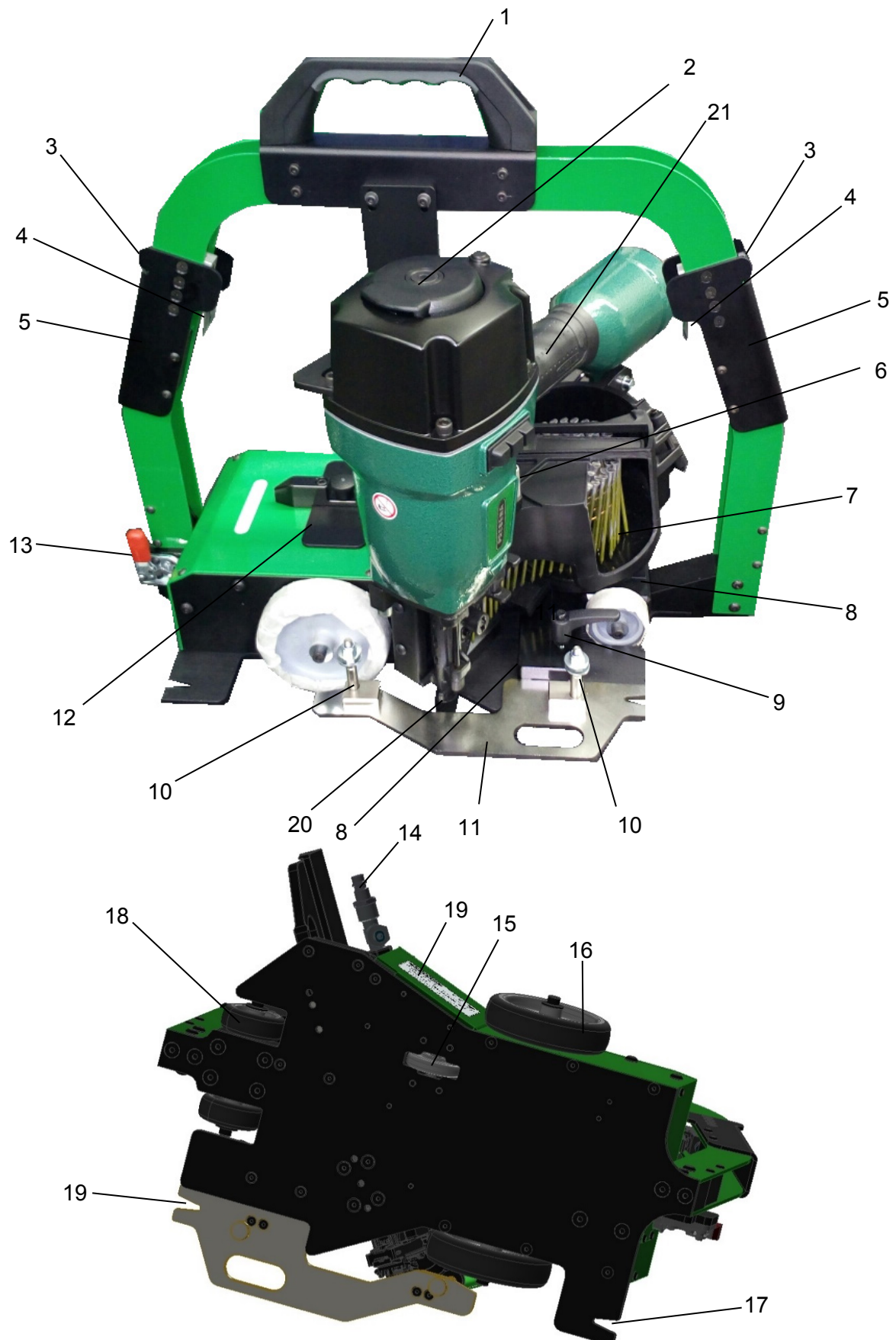

Tool overview and scope of delivery

No.	Explanation
1	Carrying handle
2	360° adjustable exhaust outlet
3	Trigger button for single shot
4	Continuous operation trigger lever with path control
5	Handle
6	Release cylinder
7	Magazine
8	Spacer plates for depth control
9	Clamping lever for parallel guide
10	Guide pin for parallel guide
11	Parallel guide
12	Adjusting slider for staple distances of 40, 60, 80 and 110 mm
13	Coupling
14	Compressed air connection, DN 7.2
15	Safety castor
16	Large wheel
17	Guide sight slot (V-notch sight)
18	Small wheel
19	Rating plate
20	Opening (30° to direction of travel according to EC 5)
21	Tacker (7F-CNW90)
-	Rule for parallel guide
-	Operating instructions
-	Spare parts list
-	EC Declaration of Conformity
-	Spacer plates (x6) t = 1 mm
-	Allen key – 3; 4 and 5 mm

How it works

The Slider is a special tool for optimum guidance of pneumatic tackers. It makes working quicker, more comfortable and accurate. The tacker integrated into the Slider can be moved over the entire surface to be worked on, e.g. plasterboard, gypsum fibreboard or other wood-based panels, without a great deal of effort. The Slider can be automatically triggered at any time with a single shot for fixing panels or path-controlled in four easily adjustable nail distances of 40 mm, 60 mm, 80 mm or 110 mm. The Slider comprises two trigger levers on both of the handles at the side of the tool (each with a trigger button for single shot and a continuous operation trigger lever), which also makes it suitable for two-man operation. A guide sight slot (V-notch sight) on both sides and an adjustable parallel guide with a rule up to 140 mm enable the operator to aim easily and keep on track. As standard, the tool comes with an adjustable exhaust hood and a safety castor on the bottom of the tool which keeps it away from the material prior to triggering. A carrying handle makes it easy to transport. No electrical connection is required since the Slider is only controlled pneumatically or mechanically.

Product features

The Slider has the following features:

- Single shot possible at any time
- Can be used in both directions
- Path-controlled continuous triggering
- Distance adjustment mechanism for 40, 60, 80 or 110 mm
- Guide sight slot (V-notch sight)
- Adjustable parallel guide
- Trigger lock
- Depth control via spacer plates
- No run marks due to wheels
- Adjustable exhaust

Safety devices

Contact castor

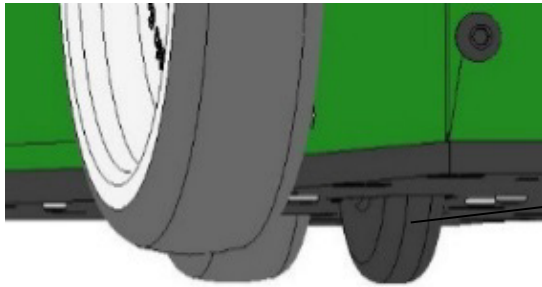

The Slider is equipped with a safety castor (17) underneath which only allows triggering when the tool is set down.



WARNING

Risk of injury when operating the Slider at workpiece edges.

- ▶ Never trigger the Slider in the open. This avoids the risk of any flying fasteners and of overloading the Slider.
- ▶ Ensure that the opening is over the workpiece before triggering.

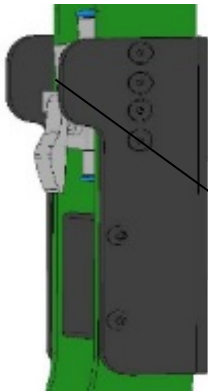

Trigger lever

The Slider only triggers when the trigger lever (4) is actuated (with the exception of the single shot function). These levers are located on the left-hand and right-hand side of the handle.









DANGER

THE SLIDER IS FITTED WITH SAFETY DEVICES. THESE MUST NEVER BE DEACTIVATED!

Information signs on the Slider

Next to the rating plate, there are five pictograms affixed to the Slider. These have the following meanings:

Label	Meaning	Label	Meaning
	Wear suitable ear protection		Wear suitable eye protection
	Observe the operating instructions	40 60 80 110	Staple distances
	Observe the operating instructions		Made in Germany
	<p>The following uses are not permitted:</p> <ul style="list-style-type: none"> Work requiring movements across scaffolding, stairs, ladders or ladder-type structures and work involving closing boxes or crates or attaching transport securing equipment. <p>The corresponding warning symbol is adhered to the front of the tacker.</p>		

Information on the rating plate

The rating plate is adhered to the Slider housing. It contains the following information:

Slider rating plate

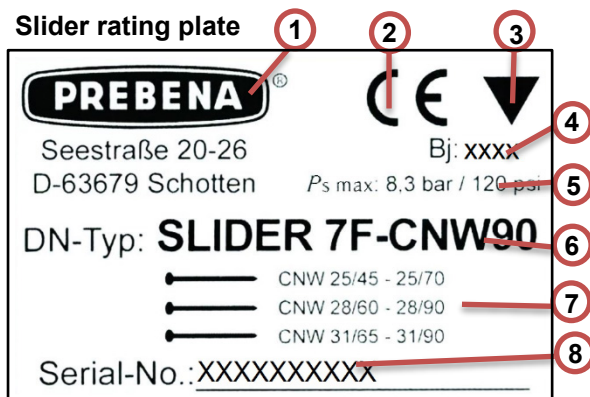

No.	Explanation
1	Manufacturer
2	CE mark
3	Trigger lock marking
4	Year of manufacture
5	Max. permissible operating pressure
6	Tool type
7	Type and length of fasteners used
8	Serial number

Preparing the Slider

Unpacking the Slider

- ▶ Place the packaging upright before opening it.
- ▶ Open the lid of the packaging.
- ▶ Carefully lift the Slider out of the packaging using the handle and place it down in an upright position.
- ▶ Remove all packaging material from the Slider.



WARNING

Children who play with packaging films are at risk of suffocation.

- ▶ Do not allow children to play with packaging films.
- ▶ Keep packaging materials out of the reach of children.

- ▶ Save the packaging material for later use.

Checking the condition



WARNING

There is a risk of injury when operating a damaged Slider or if the accessories are not correctly attached.

- ▶ Check the condition of the Slider before each use.
- ▶ Ensure that the Slider is in perfect condition.

- ▶ Check the following points in particular:
 - Are all parts of the Slider and all accessory parts securely attached?
 - Are the safety devices free from any damage?
 - Are all accessible screwed connections tight?
 - Is the compressed air connection free from damage?
 - Are the control elements free from any damage?
 - Are the hose connections free from any damage?



Scratches on the housing paint do not constitute damage.

- ▶ Do not connect a damaged Slider to the compressed air supply.
- ▶ Have a damaged Slider repaired by qualified PREBENA staff before putting it into operation.



CAUTION

Damaged hose connections can burst and cause injury or damage to property.

- ▶ Check the hose connections for damage before connecting them.

Connecting the Slider to the compressed air supply

You can connect the Slider to a compressor or a compressed air system.

Operation with a compressor or a compressed air system is only permitted if the following preconditions are met:

- The operating pressure of the compressor or compressed air system must not be more than 10% above the maximum operating pressure of the Slider. You can find information on the maximum operating pressure of the Slider on the rating plate.
- On compressed air systems with higher pressure, a pressure regulating valve (pressure reducer) with a downstream pressure relief valve must be installed in the compressed air line.
- The compressed air must be filtered, dry and lubricated with PREBENA special nailer oil.
- At the outlets for the compressed air line to the Slider, a compressed air maintenance unit must be installed on the coupling side. It should contain
 - a filter,
 - a water separator and
 - an oiler.
- If no oiler is installed, the length of the air line to the tacker must not exceed 10 m. Otherwise, three to five drops of PREBENA special nailer oil must be filled directly into the air inlet of the Slider every day prior to operation.
- The compressed air system must be able to maintain the operating pressure even during the required air removal.
- The inner diameter of the air line must be at least 9 mm.
- The connection for the Slider must be equipped with a quick-action coupling, ID 7.2, and have an inner diameter of at least 7.5 mm.



CAUTION

Operation on compressed air systems that do not meet the above-mentioned preconditions can lead to damage to the Slider.

- ▶ Only operate the Slider on suitable compressed air systems.
- ▶ Only use the Slider if it is in perfect working order.

- ▶ Check the condition of the Slider (see page 11).
- ▶ Check the connection for the compressed air hose for foreign matter and contamination and clean it if necessary.
- ▶ Set the operating pressure at the pressure regulator of the compressor to 6.0 – 8.3 bar.



WARNING

Accidental triggering when connecting to the compressed air supply can lead to serious or even fatal injuries.

- ▶ Ensure that no body parts are near the opening.
- ▶ Never direct the Slider at people, animals or their body parts.
- ▶ Empty the magazine prior to connection.



CAUTION

Damaged hose lines can burst and cause injury.

- ▶ Check the compressed air system and the Slider for damage before connecting them.
- ▶ Only connect the Slider to a functioning compressed air system.

ATTENTION

Damaged hose lines can burst and cause damage to property due to compressed air escaping.

- ▶ Check the compressed air system and the Slider for damage before connecting them.
- ▶ Only connect the Slider to a functioning compressed air system.

- ▶ Push the quick coupler (1) of the compressed air hose onto the connection (2) until it audibly locks into place.

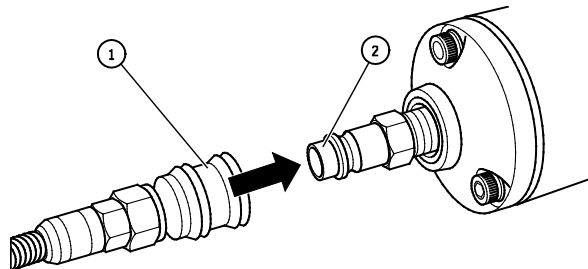

- ▶ Check the operating pressure on the pressure gauge of the compressor.

The maximum permissible operating pressure of the Slider is 8.3 bar.

Filling the magazine**WARNING**

Accidental triggering when filling the magazine can lead to serious or even fatal injuries.

- ▶ Disconnect the Slider from the compressed air supply before inserting the fasteners.
- ▶ Ensure that no body parts are near the opening.
- ▶ Never direct the Slider at people, animals or their body parts.

**CAUTION**

Using the wrong fasteners can lead to injury, impair the proper functioning of the Slider or damage the Slider.

- ▶ Only use the PREBENA fasteners listed in the section on "Ordering accessories" (see page 27 onwards).

Opening the magazine

- ▶ To open the magazine, press the magazine catch (1) downwards in the direction of the arrow.
- ▶ Swing out the magazine lock to the left (2).
- ▶ Switch out the magazine cover to the right (3).

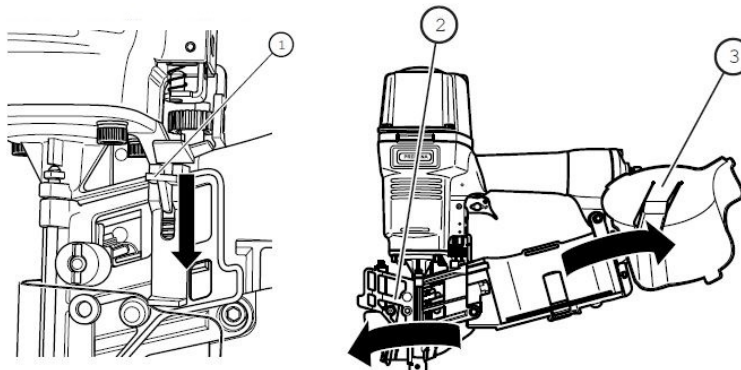

Adjusting the nail length

There are two scales - one in centimetres and the other in inches - on the inside of the magazine. These scales indicate the tacker's selectable nail length.

- ▶ To use longer nails, pull out the magazine shaft (1) to the desired position.
- ▶ To engage the magazine disc (2) in the desired position, turn the magazine shaft (1) clockwise as far as it will go. The magazine disc engages.
- ▶ To use shorter nails, pull out the magazine wave a little.
- ▶ Turn the magazine shaft anticlockwise.
- ▶ Slide the magazine shaft to the desired position.
- ▶ To engage the magazine disc in the desired position, turn the magazine shaft clockwise as far as it will go. The magazine disc engages.

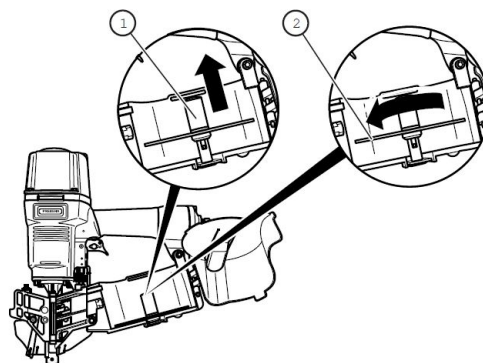

Inserting nails

- ▶ To insert nails in the magazine, place the coil on the magazine shaft. The nail tips must touch the magazine disc here.
- ▶ Roll out the end of the coil until you can place the first nail in the guide (1).
- ▶ Place the first nail (2) in the guide.
- ▶ Make sure the nails rest flat on the guide rail.
- ▶ Bend the coil a little if necessary.

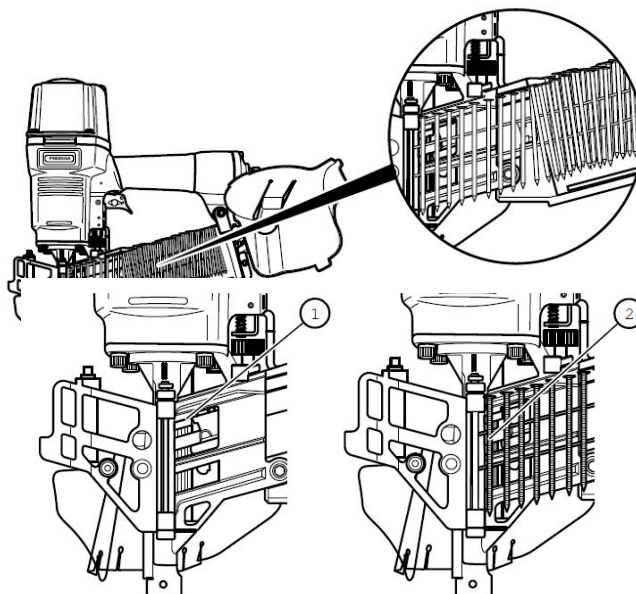

Closing the magazine

- ▶ To close the magazine, swing in the magazine cover (1).
- ▶ Swing in the magazine lock (2).
- ▶ Press down firmly on the magazine catch (3) until the magazine fastener engages. The magazine is closed.

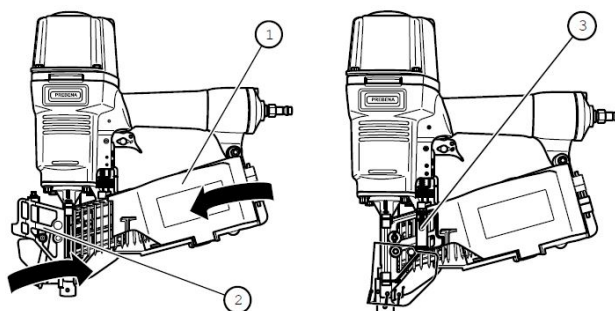

Adjusting the exhaust outlet

The Slider is equipped with an adjustable exhaust outlet (2).

- ▶ To adjust the exhaust outlet, turn the adjusting wheel (2) in the required direction.
- ▶ Turn the vent so that you or other persons are not in direct line of the exhaust air.

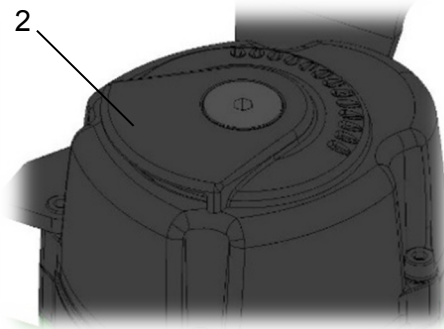

Checking the function

To ensure that the Slider is functioning correctly, proceed as follows when starting it for the first time:

ATTENTION

- ▶ Note the danger warnings in the section on "Safety" from page 19 onwards.



CAUTION

When operating the Slider, there is a risk of injury or damage to property.

- ▶ Note the safety instructions in the section on "Safety" from page 19 onwards.
-

- ▶ Place the Slider on a piece of wood at least 120 mm thick.
- ▶ Release the Slider (see section on "Driving in the fasteners" from page 19 onwards).
- ▶ Check the following properties:
 - Triggering only takes place when the trigger lock is pressed in.
 - Every time the tool is triggered, a fastener must be driven into the piece of wood.
 - The exhaust air must not be blown out into the face.
- ▶ To maintain the required driving depth, if necessary change the operating pressure or the number of spacer plates (see page 17 onwards).
- ▶ Repeat these steps if necessary.

The Slider is now ready to use.



Always try to work with the lowest possible operating pressure. This offers the following advantages:

- You save energy.
- You reduce the noise level.
- You reduce the wear on the Slider.

Operating the Slider

Proceed as follows to operate the Slider:

- Prepare the Slider as described from page 11 onwards.

Using the parallel guide or guide sight slot

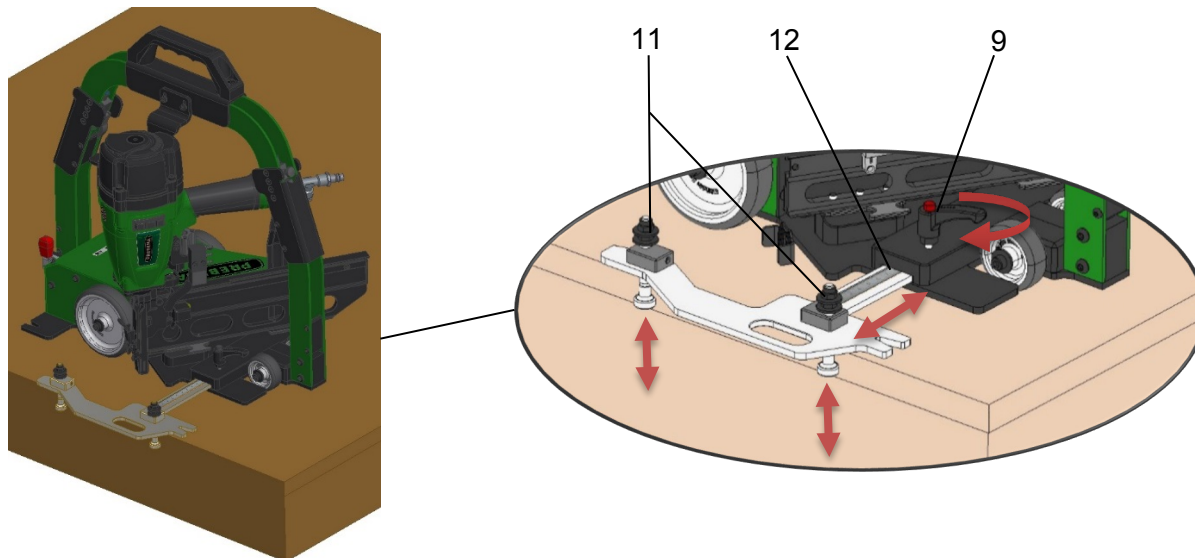

Proceed as follows for operation with the built-in parallel guide (12) on the edge of a panel or using the guide sight slot (19) on a specified line:

- Open the clamping lever (9) by turning it two turns clockwise until the parallel guide (12) can be easily removed.
- Set the required distance using the scale on the rule.
- Close the clamping lever (9) by turning it anticlockwise.

The parallel guide (12) is now fixed in place.

- Push the two guide pins (11) down.
- Applying slight pressure, guide the Slider to the side against the edge of the panel in order to achieve optimum work results.
- You can return the parallel guide to its original position by carrying out these steps in reverse order.

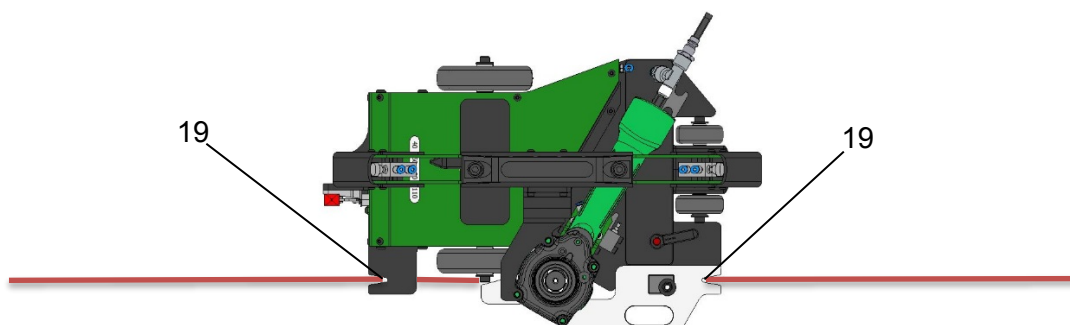

- For operation using the guide sight slot (19), locate the line you created using the two V-notch sights (19) and follow the line.
- Make sure that the parallel guide (12) is in the original position.

Selecting the nail distance

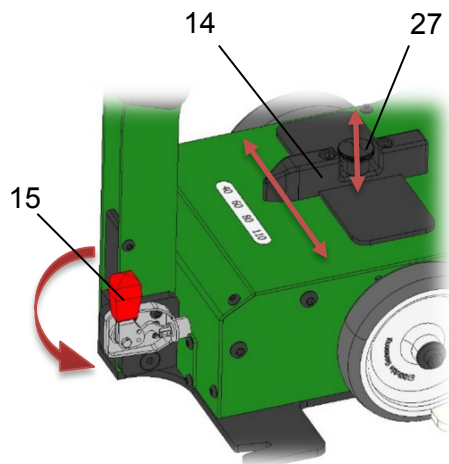

You can adjust the distance between the individual fasteners for operation using continuous triggering. You can choose between distances of 40, 60, 80 or 110 mm. Proceed as follows to select the required distance:



WARNING

Accidental triggering when selecting the nail distance can lead to serious or even fatal injuries.

- ▶ Disconnect the Slider from the compressed air supply before selecting the distance.
- ▶ Ensure that no body parts are near the opening.
- ▶ Never direct the Slider at people, animals or their body parts.

- ▶ Open the coupling (15) by moving the lever down.
- ▶ Pull up the detent pin (27) and hold it there.

The distance adjustment mechanism is now unlocked.

The distances are marked on the housing.

- ▶ Slide the distance adjustment mechanism (14) until you have selected the required distance. The tip of the distance adjustment mechanism (14) shows the distance selected.
- ▶ Release the detent pin (27) again.
- ▶ Make sure that the detent pin (27) is fully locked into place.
- ▶ Now close the coupling (15) by moving the lever up.

The nail distance is now selected.

Adjusting the driving depth

You can adjust the driving depth of the fasteners in the material by regulating the operating pressure or by inserting or removing spacer plates.

Regulating the driving depth via the operating pressure

You can adjust the driving depth of the fasteners in the material by regulating the operating pressure. At a higher operating pressure the fasteners are driven in deeper and at a lower operating pressure they are not driven in as deep.

- i** Adjust the operating pressure so that the required driving depth is reached exactly. This offers the following advantages:
- You save energy (compressed air),
 - You reduce the noise level, and
 - You reduce the wear on the tacker.

Proceed as follows to adjust the operating pressure:

- Adjust the pressure at the pressure valve of the compressor or of the pressure system.
- Note the pressure gauge on the compressor or the pressure system.

Regulating the driving depth with spacer plates

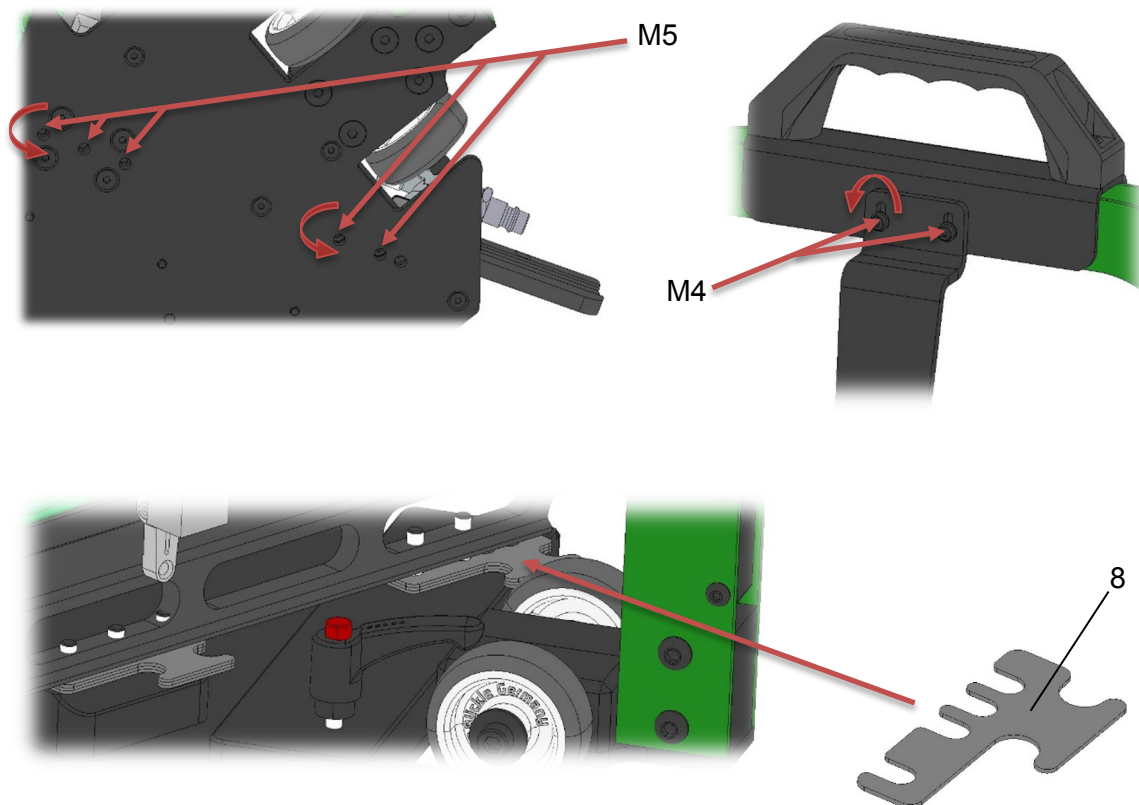

You can adjust the driving depth of the fasteners in the material by inserting or removing spacer plates in different positions. Six spacer plates, each 1 mm thick, are included in the delivery. When fitted, each spacer plate increases the opening distance to the material by 1 mm.

Proceed as follows to set depth control:

- Undo the M4 bolts (using a 3 mm Allen key) on the handle of the Slider until they are loose but do not fall out.
- Undo the M5 bolts (using a 4 mm Allen key) on the underside of the Slider until you can lift up the tacker and insert or remove the spacer plates (8) as shown in the diagram.
- Note the direction in which the spacer plates are fitted (8).
- Make sure that the spacer plates (8) are evenly distributed.
- After inserting/removing the plates, retighten all the bolts.

ATTENTION!

- Only use the tool included in the delivery and the spacer plates supplied.

Checking the driving depth

- ▶ Place the Slider down on a sample piece of wood of adequate size with the same properties as the material to be worked on.
- ▶ Check the setting by triggering a single shot on the sample material.
- ▶ Repeat these steps until the required driving depth is set.

Driving in fasteners



WARNING

Risk of injury due to electric shock.

- ▶ Before triggering the Slider, ensure that no power cables can be struck.



WARNING

During operation, injuries to the eyes and other body parts are possible due to flying splinters.

- ▶ Wear suitable safety goggles and suitable protective clothing during operation.
- ▶ Observe the valid health and safety regulations.



WARNING

Loud operating noises can cause damage to hearing.

- ▶ Wear suitable ear protection.
- ▶ Observe the valid noise protection regulations.
- ▶ Select the lowest possible operating pressure.



WARNING

Risk of injury when fasteners slide off or are driven in too far, or due to kickback.

- ▶ Never trigger the Slider in the open. This avoids the risk of any flying fasteners and of overloading the Slider.
- ▶ Take note of the workplace dimensions. The Slider may penetrate thin workpieces or slip off workpieces when working on corners and edges.
- ▶ Ensure that the driving depth is not set deeper than the thickness of the piece of wood.

When fasteners are driven into workpieces that are too hard, or into other fasteners, a powerful kickback is generated. This can cause the Slider to slip off or jump.

The driving depth of the fasteners depends on the hardness and thickness of the piece of wood, the set operating pressure and the spacer plates fitted.

- ▶ Make sure there are no persons behind the piece of wood.
- ▶ Then check the function of the tacker at a low operating pressure by triggering it once.
- ▶ Regulate the operating pressure according to the strength of the wood used.

The correct operating pressure is set when the required driving depth of the fasteners is achieved at the lowest possible pressure.

You can trigger the Slider individually, at any time or continuously at the selected nail distances.

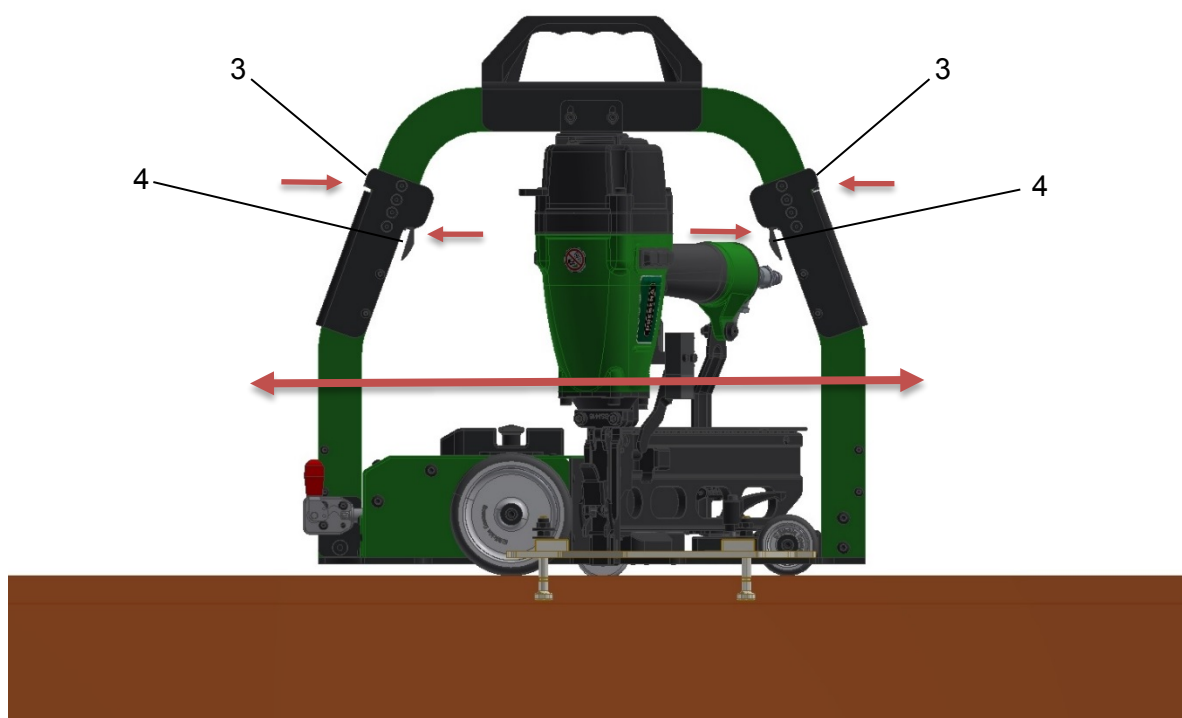

Triggering a single shot

Proceed as follows to trigger the Slider for a single shot:

- ▶ Place the Slider on the workpiece to be worked on.
- ▶ If desired (at any time), press the trigger button (3) to trigger a single shot.

A fastener is driven into the workpiece.

 This function is used to fix the workpiece to corners, for example.

Continuous triggering

Proceed as follows to trigger the Slider continuously:

- ▶ Place the Slider on the workpiece to be worked on.
- ▶ Hold onto the continuous operation trigger lever (4) and push/pull the Slider in the required direction to start path-controlled triggering. In so doing, the Slider triggers at the distance you have set.
- ▶ Ensure that the working speed is appropriate and constant.
- ▶ Avoid any jerky movements for optimum work results.
- ▶ Reduce the working speed depending on the distance selected (40 mm = slower to 110 mm = faster) to avoid damage caused by overloading the Slider.



WARNING

Risk of injury when operating the Slider at workpiece edges.

- ▶ Ensure that there is enough distance between the opening and the edge of the workpiece.
- ▶ Ensure that the Slider is in perfect condition.
- ▶ Ensure that the Slider is guided in a straight line over the workpiece.
- ▶ Never trigger the Slider in the open. This avoids the risk of any flying fasteners and of overloading the Slider.

After operation

After operation, or during long periods when the tool is not in use, perform the steps described below.

Disconnecting the compressed air supply

- Pull the quick coupler of the compressed air hose away from the handle.

The quick coupler is now released.

- Remove the compressed air hose from the connection on the Slider.

The compressed air contained in the Slider escapes audibly.

- Set down the Slider and secure it so that it cannot inadvertently roll away.

Emptying the magazine

Remove the unused fasteners from the magazine when you have finished using the tacker.

To do so, proceed as follows:



WARNING

Accidental triggering when emptying the magazine can lead to serious or even fatal injuries.

- Disconnect the Slider from the compressed air supply.



CAUTION

Risk of crushing by compressed-air-operated pusher.

- Disconnect the Slider from the compressed air supply.

- Disconnect the Slider from the compressed air supply.
- To open the magazine, press the magazine catch (1) downwards in the direction of the arrow.
- Swing out the magazine lock to the left (2).
- Switch out the magazine cover to the right (3).
- Remove all the fasteners.
- To close the magazine again, proceed in reverse order.
- Set down the Slider and secure it so that it cannot inadvertently roll away.

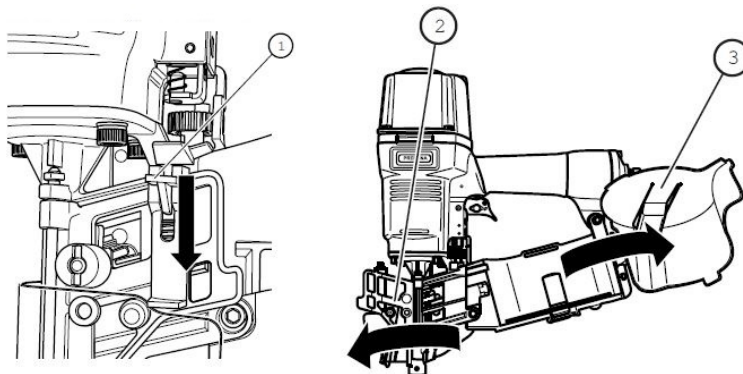

Transporting and storing the Slider

Packing

Pack the Slider in its original cardboard box prior to storage or before the following types of transport:

- Distances of more than 10 m
- Transport over unstable ground
- Transport that involves an unaccustomed posture.

Carry out the following preparatory steps:

- ▶ Disconnect the Slider from the compressed air supply (see page 21).
- ▶ Allow the pressure to be completely released from the Slider.
- ▶ Empty the magazine (see page 21).
- ▶ If necessary, clean the compressed air connections to remove any foreign matter and contamination.
- ▶ Place the Slider in the original cardboard box.

Transporting

The type of transport differs according to whether you are transporting the Slider over short or long distances.

Transport over short distances

Short distances are distances not exceeding 10 metres.



WARNING

Accidental triggering can lead to serious or even fatal injuries.

- ▶ Disconnect the Slider from the compressed air supply every time it is transported (see page 21).
- ▶ Carry the Slider only by the handle.
- ▶ Do not touch the trigger during transport.

- ▶ Disconnect the Slider from the pressure supply (see page 21).

ATTENTION

Impacts and knocks can result in damage to the tacker.

- ▶ Do not drop the tacker.
 - ▶ Protect the tacker from knocking against obstacles.
-
- ▶ Carry the Slider by the handle with the tool lug facing the ground.
 - ▶ Only connect the compressed air supply when you have reached the new place of use.

Transport over long distances

The following distances for transporting the Slider are regarded as "long distances":

- Distances covered by transportation in a vehicle.
- Distances of more than 10 m,
- Transport over unstable ground, and
- Transport that involves an unaccustomed posture.

 The Slider must only be transported over long distances in the original cardboard box.

Proceed as follows to transport the Slider over long distances:

- ▶ Proceed as described on page 21, "After operation".
- ▶ Pack the Slider in the original cardboard box supplied.
- ▶ Carry the original cardboard box to the required location.
- ▶ Only set down the original cardboard box so that it is upright with the lid facing upwards.

Storage

- ▶ Oil all metal parts of the Slider thinly with PREBENA special oil.
- ▶ Pack the Slider in the original cardboard box.
- ▶ Store the Slider at room temperature in a dry place protected from dust.

Servicing the Slider

To always keep the Slider in perfect working condition, a number of regular services are required:

- A one-off service after 25 hours of operation.
- See the service table on page 25 for more service intervals.



The Slider must only be serviced by persons with the required knowledge, skills and experience. Any work not described here must only be carried out by the manufacturer's customer service department or at the manufacturer.

- ▶ Before carrying out any servicing work, make sure there are no fasteners in the magazine.
- ▶ Disconnect the Slider from the compressed air supply.

One-off service after 25 hours of operation

- ▶ Check that all freely accessible screws and nuts are secure and, if necessary, tighten them.
- ▶ Clean the castors with a cloth dampened with a mild soap solution.
- ▶ Check the safety devices.
- ▶ Check all accessible hose connections.
- ▶ If there is no maintenance unit available, spray 10 to 15 drops of PREBENA special nailer oil, order no.: Z200.10, into the tool's air supply.

ATTENTION!

Risk of environmental pollution if the lubricating oil is spilled.

- ▶ Absorb spilled oil with a binding agent.
- ▶ Wipe up absorbed oil with a cloth.
- ▶ Dispose of the cloth in accordance with the statutory regulations in force at the site of use.

ATTENTION!

The Slider could be damaged by using unsuitable or contaminated lubricants, or by using a blend of lubricants.

- ▶ Only use PREBENA special nailer oil, order no.: Z200.10.
- ▶ Never use unsuitable or contaminated lubricating oil.
- ▶ Do not mix different types of oil together.
- ▶ Dispose of used lubricating oils in an environmentally friendly manner.

Cleaning the housing and external surfaces

ATTENTION!

Unsuitable cleaning agents can cause damage to the Slider or accessories.

- ▶ Clean only with a dry or slightly damp cloth, or a cloth dampened with a mild soap solution.

Slight contamination

- ▶ Wipe the Slider housing with a dry cloth.
- ▶ Oil all metal parts of the Slider thinly with PREBENA special oil.

Heavy contamination

- ▶ Wipe the Slider housing with a cloth dampened slightly with a mild soap solution.
- ▶ Then wipe the housing with a cloth dampened slightly with tap water.
- ▶ Rub down with a soft, dry cloth afterwards.
- ▶ Oil all metal parts of the Slider thinly with PREBENA special oil.

Oiling the Slider

ATTENTION

Insufficient lubrication or the use of the wrong lubricants can cause damage to the Slider.

- ▶ Use only PREBENA special nailer oil.



If no oiler is installed and the length of the air line to the tacker is over 10 m, sufficient lubrication is not guaranteed.

- ▶ In both cases, two to five drops of PREBENA special nailer oil must be filled directly into the connection for the compressed air source every day prior to operation.

ATTENTION

Risk of environmental pollution if the lubricating oil is spilled

- ▶ Absorb spilled oil with a binding agent.
- ▶ Wipe up absorbed oil with a cloth.
- ▶ Dispose of the cloth in accordance with the statutory regulations in force at the place of use.

Service intervals

Servicing work	Daily	Weekly
Check the safety devices	X	
Lubricate the tacker (5 to 10 drops of PREBENA special nailer oil, order no.: Z200.10, into the air supply duct)	X	
Clean the wheels	X	
Check the screwed connections		X
Check the hose connections		X
Clean the Slider		X

Faults



WARNING

Operation of damaged or malfunctioning Sliders can lead to serious or even fatal injuries.

- ▶ In case of a fault, immediately disconnect the Slider from the compressed air supply.
- ▶ Do not use the Slider until the fault has been corrected.

ATTENTION!

The Slider may incur damage if repaired by unauthorised persons.

- ▶ Ensure that repairs to the Slider are only carried out by the manufacturer.

Faults

If faults occur on the Slider that you are unable to rectify through lubrication and cleaning, you must notify PREBENA Service.

- ▶ Do not perform any repair work on the Slider.
- ▶ Ensure that all faults on the Slider are rectified by PREBENA Service.

Overview of faults

The following overview lists possible faults and the necessary measures.

	Fault	Possible cause	Corrective measure
A	Slider fails to trigger.	Insufficient pressure supply.	▶ Check the set pressure and the hose connection between the compressed air supply and the Slider.
		Coupling not actuated.	▶ Pull the coupling lever upwards (see page 17).
B	Distance adjustment mechanism cannot be moved.	Coupling not actuated.	▶ Pull the coupling lever down (see page 17).
C	Slider triggers at irregular intervals.	Working speed too high or jerky movements.	▶ Ensure that the working speed is appropriate and constant.
D	Fasteners are not driven in completely.	Depth control not optimally set.	▶ Carry out the steps for setting depth control (see page 17).
		Insufficient compressed air supply.	▶ Use a more powerful compressor.
			▶ Shorten the compressed air supply line.
			▶ Use a compressed air supply line with a larger cross section.
		The driver tip on the tacker is worn.	▶ Notify aftersales service (see page 28).
E	Triggering without a fastener being driven in (empty shot).	The cylinder of the pusher is faulty.	▶ Notify aftersales service (see page 28).
		The magazine is contaminated.	▶ Clean the magazine.
	Triggering without a fastener being driven in (empty shot).	The wrong fasteners were loaded in the magazine.	▶ Empty the magazine. ▶ Fill the magazine with PREBENA fasteners (from page 27 onwards).
		The tacker is insufficiently lubricated.	▶ Pour PREBENA special nailer oil into the compressed air connection used. ▶ Actuate the trigger several times.

	Fault	Possible cause	Corrective measure
E		The operating pressure is too low.	► Increase the operating pressure (see page 12).
		The triggering sequence is not performed completely.	► Notify aftersales service (see page 28).

Ordering accessories

You can reorder accessories from the manufacturer (see page 28). Only use original PREBENA accessories and fasteners or accessories approved by PREBENA for operation of the Slider.

Ordering fasteners

The Slider must only be used with the appropriate PREBENA staples shown on the rating plate.

Type	Wire dimensions	Length
CNW 25/45 – CNW 25/70	d = 2.5 mm	45 mm – 70 mm
CNW 28/65 – CNW 28/90	d = 2.8 mm	65 mm – 90 mm
CNW 31/65 – CNW 31/90	d = 3.1 mm	65 mm – 90 mm

Please specify further details in the order (e.g. –BK; –BKRI or –RFRILI)

Ordering other accessories

Item no.	Accessories
Z 200.10	PREBENA special nailer oil
Z160.12	Spiral hose with 9 mm inner diameter, 12 mm outer diameter, working length 4 m, extended length 7.5 m
Z200.20	Compressed air hose set with 9 mm inner diameter, 15 mm outer diameter, extended length 10.0 m
Z180.00	Compressed air hose drum with inner diameter 8 cm, outer diameter 12 cm, for a hose length of 30 m
	Extension arm for working in an upright position

You can find more accessories at www.prebena.de

Disposing of the Slider

ATTENTION

Incorrect disposal results in environmental damage.

- Clean the Slider before disposing of it.
- Observe the valid regulations for the disposal of oil.



Never dispose of the Slider or parts of it with normal household rubbish. If you wish to dispose of the Slider, send it to PREBENA. PREBENA can guarantee the correct disposal of the Slider. Contact details can be found on page 28.

Manufacturer's address

PREBENA

Wilfried Bornemann GmbH & Co. KG

Befestigungstechnik

Seestraße 20–26

D-63679 Schotten, Germany

Telephone: +49 (0) 60 44 / 96 01-100

Fax: +49 (0) 60 44 / 96 01-820

Email: info@prebena.de

Homepage: www.prebena.de

Warranty

PREBENA furnishes a one-year warranty for the tool specified here starting from the date of sale in accordance with the following warranty conditions. PREBENA guarantees the rectification of defects resulting from material or manufacturing defects free of charge. Malfunctions or damage caused by improper use or handling are not covered by the free warranty.

Furthermore, only original PREBENA spare parts may be used; failure to comply with this requirement shall render the product liability and, therefore, the warranty claim null and void. The warranty shall not cover wear parts, e.g. O rings, etc. It shall be at the discretion of PREBENA to implement the warranty by replacing the defective part or arranging a replacement delivery. No further claims shall be accepted.

In order for the warranty to take effect, the certificate of warranty – completed in full – must be accompanied by the dealer's stamp and date of sale, or by an invoice document from which the dates and details to be listed in accordance with the certificate of warranty can be taken.

Shipping: The faulty device must be carefully packed so that it is resistant to breakage, the postage must be paid and the package sent to PREBENA.



Certificate of warranty

Model name:

Date of purchase:

Dealer:

(Stamp)



To receive the original copy of these operating instructions, create a copy of this page.

Index

A

Accessories 28

Adjusting

- Driving depth 18
- Exhaust outlet 15
- Parallel guide 17
- Staple distance 18

Adjusting the exhaust outlet 15

After operation

- Disconnecting the compressed air supply 22
- Emptying the magazine 22

Aftersales service 29

Avoiding risk 5

C

Care

- Oiling 26

CE mark 10

Checking

- Condition 11
- Driving depth 20
- Function 15

Checking the function 15

Cleaning

- Heavy contamination 25
- Housing, external surfaces 25
- Slight contamination 25

Connecting the compressed air supply 12

Contamination

- Heavy 25
- Slight 25

Correct use 5

- Improper use 5

Coupling 18

D

Damage

- Avoiding 6

Description 7

- Function 8
- Product features 9
- Scope of delivery 8
- Tool overview 7, 8

Disconnecting the compressed air supply 22

Disposal 28

Driving depth

- Adjusting 18
- Checking 20

F

Fasteners

- Driving in 20
- Ordering 28

Faults 27

First service 25

G

Guide sight slot 17

H

How it works 8

I

Information signs 10

L

Layout characteristics 4

Long distances 24

M

Magazine

- Emptying 22
- Filling 13

Manufacturer's address 29

O

Operation

- After operation 22
- Preparing 11
- Repairing faults 27

Ordering

- Accessories 28
- Fasteners 28

P

Parallel guide 17

Preparing

- Checking the condition 11

R

Rating plate 10

Repairing faults 27

Repairs 27

S

Safety

Basic instructions 5

Information signs 10

Safety devices 9

Selecting the staple distance 18

Service intervals 26

Servicing 25

First service 25

Short distances 23

SLIDER

Connecting the compressed air supply 12

Disposal 28

Oiling 26

Operating 17

Preparing 11

Servicing 25

Storage 23

T

Tool overview

SLIDER 8

SLIDER 7

Transport

Long distances 24

Short distances 23

Transporting

Packing 23

Transporting 23

Triggering

Continuous 21

Single shot 21

Troubleshooting 27

U

Unpacking 11

W

Warranty 30

